

EAO – Your Expert Partner for Human Machine Interfaces

82-4561.1000 - Pushbutton 16 mm Aluminium

82-4561.1000 - Pushbutton 16 mm Aluminium



Attention: The preview is based on a sample product. This can differ from your current configuration.

Mounting

Mounting cut-out Ø 16 mm
Design flush

Front

Front shape round
Front ring shape flush
Front dimension Ø 18 mm
Front bezel material Aluminium

Other Attributes

Weight 0,020 kg

Operating-/Indication part

Lens optics opaque
Lens material Aluminium
Lens colour natural anodized
Lens profile flat (raised)
Lens illumination non-illuminative

IP-Rating

Front protection IP65, IP67

Connection Method

Terminal Solder 2.8 x 0.5 mm

Actuator

Switching action Momentary

Switching element

Switching current 3 A
Contact material Silver
Contacts 1 C
Switching system Snap-action switching element
Switching voltage 240 V AC/DC

Function

Pushbutton

EAO – Your Expert Partner for Human Machine Interfaces

82-4561.1000 - Pushbutton 16 mm Aluminium

Dimensions

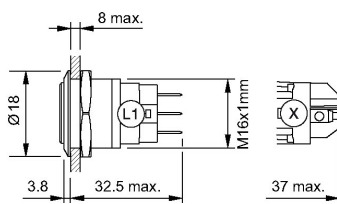

Mounting cut-outs

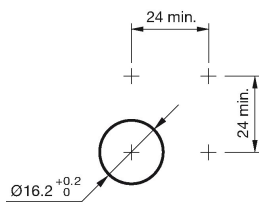

Wiring diagram

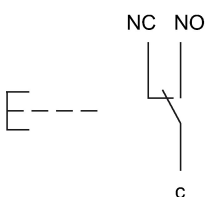

Component layout

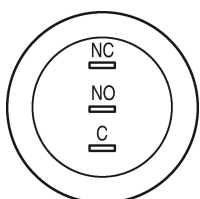

Legend

Switching action: B = Momentary
Contacts: C = Changeover