

For mating dimensions see MIL-DTL-38999 Series III

Reference MIL-STD-1560 for insert arrangement details. For non-MS arrangements consult Amphenol.

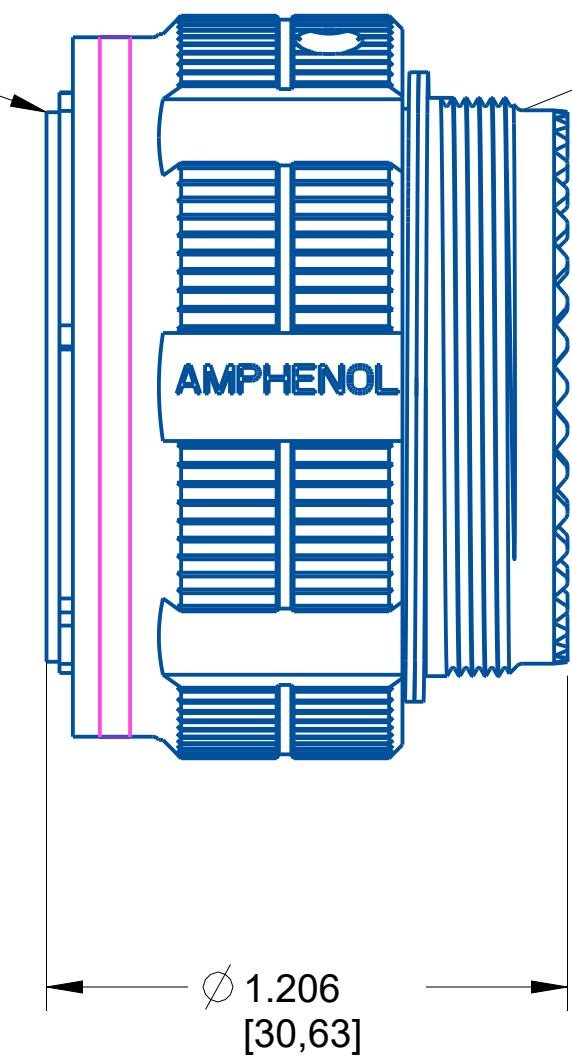

For rear shell features and accessories see MIL-DTL-38999 Series III

NOTE:
 -DRAWING NOT TO SCALE
 -DIMENSIONS SUBJECT TO CHANGE
 -DIMENSIONS ARE IN INCHES [MM]
 PROPERTY OF AMPHENOL AEROSPACE. ALL RIGHTS RESERVED.

Meets applicable requirements of MIL-DTL-38999
 Base Material: Aluminum
 Plating: AP-93

| | | | |
|--|---------------------------|---------------------------------------|------------------|
| AMPHENOL CORPORATION <small>40-60 DELAWARE AVENUE SIDNEY, N.Y. 13838</small> | | | |
| PLUG Electrical Connector TVS06 | | | U |
| SIZE C | CAGE CODE 77820 | CODED NUMBER TVS06DS-23-35S | REV X1 |
| SHEET 1 OF 1 | | | |

Insert Arrangement

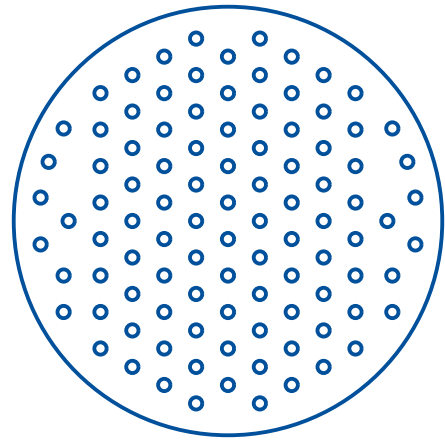

| | |
|-----------------|----------------|
| No. of Contacts | 100 |
| Contact Size | 22D |
| Wire Size | 28, 26, 24, 22 |

| | |
|----------------|--------|
| Shell Size | 23 |
| Arrangement | 35 |
| Service Rating | M |
| Test Current | 5 AMPS |

NOTE:
 -DRAWING NOT TO SCALE
 -DIMENSIONS SUBJECT TO CHANGE
 -DIMENSIONS ARE IN INCHES [MM]

PROPERTY OF AMPHENOL AEROSPACE. ALL RIGHTS RESERVED.

| | | | |
|--|--|--|---------------------------------|
| AMPHENOL CORPORATION <small>40-60 DELAWARE AVENUE SIDNEY, N.Y. 13838</small> | | | |
| PLUG Electrical Connector TVS06 | | | U |
| <small>SIZE</small> C | <small>CAGE CODE</small> 77820 | <small>CODED NUMBER</small> TVS06DS-23-35S | <small>REV</small> X1 |
| SHEET 1 OF 1 | | | |