

# EAO – Your Expert Partner for Human Machine Interfaces

## 82-6162.1000 - Pushbutton 22 mm stainless-steel

### 82-6162.1000 - Pushbutton 22 mm stainless-steel



*Attention: The preview is based on a sample product. This can differ from your current configuration.*

#### Mounting

Design	flush
Mounting cut-out	Ø 22,3 mm

#### Front

Front shape	round
Front ring shape	flush
Front dimension	Ø 25 mm
Front bezel material	Stainless steel

#### Other Attributes

Weight	0,020 kg
--------	----------

#### Operating-/Indication part

Lens optics	opaque
Lens material	Stainless steel
Lens colour	Stainless steel
Lens profile	flat
Lens illumination	non-illuminative

#### IP-Rating

Front protection	IP65, IP67
------------------	------------

#### Connection Method

Terminal	Screw terminal
----------	----------------

#### Actuator

Switching action	Momentary
------------------	-----------

#### Switching element

Switching current	3 A
Contact material	Silver
Contacts	1 C
Switching system	Snap-action switching element
Switching voltage	240 V AC/DC

#### Function

Pushbutton
------------

# EAO – Your Expert Partner for Human Machine Interfaces

82-6162.1000 - Pushbutton 22 mm stainless-steel

## Dimensions

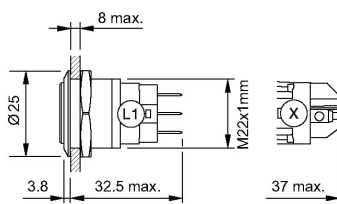

## Mounting cut-outs



## Wiring diagram

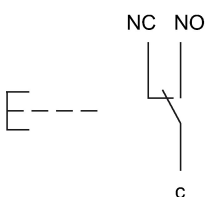

## Component layout

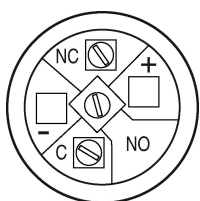

## Legend

Switching action: B = Momentary  
Contacts: C = Changeover