

M12

1210 ... 3...

Actuator/Sensor Cordsets M12



Actuator/sensor cordset with overmolded connector

Cable end 1:

M12 male, straight, A-coded, IP67

Cable end 2:

blunt cut

Cable:

PUR, black

Approvals:



M12

1210 ... 3...

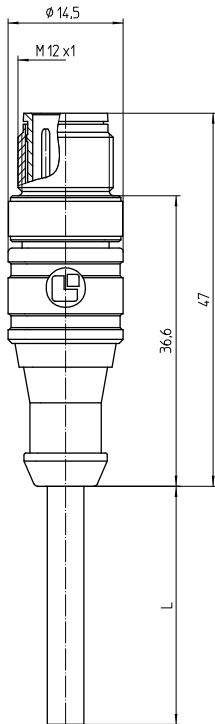

Environmental conditions

Temperature range -25 °C/+80 °C

Materials

Insulating body TPU GF, HB according to UL94
 Contact pin CuZn, pre-nickel and gold-plated
 Overmolding/handle TPU¹
 Knurled screw CuZn, nickel-plated

¹ material halogen-free

Mechanical data

Mating cycles ≥ 100
 Insertion force ≤ 10 N (4-5 poles)
 ≤ 23 N (8 poles)¹
 Withdrawal force ≤ 15 N (4-5 poles)
 ≤ 30 N (8 poles)¹

Protection class IP67²

¹ measured with a proper counterpart

² according to IEC DIN EN 60529, only in locked condition with an appropriate counterpart

Pin assignments for male M12 connectors, A-coded, front view

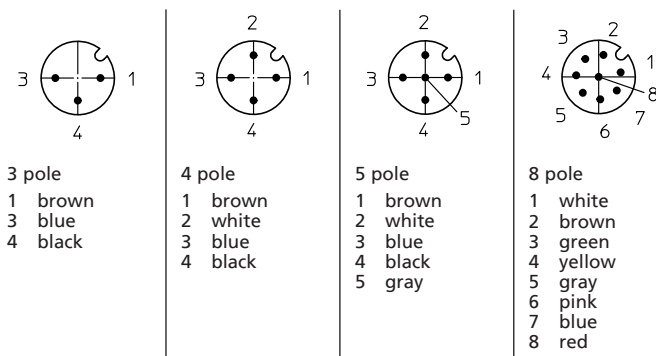

Connected cable

Construction PUR, black

Electrical data (at T_{amb} 20 °C)

Contact resistance ≤ 10 mΩ
 Rated current 4 A (3-5 poles)
 2 A (8 poles)
 1.5 A (12 poles)
 (T_{amb} 40 °C)
 Rated voltage 250 V AC/DC (3-4 poles)
 60 V AC/DC (5 poles)
 30 V AC/DC (8-12 poles)
 Rated impulse voltage 2500 V (3-4 poles)
 1500 V (5 poles)
 800 V (8-12 poles)
 Material group I (IEC)/0 (UL) (CTI = 600)
 Insulation resistance > 100 MΩ

Associated products

Counterparts
 ☞ 1200 ... 0... ☞ 1200 ... 3... ☞ 1205 ... 0...
 ☞ 1205 ... 3... ☞ 1206 ... L1 0... ☞ 1206 ... L1 3...
 ☞ 1206 ... L2 0... ☞ 1206 ... L2 3... ☞ 1210 1200 ... 0...
 ☞ 1210 1200 ... 3... ☞ 1210 1205 ... 3... ☞ 1210 1206 ... L1 0...

M12

1210 ... 3...

-
- | | | |
|---|---|---|
| 🔗 1210 1206 ... L1 3... | 🔗 1210 1206 ... L2 0... | 🔗 1210 1206 ... L2 3... |
| 🔗 1220 ... T16CW ... | 🔗 1220 ... T20CW100 ... | 🔗 1220 ... T20CW101 ... |
| 🔗 1220 ... T20CW102 ... | 🔗 1220 ... T20CW103 ... | 🔗 1220 ... T20CW104 ... |
| 🔗 1220 ... T20CW105 ... | 🔗 1221 ... T16CW100 ... | 🔗 1221 ... T9CP |
| 🔗 1240 ... T...CR | 🔗 1245 ... T9CR | 🔗 5500 04DL1 3... |
| 🔗 5500 04L1 3... | 🔗 5500 08DL1 3... | 🔗 5500 08L1 3... |
| 🔗 5512 04DL1 | 🔗 5512 04L1 | 🔗 5512 08L1 |

Accessories

- | | | |
|-----------------------------|-----------------------------|-----------------------------|
| 🔗 9912 CPM0 | 🔗 9912 MRBU | 🔗 9912 MRGN |
| 🔗 9912 MRRD | 🔗 9912 MRWH | 🔗 9912 MRYE |
-

M12

1210 ... 3...

Designation	Pole Number	Connected Cable	PU (Pieces)	MDQ (Pieces)	Dimensions L (mm)
1210 04 301 2m	4	PUR, black, 4 x 0.34 mm ² (AWG 22), 910301, UL-style 20549	5	10	2000
1210 04 301 5m	4	PUR, black, 4 x 0.34 mm ² (AWG 22), 910301, UL-style 20549	1	10	5000
1210 05 302 0,6m	5	PUR, black, 5 x 0.34 mm ² (AWG 22), 910302, UL-style 20549	5	10	600
1210 05 302 2m	5	PUR, black, 5 x 0.34 mm ² (AWG 22), 910302, UL-style 20549	5	10	2000
1210 05 302 5m	5	PUR, black, 5 x 0.34 mm ² (AWG 22), 910302, UL-style 20549	1	10	5000
1210 08 303 2m	8	PUR, black, 8 x 0.25 mm ² (AWG 24), 910303, UL-style 20549	5	10	2000
1210 08 303 3m	8	PUR, black, 8 x 0.25 mm ² (AWG 24), 910303, UL-style 20549	1	10	3000
1210 08 303 5m	8	PUR, black, 8 x 0.25 mm ² (AWG 24), 910303, UL-style 20549	1	10	5000

Packaging:
in a plastic bag