

# LM-4A-39

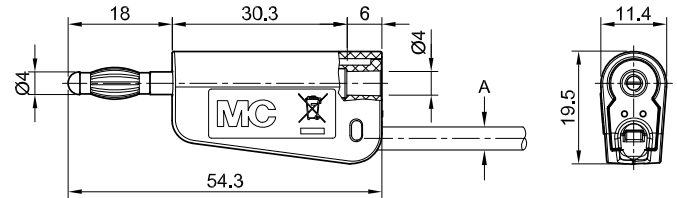

Item number 64.1045-\*

Stackable, Ø 4 mm, with spring-loaded MULTILAM for self-assembly of test leads. Screw connection.

Technical data	
Diameter of plug system	4 mm
Rated Values	30 V, 32 A / 60 V, 32 A
Surface treatment electrical contact	Au
Base material electrical contact	CuZn
Standard color(s) *	<span style="background-color: #90EE90; border: 1px solid black; padding: 2px;">20</span> <span style="background-color: #000000; color: white; border: 1px solid black; padding: 2px;">21</span> <span style="background-color: #FF0000; color: white; border: 1px solid black; padding: 2px;">22</span> <span style="background-color: #0000FF; color: white; border: 1px solid black; padding: 2px;">23</span> <span style="background-color: #FFFF00; border: 1px solid black; padding: 2px;">24</span> <span style="background-color: #008000; color: white; border: 1px solid black; padding: 2px;">25</span> <span style="background-color: #800080; color: white; border: 1px solid black; padding: 2px;">26</span> <span style="background-color: #FFA500; border: 1px solid black; padding: 2px;">27</span> <span style="background-color: #A9A9A9; border: 1px solid black; padding: 2px;">28</span> <span style="border: 1px solid black; padding: 2px;">29</span>
Outer diameter	3.9 mm
Test accessory acc. to	IEC EN 61010-031
Component parts	KT-L-4-39