

RF Product Information

- RFDPA653735OMTB801 Series for WIFI 6E Application at 699 ~ 2155 MHz

Application

- 699 ~ 2155 MHz in Smart Home, Smart Transportation and AR/VR System
- Device for external WIFI 6E system

Recommended Link Parts



ELECTRICAL CHARACTERISTICS

Item	Specification
Frequency Range	699 ~ 746 / 1710 ~ 2155MHz
Impedance	50 Ohm Nominal
VSWR	3.5 Max.(@699 ~ 746MHz) 3.0 Max.(@1710 ~ 2155MHz)
Radiation	Omni-directional
Polarization	Linear Vertical
Admotted Power	1W

MATERIAL TABLE

Item	Description
Antenna Cover	ABS+PC(Black)
Rubber Plug	Silicone(Black)
Double Tape	3M VHB4936
Heat Shrink Tube	Black
Washer	ABS+PC(Black)
Nut	ABS+PC(Black)
PCB	FR4
Connector	Fakra Type:D(Claret Violet)
Cable	RG178 PE Cable(Black)

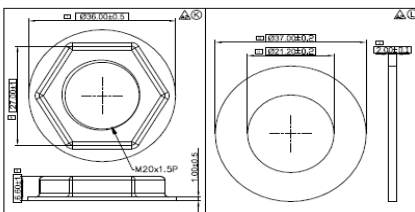

ELECTRICAL
Frequency : 699-746 /
1710-2155 MHz
IP Code : IP65

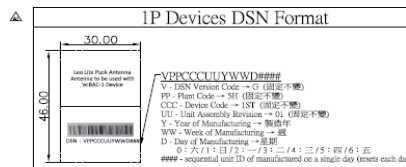
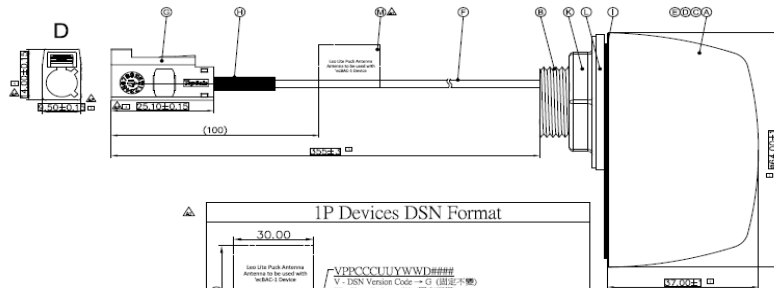
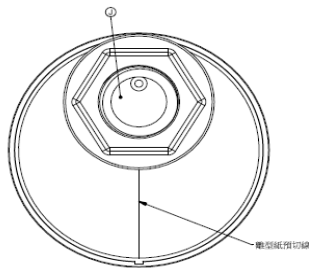
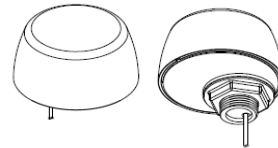

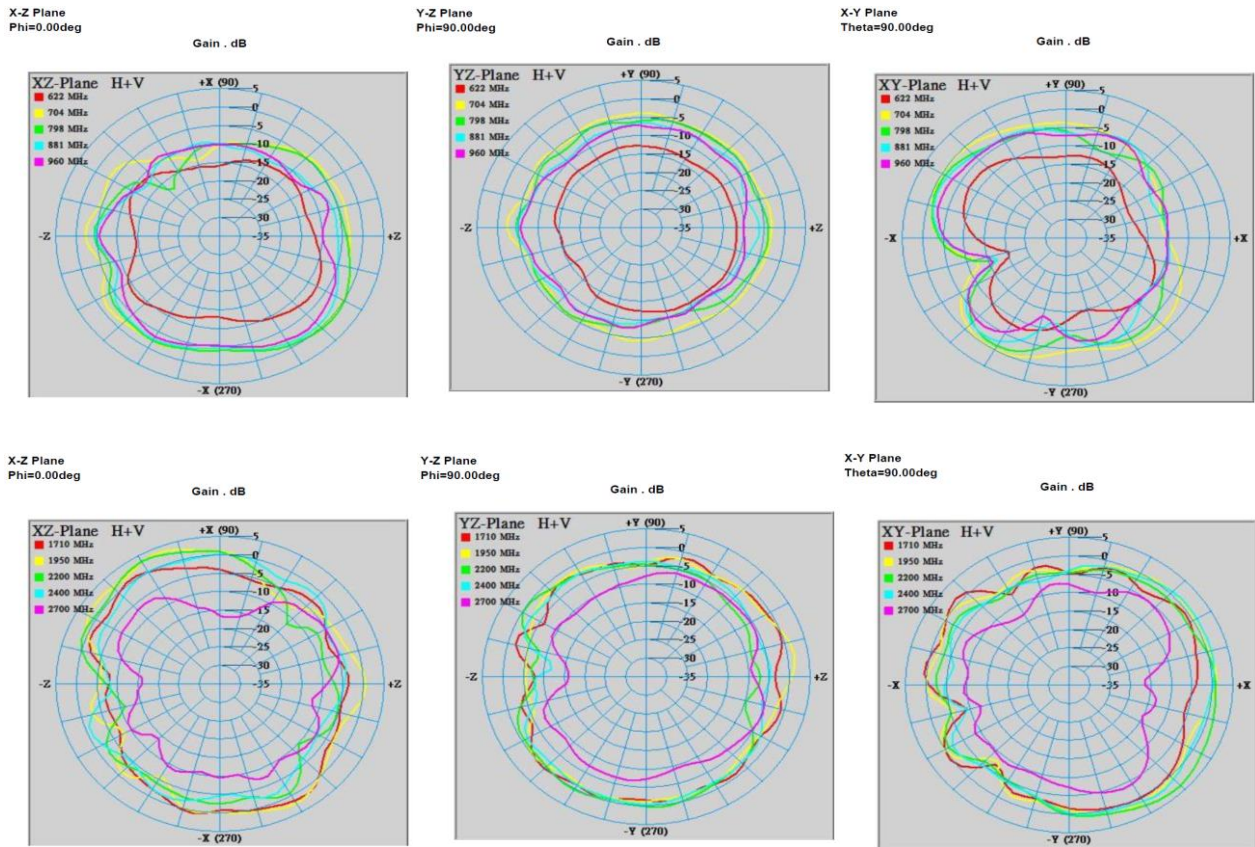

INFORMATION

For more information, please contact with
[Walsin Technology Corporation](http://www.walsin.com)
 Tel : 886-3-475-8711
 Fax : 886-3-475-5197
 E mail : info@passivecomponent.com
 Web Site : http://www.passivecomponent.com