



Sliver for SFF-TA-1002

TE Internal #: 2821750-2

Sliver Cable Assembly, 50 Position, 1 m, 25 Gb/s, Discrete Pair, 33 AWG, Sliver Plug, Sliver Plug, High Speed, 32 Signal Positions, CL2

[View on TE.com >](#)

Cable Assemblies > Copper Cable Assemblies > Internal I/O Cable Assemblies



Cable Assembly Type: **Sliver**

Connector Type (End A): **Sliver Plug**

Connector Type (End B): **Sliver Plug**

Cable Style: **Discrete Pair**

Cable Assembly Category: **High Speed**

**Features**

**Product Type Features**

|                         |               |
|-------------------------|---------------|
| Cable Assembly Type     | Sliver        |
| Connector Type (End A)  | Sliver Plug   |
| Connector Type (End B)  | Sliver Plug   |
| Cable Style             | Discrete Pair |
| Cable Assembly Category | High Speed    |

**Configuration Features**

|                            |    |
|----------------------------|----|
| Number of Positions        | 50 |
| Number of Signal Positions | 32 |

**Signal Characteristics**

|           |         |
|-----------|---------|
| Data Rate | 25 Gb/s |
|-----------|---------|

**Body Features**

|                           |     |
|---------------------------|-----|
| Cable Flammability Rating | CL2 |
|---------------------------|-----|

**Dimensions**

|           |        |
|-----------|--------|
| Wire Size | 33 AWG |
|-----------|--------|

**Operation/Application**

|              |    |
|--------------|----|
| Halogen Free | No |
|--------------|----|

**Other**

|  |  |
|--|--|
|  |  |
|--|--|



|                              |              |
|------------------------------|--------------|
| Cable Assembly Configuration | Double Ended |
| Cable Assembly Length        | 1 m          |

### Product Compliance

[For compliance documentation, visit the product page on TE.com>](#)

|   |  |
|---|--|
| EU RoHS Directive 2011/65/EU                  | Compliant  |
| EU ELV Directive 2000/53/EC                   | Compliant  |
| China RoHS 2 Directive MIIT Order No 32, 2016 | No Restricted Materials Above Threshold  |
| EU REACH Regulation (EC) No. 1907/2006        | Current ECHA Candidate List: JUNE 2023 (235)<br>Candidate List Declared Against: JUL 2021 (219)<br>Does not contain REACH SVHC |
| Halogen Content                               | Not Low Halogen - contains Br or Cl > 900 ppm.   |
| Solder Process Capability                     | Not reviewed for solder process capability   |

#### Product Compliance Disclaimer

This information is provided based on reasonable inquiry of our suppliers and represents our current actual knowledge based on the information they provided. This information is subject to change. The part numbers that TE has identified as EU RoHS compliant have a maximum concentration of 0.1% by weight in homogenous materials for lead, hexavalent chromium, mercury, PBB, PBDE, DBP, BBP, DEHP, DIBP, and 0.01% for cadmium, or qualify for an exemption to these limits as defined in the Annexes of Directive 2011/65/EU (RoHS2). Finished electrical and electronic equipment products will be CE marked as required by Directive 2011/65/EU. Components may not be CE marked. Additionally, the part numbers that TE has identified as EU ELV compliant have a maximum concentration of 0.1% by weight in homogenous materials for lead, hexavalent chromium, and mercury, and 0.01% for cadmium, or qualify for an exemption to these limits as defined in the Annexes of Directive 2000/53/EC (ELV). Regarding the REACH Regulation, the information TE provides on SVHC in articles for this part number is based on the latest European Chemicals Agency (ECHA) 'Guidance on requirements for substances in articles' posted at this URL: <https://echa.europa.eu/guidance-documents/guidance-on-reach>

### Compatible Parts



Also in the Series | [Sliver for SFF-TA-1002](#)

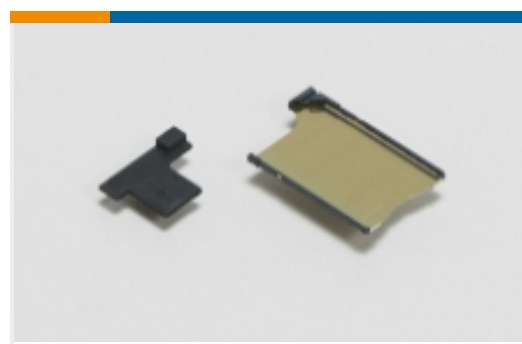

Card Guide Hardware(1)

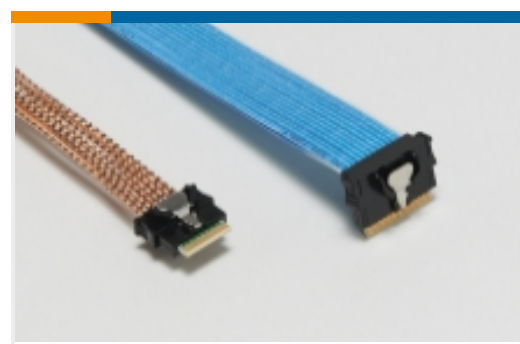

Internal I/O Cable Assemblies(109)



Internal I/O Connectors(135)

## Customers Also Bought

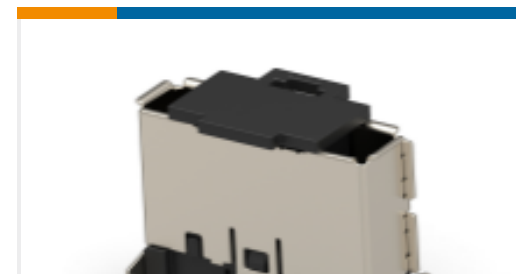
TE Part #1-917338-2  
DYNAMIC 3200 VERTI. HDR ASY 4PTE Part #2292055-1  
RECEPTACLE ASSY RA 50 POSN MBCTE Part #6368150-3  
MJ,TE,8P,CAT5,SHIELDEDTE Part #2292096-1  
RCPT ASSY SMT VERT 50 POSN MBCTE Part #2821750-1  
SLIVER C/A, 50P, STR TO STR 25GHZ  
100OHMTE Part #2317823-1  
CABLE PLUG KIT, SLIVER 74PTE Part #2821385-1  
SLIVER C/A, 74P, R/A TO R/A, 10GHZ,  
85OHMTE Part #2291316-1  
RCPT CONN VERTICAL 74 POSN  
SLIVERTE Part #2325864-2  
SFP-DD RECEPTACLE W HOLD  
DOWNS ASSEMBLY

## Documents

### CAD Files

[3D PDF](#)

[3D](#)

### Customer View Model

[ENG\\_CVM\\_CVM\\_2821750-2\\_A.2d\\_dxf.zip](#)

English

### Customer View Model

[ENG\\_CVM\\_CVM\\_2821750-2\\_A.3d\\_igs.zip](#)

2821750-2

Sliver Cable Assembly, 50 Position, 1 m, 25 Gb/s, Discrete Pair, 33 AWG, Sliver Plug,  
Sliver Plug, High Speed, 32 Signal Positions, CL2



English

**Customer View Model**

[ENG\\_CVM\\_CVM\\_2821750-2\\_A.3d\\_stp.zip](#)

English

By downloading the CAD file I accept and agree to the [Terms and Conditions](#) of use.

**Datasheets & Catalog Pages**

[Sliver Cable Assembly Technical Datasheet](#)

English

[Sliver Internal Cabled Interconnect Solutions Brochure \(Chinese\)](#)