

DRAWING MADE IN THIRD ANGLE PROJECTION:
 THIS DRAWING IS UNPUBLISHED. RELEASED FOR PUBLICATION
 BY AMP INCORPORATED, ALL INFORMATION RIGHTS RESERVED. 18

588 957
 969
 970

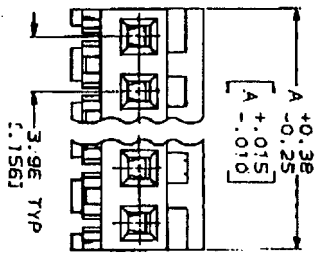
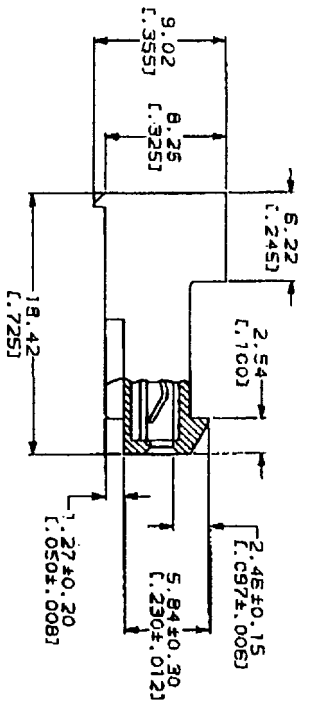
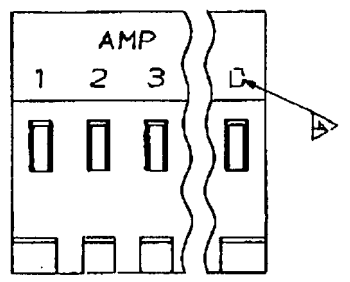

- △ MATERIAL: CONNECTOR - NYLON U94V-2 (NATURAL). CONTACTS - 0.30(.012) THICK COPPER ALLOY (BRIGHT-TIN 0.00203 [L.000080] MIN THK)
- 2. CONTACTS ACCEPT 24 AWG WIRE WITH 2.41[.095] MAX INSULATION DIAMETER.
- 3. CONTACTS MUST ACCEPT 1.14±0.03(.045 ±.001) SQUARE POST AND REMAIN LOCKED IN POSITION.
- △ IDENTIFICATION NUMBER FOR LAST CIRCUIT MAY NOT APPEAR ON ALL ASSEMBLIES.
- 5. DIMENSIONS IN BRACKETS ARE IN INCHES.
- 5. HOUSING FEATURES ARE CLOSED END WITH LOCKING RAMP.

METRIC

REV	DATE	DESCRIPTION	BY	CHK
1	11-1-60	REBRW & REV PER ECN CH-2973		

SIZE	NO OF CIRCUITS	PART NO
47.55 [1.872]	12	1-640429-2
45.59 [1.716]	11	1-640429-1
39.62 [1.560]	10	1-640429-0
35.66 [1.404]	9	640429-9
31.70 [1.248]	8	640429-8
27.74 [1.092]	7	640429-7
23.77 [0.936]	6	640429-6
19.81 [0.780]	5	640429-5
15.85 [0.624]	4	640429-4
11.89 [0.468]	3	640429-3
7.92 [0.312]	2	640429-2

DO NOT SCALE PRINT, DIMENSIONS SPECIFIED IN INCHES (UNLESS SPECIFIED OTHERWISE) FOR BRACKETS IN INCHES

1 P.L.C. DEC 4 6:19 (1960)

NAME: MTA 156 CONNECTOR ASSEMBLY, 24 AWG, STANDARD

AMP Incorporated, Harrisburg, PA 17105-3806

OR: 3-12-91

PRODUCT SIZE: 108-1051

APPROVAL: 114-1020

SCALE: 4:1

SHEET: 1 OF 1