

# Push Button Switch

**multicomp** PRO

**RoHS  
Compliant**



## Specifications

|                       |   |
|-----------------------|---|
| Rating                | : 2A 24V DC                             |
| Electrical Life       | : Min. 10,000 cycles.                   |
| Mechanical Life       | : 1,000,000 cycles.                     |
| Insulation Resistance | : 100 MΩ Min. at 500V DC.               |
| Dielectric Strength   | : 500Vrms @ sea level                   |
| Contact Resistance    | : 100mΩ Max. @ 1A/12V DC(initial value) |
| Operation Temperature | : -20°C to +65°C                        |
| Travel                | : 1.5mm (.059) ±0.3mm                   |
| Operation Pressure    | : 7N ±2N.                               |
| Ingress Protection    | : IP67                                  |
| Torque                | : 0.5 to 1Nm max. applied to nut        |

## Materials



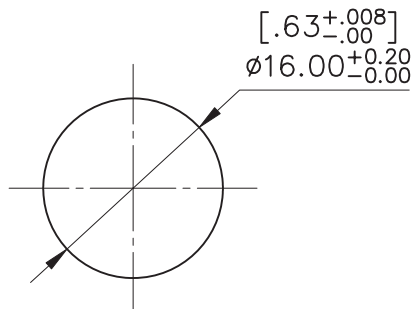

|              |                          |
|--------------|--------------------------|
| Case/Bushing | : Nylon 6/6              |
| Cap          | : Polyurethane           |
| Button       | : Stainless steel        |
| Actuator     | : POM                    |
| Nut          | : SPCC (Nickel Plated)   |
| O-RING       | : Silicone (Translucent) |



**PANEL CUTOUT**

Panel thickness: 7mm (.276) max.

## Switch Function

| Model No.          | Pos.1   | Pos.2   |
|--------------------|---|---|
|                    |  |  |
|                    | OFF   | MOM (ON)  |
| MPMD16-P2103D-L001 | CLOSE   | OPEN  |
| Schematic          |  |  |

**multicomp** PRO

