



EX-RDLMWS

- Illuminated pushbutton
- Ex-Zone 1 and 21

Data

Ordering data

| | |
|-------------------------------|---------------|
| Product type description | EX-RDLMWS |
| Article number (order number) | 101197356 |
| EAN (European Article Number) | 4030661599717 |
| eCl@ss number, version 12.0 | 27-37-12-11 |
| eCl@ss number, version 11.0 | 27-37-12-11 |
| eCl@ss number, version 9.0 | 27-37-12-11 |
| ETIM number, version 7.0 | EC000223 |
| ETIM number, version 6.0 | EC000223 |

Approvals - Standards

| | |
|--------------|---------------|
| Certificates | TÜV IEC Ex |
|--------------|---------------|

Explosion protection

| | |
|-----------------------------------|-------------------------------------------------------------|
| Explosion protection: regulations | EN IEC 60079-0 EN 60079-11 EN 60079-14 EN 60079-31 |
|-----------------------------------|-------------------------------------------------------------|

| | |
|----------------------------------|-----------------------------------------------------------------------------------------------------------------------------------------------------------------------------------------------------------------|
| Explosion protection zones | 1 21 2 22 |
| Explosion protection category | 2G 2D |
| Explosion protection designation |  II 2G Ex ib IIC Gb  II 2D Ex ib IIIC Db |

General data

| | |
|--------------------------------------|--------------------------------------------------------|
| Standards | EN ISO 13849-1 EN IEC 60947-5-1 EN IEC 60947-5-5 |
| Design | Round |
| Material of the identification label | Stainless steel (V4A) |
| Material of the front ring | Aluminium |
| Gross weight | 59 g |

Safety classification

| | |
|--------------|------------|
| Mission time | 20 Year(s) |
|--------------|------------|

Safety classification - Safety outputs

| | |
|-----------------------------------------------|--------------------|
| B _{10D} Normally-closed contact (NC) | 100,000 Operations |
|-----------------------------------------------|--------------------|

Mechanical data

| | |
|------------------|------|
| Actuating stroke | 4 mm |
|------------------|------|

Mechanical data - Dimensions

| | |
|---------------------------------------|---------|
| Mounting diameter | 22.3 mm |
| Thickness of the front panel, maximum | 6 mm |

Ordering code

Product type description:

EX-R(1)

(1)

| | |
|-----------------------|----------------------------------------------------------------------------------------------------------|
| DT(2)-(7) | Pushbutton, Ø 28 mm, buttons in MS, coated |
| DM(2)-(7) | Pushbutton with diaphragm, Ø 28 mm, buttons in MS, coated |
| DL(3)-(7) | Illuminated pushbutton, Ø 28 mm, swivel in impact-resistant plastic |
| DLM(3)-(7) | Illuminated pushbutton with diaphragm, Ø 28 mm, swivel in impact-resistant plastic |
| MLH(3)-(7) | Indicator lights for LED´s, protruding swivel in impact-resistant plastic |
| DP40(2)-(7) | Mushroom head impact button without latching, button Ø 37 mm in MS, coated |
| DRZ45(2)(3)(5) | Mushroom head impact button with latching, device head in MS, coated, pull to unlock |
| WT21 | Spring-return rotary selector switch with 2 positions |
| WT21.1 | Spring-return rotary selector switch with 2 positions, long gag |
| WS21 | Selector switch with 2 latched positions |
| WS21.1 | Selector switch with 2 latched positions, long gag |
| WT32 | Spring-return rotary selector switch with 3 positions |
| WT32.1 | Spring-return rotary selector switch with 3 positions, long gag |
| WST32 | Spring-return rotary selector switch, 3 positions; right: latching, left: switching |
| WST32.1 | Spring-return rotary selector switch, 3 positions; right: latching, left: switching; long gag |
| WS32 | Selector switch with 3 latched positions |
| WS32.1 | Selector switch with 3 latched positions, long gag |
| WTS32 | Maintained spring-return rotary selector switch, 3 positions, right: switching, left: latching |
| WTS32.1 | Maintained spring-return rotary selector switch, 3 positions, right: switching, left: latching; long gag |
| SS21S2 | Key-operated selector switch with 2 latched positions, key withdrawal left only |
| SS21S12 | Key-operated selector switch with 2 latched positions, key withdrawal right only |

| | |
|------------------|---------------------------------------------------------------------------------------------------------------------------------------------------------------------|
| SS21S12 | Key-operated selector switch with 2 latched positions, key withdrawal in both positions |
| SS32S2 | Key-operated selector switch with 3 latched positions, key withdrawal left only |
| SS32S2 | Key-operated selector switch with 3 latched positions, key withdrawal in the middle |
| SS32S3 | Key-operated selector switch with 3 latched positions, key withdrawal right |
| SS32S123 | Key-operated selector switch with 3 latched positions, key withdrawal in all 3 positions |
| ST21S1 | Key-operated spring-return selector switch with 1 touch position, automatic return to the zero position, latch position 55°, key withdrawal left only |
| ST32S2 | Key-operated spring-return selector switch with 2 touch positions left and right, automatic return to the zero position, key withdrawal only in the middle |
| SST32S1 | Key-operated selector switch pushbutton with 3 positions, touch position 35°, latch position 55°, left switching, right latching, key withdrawal left only |
| SST32S2 | Key-operated selector switch pushbutton with 3 positions, touch position 35°, latch position 55°, left switching, right latching, key withdrawal only in the middle |
| STS32S2 | Key-operated selector switch pushbutton with 3 positions, touch position 35°, latch position 55°, left switching, right latching, key withdrawal only in the middle |
| STS32S3 | Key-operated selector switch pushbutton with 3 positions, touch position 35°, latch position 55°, left switching, right latching, key withdrawal right only |
| F 03 | Contact element with screw connection, 1 NO contact, Contact Label 3, 4 |
| F 10 | Contact element with screw connection, 1 NC contact, Contact Label 1, 2 |
| LDE WS 24 | White luminous element with integrated LED for illuminated pushbutton RDL / RDLM and indicator light RMLH |
| B | Blanking plug |
| (2) | |
| SW | Black |

| | | |
|-----------|--|--------|
| (3) | | |
| GB | | Yellow |
| (4) | | |
| RT | | Red |
| (5) | | |
| GN | | Green |
| (6) | | |
| WS | | White |
| (7) | | |
| BL | | Blue |

Pictures

Product picture (catalogue individual photo)



ID: krdlmf10

| 449.6 kB | .jpg | 352.425 x 367.594 mm - 999 x 1042 px - 72 dpi

| 39.5 kB | .png | 73.731 x 76.906 mm - 209 x 218 px - 72 dpi

| 59.5 kB | .jpg | 118.533 x 123.472 mm - 336 x 350 px - 72 dpi

Dimensional drawing basic component

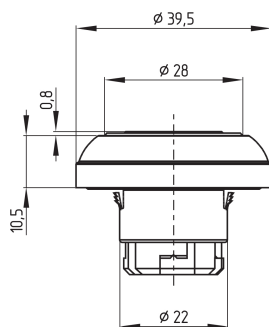

ID: 1rdl-g01

| 23.3 kB | .cdr |

| 3.7 kB | .png | 74.083 x 89.606 mm - 210 x 254 px - 72 dpi

| 114.0 kB | .jpg | 352.778 x 426.861 mm - 1000 x 1210 px - 72 dpi

Schmersal Ltd., Sparrowhawk Close, WR14 1GL Malvern

The details and data referred to have been carefully checked. Images may diverge from original. Further technical data can be found in the manual. Technical amendments and errors possible.

Generated on: 05/02/2024, 09:09