



EX-RDRZ45RT

- Emergency stop latching pushbutton
- Ex-Zone 1 and 21

Data

Ordering data

Product type description	EX-RDRZ45RT
Article number (order number)	101193587
EAN (European Article Number)	4030661455426
eCl@ss number, version 12.0	27-37-12-12
eCl@ss number, version 11.0	27-37-12-12
eCl@ss number, version 9.0	27-37-12-12
ETIM number, version 7.0	EC001038
ETIM number, version 6.0	EC001038

Approvals - Standards

Certificates	TÜV IEC Ex
--------------	---------------

Explosion protection

Explosion protection: regulations	EN IEC 60079-0 EN 60079-11 EN 60079-14 EN 60079-31
-----------------------------------	-------------------------------------------------------------

Explosion protection zones	1 21 2 22
Explosion protection category	2G 2D
Explosion protection designation	 II 2G Ex ib IIC Gb  II 2D Ex ib IIIC Db

General data

Standards	EN ISO 13849-1 EN IEC 60947-5-1 EN IEC 60947-5-5
Design	Round
Material of the identification label	Stainless steel (V4A)
Material of the front ring	Aluminium
Gross weight	200 g

Safety classification

Mission time	20 Year(s)
--------------	------------

Safety classification - Safety outputs

B _{10D} Normally-closed contact (NC)	100,000 Operations
-----------------------------------------------	--------------------

Mechanical data

Actuating stroke	4 mm
------------------	------

Mechanical data - Dimensions

Mounting diameter	22.3 mm
Thickness of the front panel, maximum	6 mm

Ordering code

Product type description:

EX-RD (1)(2)(3)(4)

(1)	
R	latching
(2)	
Z	Release by pulling only
(3)	
45	Head diameter 45 mm
(4)	
RT	Red colour

Pictures

Product picture (catalogue individual photo)



ID: krdr4f02

| 648.5 kB | .jpg | 352.778 x 380.294 mm - 1000 x 1078 px - 72 dpi

| 45.2 kB | .png | 74.083 x 79.728 mm - 210 x 226 px - 72 dpi

| 65.5 kB | .jpg | 114.653 x 123.472 mm - 325 x 350 px - 72 dpi

Dimensional drawing basic component

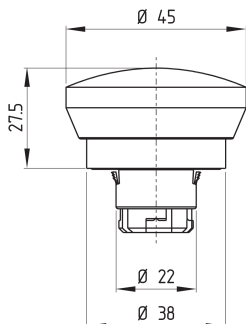

ID: kxrd4g01

| 25.4 kB | .cdr |

| 3.7 kB | .png | 74.083 x 99.836 mm - 210 x 283 px - 72 dpi

| 120.7 kB | .jpg | 352.778 x 475.897 mm - 1000 x 1349 px - 72 dpi

Dimensional drawing basic component

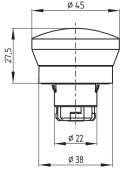

ID: 1rdr5g01

| 22.3 kB | .cdr |

| 2.4 kB | .png | 74.083 x 51.506 mm - 210 x 146 px - 72 dpi

| 42.8 kB | .jpg | 352.778 x 245.181 mm - 1000 x 695 px - 72 dpi

Schmersal Ltd., Sparrowhawk Close, WR14 1GL Malvern

The details and data referred to have been carefully checked. Images may diverge from original. Further technical data can be found in the manual. Technical amendments and errors possible.

Generated on: 14/02/2024, 06:33