



SERIES LA SWITCHES

PUSHBUTTON SWITCHES - SEALED ILLUMINATED



SPECIFICATIONS

| | |
|-------------------------------|--|
| Contact Rating: | 5A @ 250 VAC 8A @ 125 VAC .2A @ 250 VDC 6A @ 24 VDC |
| Life Expectancy (Mechanical): | ≥ 100,000 cycles |
| Life Expectancy (Electrical): | ≥ 50,000 cycles |
| Contact Resistance: | 100mΩ max. typical; initial @ 2-4 VDC |
| Insulation Resistance: | > 1,000MΩ |
| Dielectric Strength: | > 1,500 volts 1 minute > 3,000 volts between poles |
| Actuation Force: | 300g / pole |
| Operating Temperature: | -20°C to 55°C |
| Degree of Protection: | IP65 |

FEATURES & BENEFITS

- ▶ Modular interface/contact block design
- ▶ Robust product for industrial applications
- ▶ Attractive front panel design
- ▶ Illuminated options available

APPLICATIONS/MARKETS

- ▶ Industrial controls
- ▶ Instrumentation
- ▶ Transportation
- ▶ Telecommunications

MATERIALS

| | |
|------------------|----------------------------|
| Switch Housing: | Polyetherimide (PEI) |
| Contact Housing: | Diallyl Phthalate (DAP) |
| Actuator Ring: | Polycarbonate (PC) |
| Lens: | Polycarbonate (PC) |
| Contacts: | Silver plated copper alloy |
| Terminals: | Silver plated copper alloy |



HOW TO ORDER

| SERIES LA | TERMINATION | MECHANICAL CONFIGURATION | PUSHBUTTON HEAD | CIRCUIT | LAMP TYPE & VOLTAGE | LAMP COLOR (WHERE APPLICABLE) | LENS COLOR |
|--------------|---|--|--|--|---|-------------------------------------|---|
| | S = Solder Lug K = Socket P = Pilot Indicator | EE = Latching OA = Momentary PL* = Pilot Indicator *For LAP (Pilot Indicator) | U1 = Ø29mm V1 = Ø25mm U3* = Ø35mm V3* = Ø29mm *Flush Mount | 0* = Pilot Ind. 1**= SPDT 2 = DPDT 3 = 3PDT 4 = 4PDT *For LAP (Pilot Indicator only) **LAK available SPDT only | 0 = None A B C F G H J K M N L D E | Red Grn Red Grn Yel | RED= Red GRN= Green BLU= Blue WHT= White ORG= Orange YEL= Yellow |



Example Ordering Number

LA-S-EE-U1-1-0-RED

Specifications subject to change without notice 10.28.19

LAMP TYPE & VOLTAGE OPTIONS

| | | |
|---|---|-------------------------------|
| 0 | : | Without lamp |
| A | : | Incandescent 6 V AC/DC 200 mA |
| B | : | Incandescent 14 V AC/DC 80 mA |
| C | : | Incandescent 28 V AC/DC 40 mA |
| D | : | Incandescent 48 V AC/DC 25 mA |
| E | : | Incandescent 60 V AC/DC 20 mA |
| F | : | Neon 110 V AC green/red |
| G | : | Neon 220 V AC green/red |

LAMP TYPE & VOLTAGE OPTIONS

| | | |
|---|---|-------------------------------|
| H | : | LED 6 V DC green/yellow/red |
| J | : | LED 12 V DC green/yellow/red |
| K | : | LED 24 V DC green/yellow/red |
| L | : | Incandescent 33 V AC/DC 35 mA |
| N | : | Incandescent 14 V AC/DC 40 mA |
| M | : | Incandescent 6 V AC/DC 40 mA |

SERIES LA SWITCHES

PUSHBUTTON SWITCHES - SEALED ILLUMINATED

TERMINATION & PUSHBUTTON HEAD OPTIONS

LAS

SOLDER LUG

U1 Ø29mm

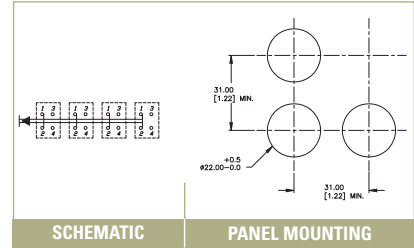
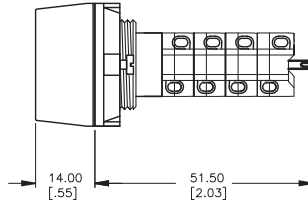
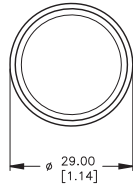

SCHEMATIC

PANEL MOUNTING

V1 Ø25mm

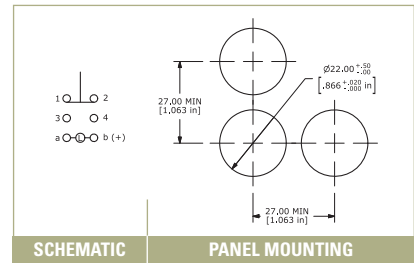
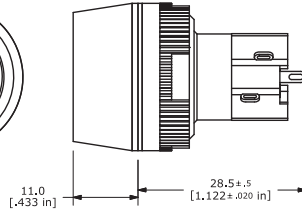
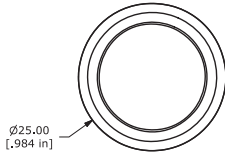

SCHEMATIC

PANEL MOUNTING

U3

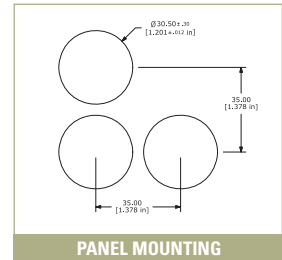
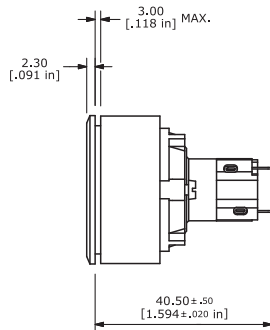
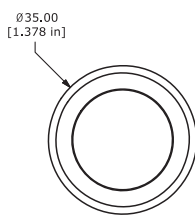

PANEL MOUNTING

V3

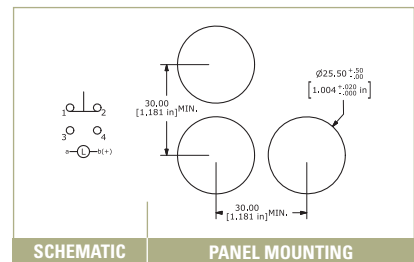
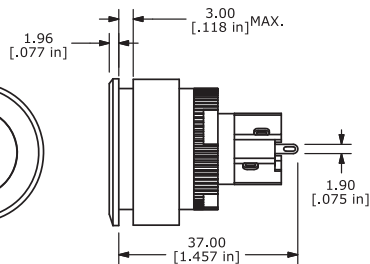
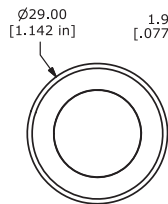

SCHEMATIC

PANEL MOUNTING

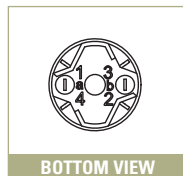

BOTTOM VIEW

| | Mounting Length (A) |
|------|---------------------|
| SPDT | 29.0 mm |
| DPDT | 36.5 mm |
| 3PDT | 44.0 mm |
| 4PDT | 51.5 mm |

TERMINATION & PUSHBUTTON HEAD OPTIONS

LAK

SOCKET

U1 Ø29mm

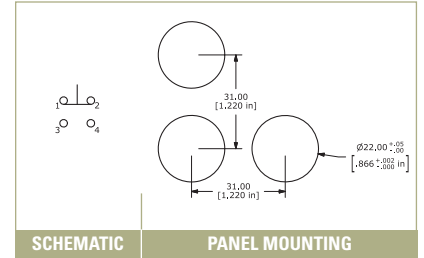
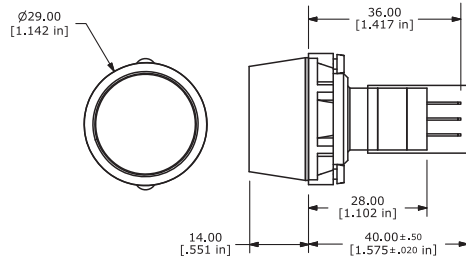

V1 Ø25mm

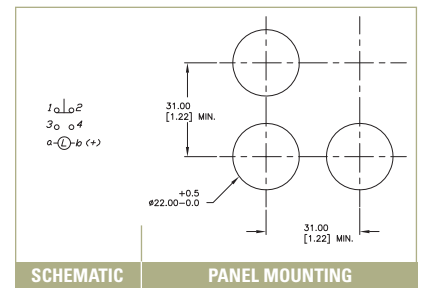
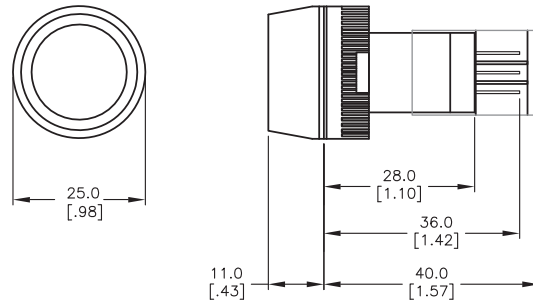

U3

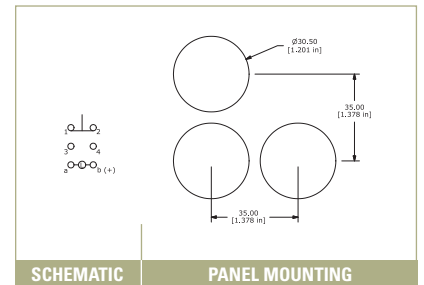
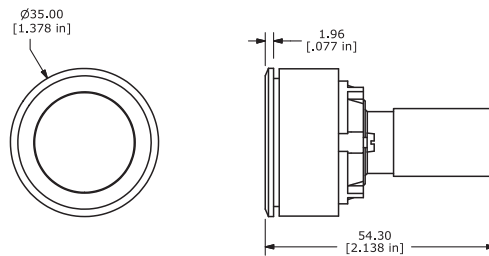

V3

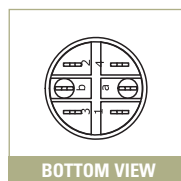
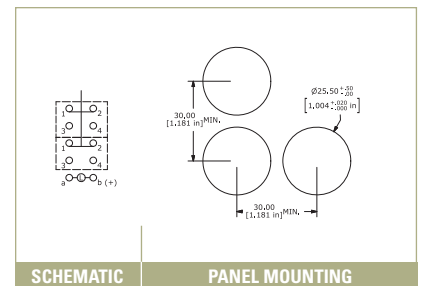
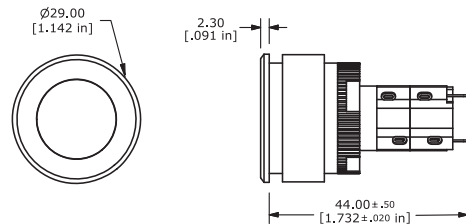

TACT SWITCHES
NAVIGATION SWITCHES
PUSHBUTTON SWITCHES
TOGGLE SWITCHES
ROCKER SWITCHES
SLIDE SWITCHES
SNAP-ACTION SWITCHES
DIP SWITCHES
KEYLOCK SWITCHES
ROTARY SWITCHES
DETECTOR SWITCHES
CAP OPTIONS

SERIES LA SWITCHES

PUSHBUTTON SWITCHES - SEALED ILLUMINATED

TERMINATION & PUSHBUTTON HEAD OPTIONS

LAP

PILOT INDICATOR

U1 Ø29mm

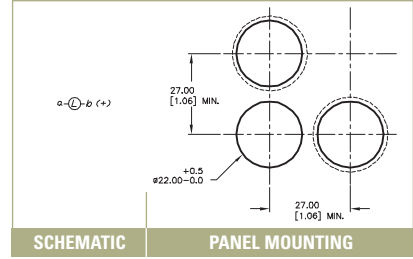
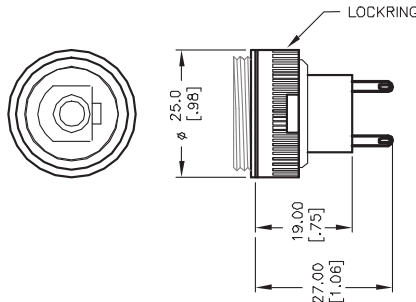

V1 Ø25mm

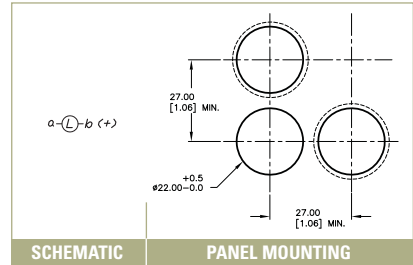
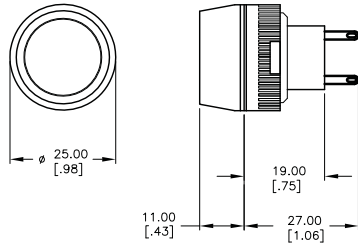

U3

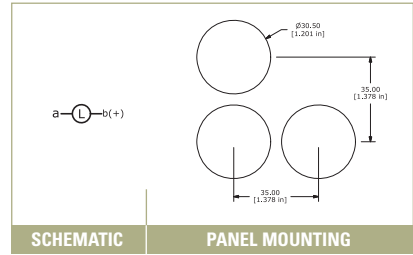
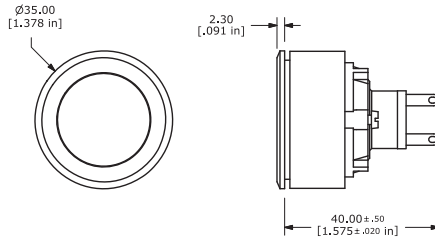

V3

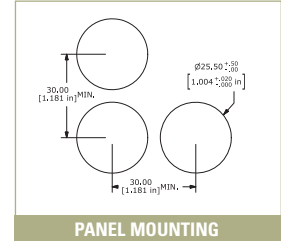
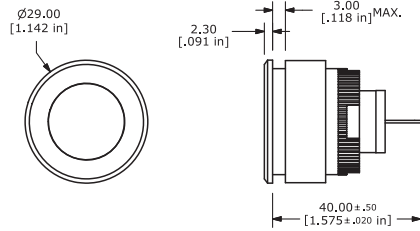

MECHANICAL CONFIGURATION & CIRCUIT OPTIONS

0 PILOT INDICATOR

Available LAS Pilot Indicator



SCHEMATIC

1 SPDT

Available for LAK Socket Type and LAS Solder Lug

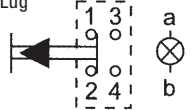

SCHEMATIC

2 DPDT

Available for LAS Solder Lug



SCHEMATIC

3 3PDT

Available for LAS Solder Lug

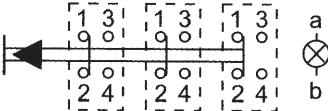

SCHEMATIC

4 4PDT



SCHEMATIC

Mechanical Configuration Code

| | |
|----|-----------------|
| EE | Latching |
| OA | Momentary |
| PL | Pilot Indicator |