

8800 Thinline Rocker Switches 10A 250Vac



- ▶ Ultra thin rocker switch
- ▶ Ratings up to 15A, 250Vac
- ▶ Single and twin gang
- ▶ Panel cut out:
Single 17.4 x 6.8
Twin 17.4 x 13.4



10(6)A 250Vac T100
6(2)A 250Vac T100 5E4 (50,000 Operations)
Inrush 50A to EN60065:1998



UL CSA 15A 250Vac (Twin unit is 10A 250Vac)
UL CSA 125Vac 1/2hp
UL 100°C, file E45221, CSA file LR10990



RoHS compliant

3mm contact gap.
Technical data on pages 4 & 5.

H 8800 V A - - -

TERMINAL FUNCTION ROCKER BODY PRINT, COLOUR, ETC

| ▶ TERMINAL | ▶ FUNCTION | | ▶ ROCKER |
|--|------------------|---|----------------------------|
| <p>H</p> <p>4.8 x 0.8</p> | | <p>Switches are ON when pressed over terminal 1</p> | <p>V Curved</p> |
| | 8800 | <p>ON - OFF Single pole</p> | |
| <p>T</p> <p>3.5 x 0.8 Solder</p> | | <p>Switches are ON when pressed over terminals 1 or 3</p> | |
| | 8800/8800 | <p>ON - OFF Twin (Single pole)</p> | |
| <p>X</p> <p>0.8Sq Solder *</p> <p>*Available for single switch only, not twin</p> | | | |



X8800VA ---



H8800VA ---
T8800VA ---



H8800VA ---
T8800VA ---



H8800V/H8800VA
T8800V/T8800VA



H8800V/H8800VA
T8800V/T8800VA

BODY

A Single pole

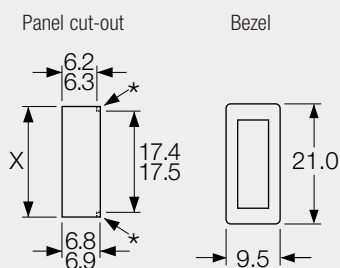

*Optional profile for orientation

A Single pole - Twin

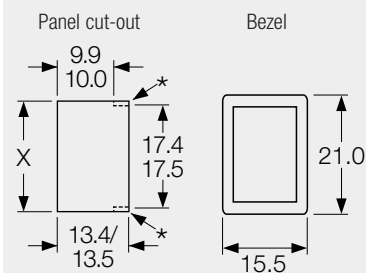

*Optional profile for orientation

| Panel thickness | Dim X |
|-----------------|-----------|
| 0.75-1.24 | 19.1/19.2 |
| 1.25-1.99 | 19.3/19.4 |
| 2.00-3.00 | 19.7/19.8 |

Cut-outs must be punched in the direction of insertion

OPTIONS

Finish

Matt finish only.

Colour

Call sales for custom colours.
A full range is available for large orders.

Legend printing

Select from the examples or call sales for custom legends.

Dimensions (mm)

8800VA (H terminals shown)

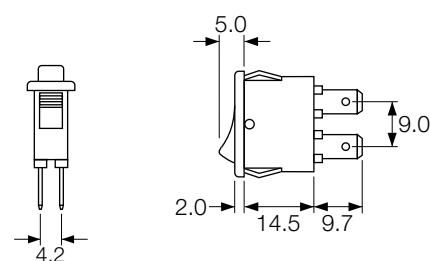

8800V/8800VA (H terminals shown)

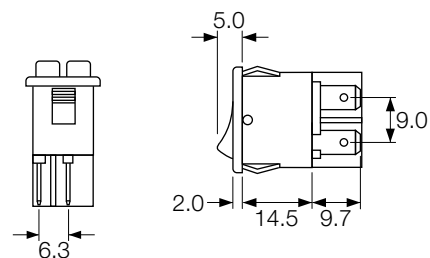

Examples of printing



CL132



CL133