

## MPC0750LR68C

Aliases (UPIA0750LR68C0)

Not for New Design

KEMET, MPC, Power, 0.68 uH, 20%, 3126

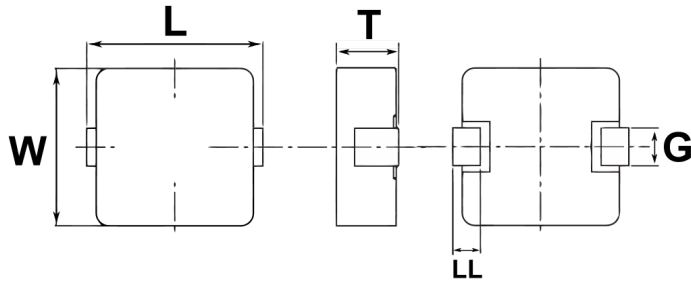

Click [here](#) for the 3D model.

### Dimensions

L	8mm MAX
W	6.7mm +/-0.3mm
T	5mm MAX
LL	1.5mm NOM
G	2mm +/-0.3mm

### Packaging Specifications

Packaging	T&R, 330mm
Packaging Quantity	1000

### General Information

Series	MPC
Style	SMD
Chip Size	3126
Description	Shielded, Surface Mount Inductor
Features	High Speed, Large Current DC/DC Converter
RoHS	Yes
Core	Composite

### Specifications

Inductance	0.68 uH
Inductance Tolerance	20%
Temperature Range	-40/+125°C
Rated Temperature	120°C
Shielded	Yes
Current	16 Amps (Isat, 20% Drop In Inductance), 18 Amps (Irms, 40C Rise By Self Heating)
DC Resistance	2.2 mOhms