

## MPLC1040L1R5

Aliases (UPID1040L1R500)

Not for New Design

KEMET, MPLC, Power, 1.5 uH, 20%, 4539

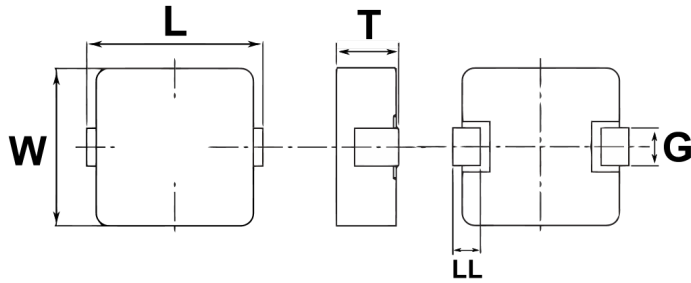

Click [here](#) for the 3D model.

### Dimensions

L	11.5mm MAX
W	10mm +/-0.2mm
T	4mm MAX
LL	2.1mm NOM
G	4mm +/-0.1mm

### Packaging Specifications

Packaging	T&R, 330mm
Packaging Quantity	500

### General Information

Series	MPLC
Style	SMD
Chip Size	4539
Description	Shielded, Surface Mount Inductor
Features	Large Current Inductors
RoHS	Yes
Core	Composite

### Specifications

Inductance	1.5 uH
Inductance Tolerance	20%
Temperature Range	-40/+125°C
Shielded	Yes
Current	12.7 Amps (Isat, 20% Drop In Inductance), 12.4 Amps (Irms, 40C Rise By Self Heating)
DC Resistance	7 mOhms