

REVISIONS			
REV	DESCRIPTION, ECN, EAR NO.	DATE	APP'D
A	PROPOSAL	DEC19/17	L.CHAN

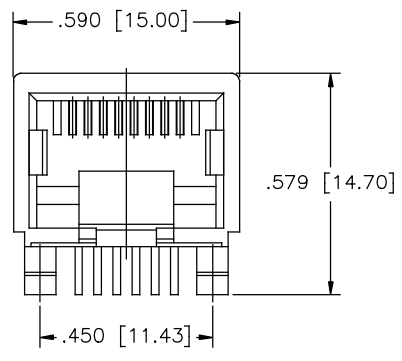

FRONT VIEW

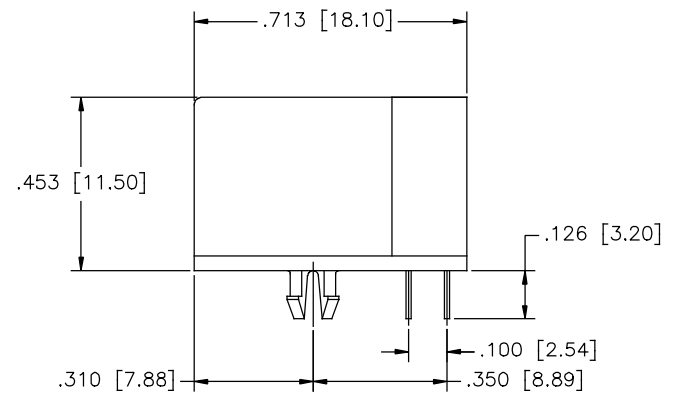

SIDE VIEW

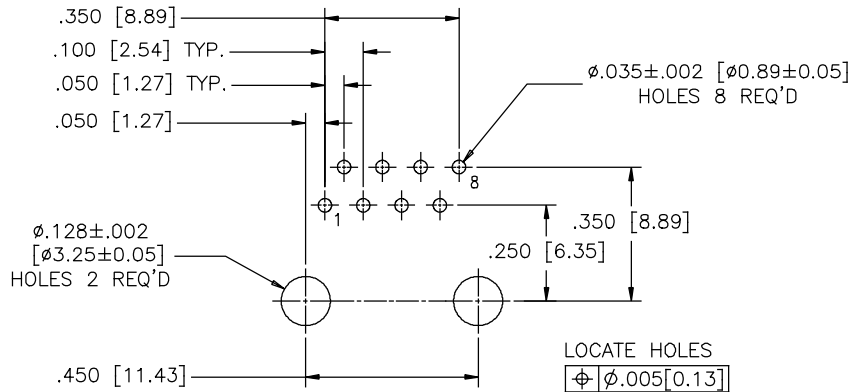

RECOMMENDED P.C.B. LAYOUT
(COMPONENT SIDE OF BOARD)

LOCATE HOLES
 $\phi \pm \phi .005 [0.13]$
 POSITION DIMENSIONS
 ARE BASIC

MATERIALS:
 PLASTIC HOUSING: HIGH TEMPERATURE THERMOPLASTIC
 FLAMMABILITY RATING UL94V-0. COLOUR, BLACK.

CONTACTS:
 PHOSPHOR BRONZE
 PLATING: REFER TO PART NUMBER FOR GOLD THICKNESS ON MATING SURFACES.
 50 μ " [1.27 MICRONS] MIN. NICKEL UNDERPLATE.
 100 μ " [2.54 MICRONS] MIN. MATTE-TIN OR GOLD FLASH ON CONTACT TAILS.

AMPHENOL PART NUMBER: RJE05-188-0X10-H

GOLD PLATING
 1 = 6 μ INCH
 2 = 15 μ INCH
 3 = 30 μ INCH
 4 = 50 μ INCH

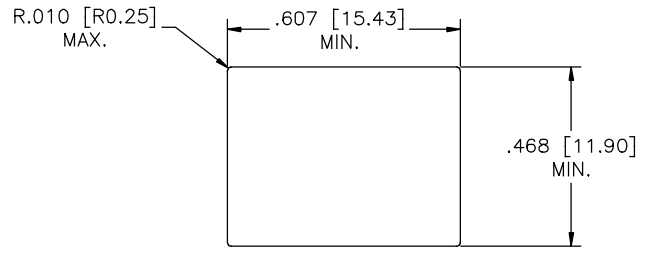

RECOMMENDED PANEL CUTOUT

UNLESS SPECIFIED OTHERWISE	DRAWN HANSON.C	DEC19/17	Amphenol Canada Corp. www.amphenolcanada.com
PRIMARY UNITS INCHES	CHECKED L.CHAN	DEC19/17	
SECONDARY MILLIMETERS	M.E. APP'D		RJE05 SERIES MODULAR JACK, 8 POSITION, 8 CONTACTS, UNSHIELDED ULTRA LOW PROFILE - RoHS COMPLIANT
REFERENCE IN PARENTHESES	Q.A. APP'D		
	DWG APP'D		DWG NO. P-RJE05-188-0X10-H
	ENG. REL. NO.		
1 DECIMAL PLACE	REF.		REV A
2 DECIMAL PLACES			
3 DECIMAL PLACES ± 0.015			
ANGULAR DEGREES $\pm 1.5'$	THIRD ANGLE PROJECTION	DO NOT SCALE DRAWING	
CODE ID NO. 03554		DWG SIZE	SCALE
SHEET 1 OF 1			