

REVISIONS			
REV	DESCRIPTION, ECN, EAR NO.	DATE	APP'D
A	PROPOSAL	NOV.15/13	L.CHAN
B	UPDATE DRAWING	SEP.26/16	L.CHAN

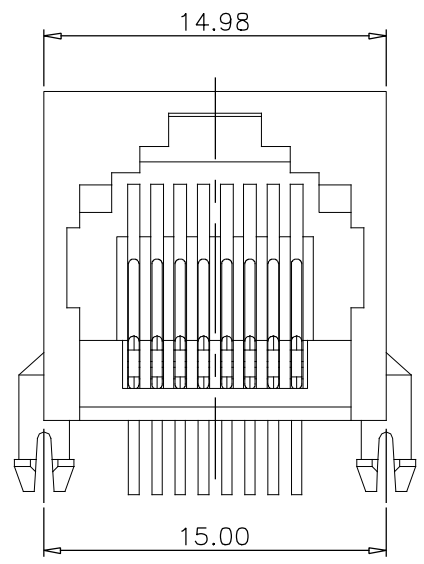

FRONT VIEW

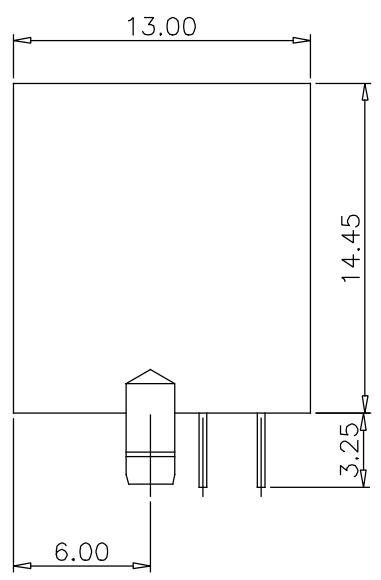

SIDE VIEW

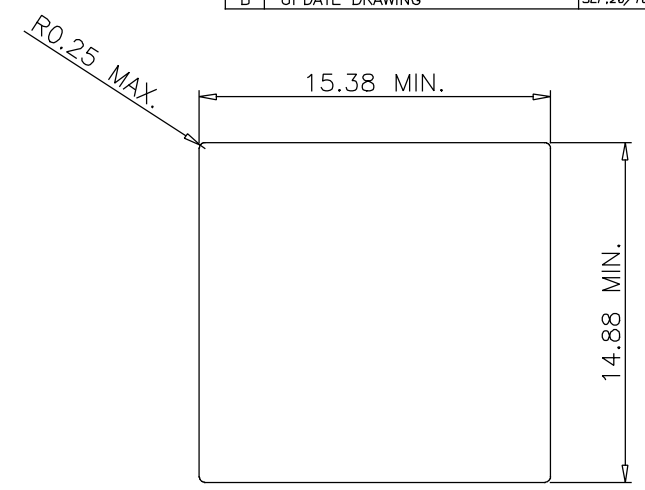

RECOMMENDED PANEL CUTOUT

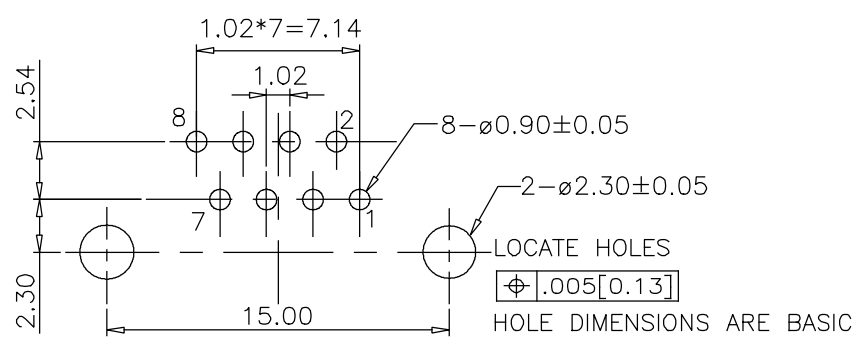

RECOMMENDED P.C.B. LAYOUT
(COMPONENT SIDE OF BOARD)

MATERIALS:

HOUSING: ENGINEERING THERMOPLASTIC
FLAMMABILITY RATING UL 94V-0,
COLOUR: BLACK

CONTACTS: PHOSPHOR BRONZE

PLATING: REFER PART NO. FOR GOLD PLATING THICKNESS
ON MATTING SURFACE
50 u" MIN. NICKEL UNDERPLATE
100 u" MIN. MATTE TIN OR GOLD FLASH OVER TAILS

AMPHENOL PART NO.: RJE29-188-0X10

GOLD PLATING

- 1 = 6 u"
- 2 = 15 u"
- 3 = 30 u"
- 4 = 50 u"

C:\Users\gnh\Desktop\new robe user\Capture.JPG

UNLESS SPECIFIED OTHERWISE	DRAWN G.HSIA	NOV.15/13
PRIMARY UNITS MILLIMETERS	CHECKED	
SECONDARY	M.E. APP'D	
REFERENCE IN PARENTHESES	Q.A. APP'D	
	DWG APP'D L.CHAN	NOV.15/13
	ENG. REL. NO.	
	REF.	
	THIRD ANGLE PROJECTION	DO NOT SCALE DRAWING

Amphenol Canada Corp. www.amphenolcanada.com		
MODULAR JACK, SINGLE PORT, 8 POSITION, 8 CONTACTS, NO SHIELD-RoHS COMPLIANTE		
DWG NO. P-RJE29-188-0X10	REV B	
CODE ID NO. 03554	DWG SIZE	SCALE
		SHEET 1 OF 1