

# SMD Multi-layer Ferrite Chip Beads

ABHV Series

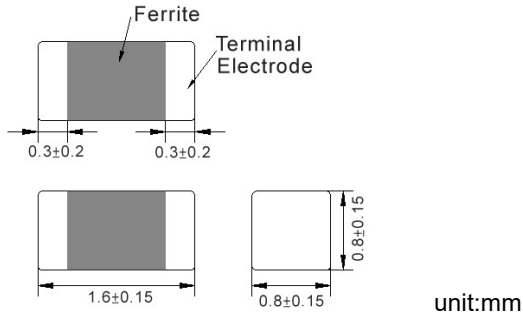

## ■ Dimensions



## ■ Recommended Land Pattern

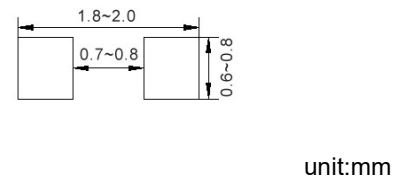

## ■ Electrical Characteristics

Part No.	Impedance ( $\Omega$ )	Test Freq.	RDC ( $\Omega$ )Max.	Rated Current (mA)Max.
ABHV00160808121Y00	120	100 MHz,200 mV	0.040	3000
ABHV00160808601Y00	600	100 MHz,200 mV	0.100	2000

**Note: When ordering, please specify tolerance code. Tolerance: Y=±25%**

1. Operating temperature range - 55°C ~ 125°C
2. Rate Current : Applied the current to coils, the temperature rise shall not be more than 30°C
3. Measure Equipment:  
Z: HP4291A  
RDC: HP4338B or CHEN HWA 502

# SMD Multi-layer Ferrite Chip Beads

BBPY Series

## ■ Packaging

### Tape Dimensions

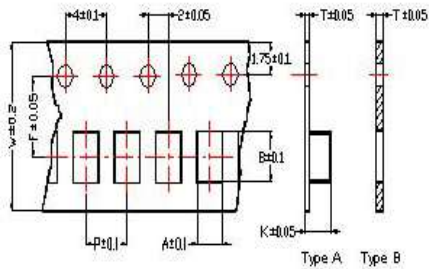

### Tape Material

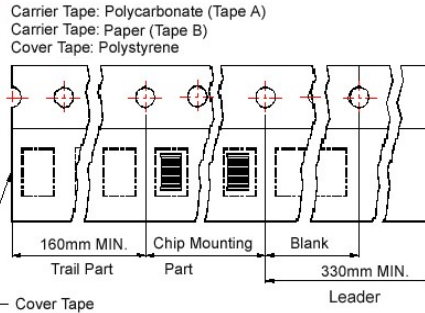

### Reel Dimensions

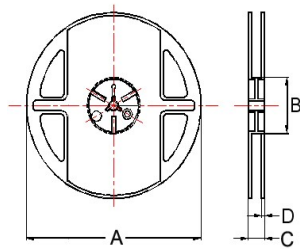

### Dimensions in mm

TYPE	Tape Dimensions							Tape	Reel Dimensions				Quantity PCS / Reel
	A	B	T	W	P	F	K		A	B	C	D	
ABHV00160808	1.05	1.85	0.95	8	4	3.5	-	B	178	60	12	2	4000

## ■ Characteristics Graph

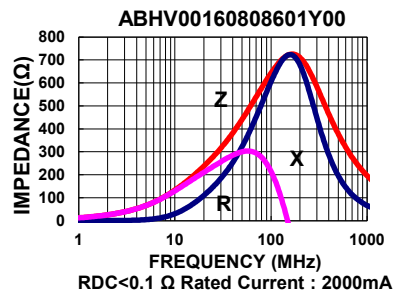
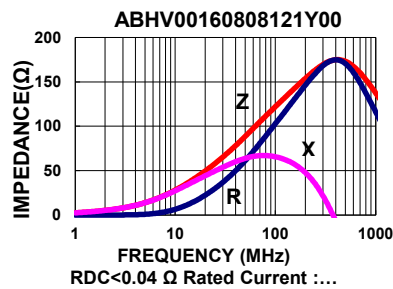

## For More Information

Americas - [proinfo\\_power\\_americas@yageo.com](mailto:proinfo_power_americas@yageo.com) | Europe - [proinfo\\_power\\_emea@yageo.com](mailto:proinfo_power_emea@yageo.com) | Asia - [proinfo\\_power\\_asia@yageo.com](mailto:proinfo_power_asia@yageo.com)

Performance warranty of products offered on this data sheet is limited to the parameters specified. Data is subject to change without notice. Other brand and product names mentioned herein may be trademarks or registered trademarks of their respective owners. © Copyright, 2023. Pulse Electronics, Inc. All rights reserved.

YAGEO Corporation and its affiliates do not recommend the use of commercial or automotive grade products for high reliability applications or manned space flight.