

No.MJ-156L

3-CONDUCTOR MINIATURE JACK. (SINGLE CLOSED)
Net Weight : 2.9 gr. (φ3.5)

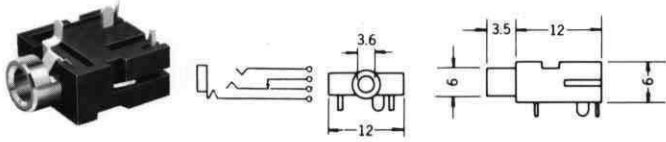

No.MJ-158L

PANEL MOUNT 3-CON. STEREO MINIATURE JACK. (SINGLE CLOSED)
Net Weight : 2 gr. (φ3.5)

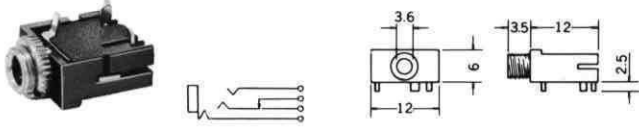

No.MJU-3XF (φ3.5)

STEREO

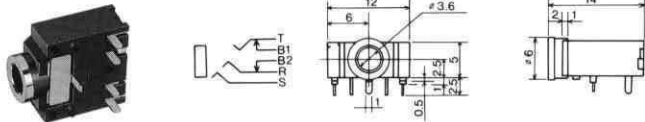

No.MJU-3XG (φ3.5)

STEREO

Net Weight : 1.5 gr.

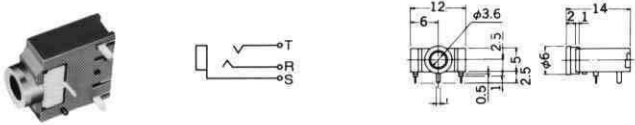

No.MX-345GLB (φ3.5)

STEREO

Net Weight : 1 gr.

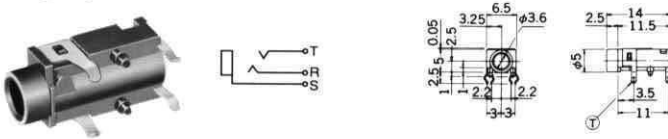

No.MX-387GL (φ3.5)

STEREO

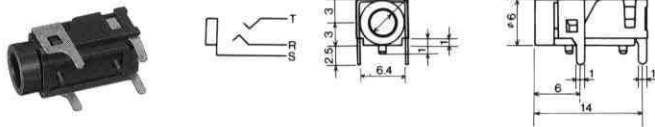

No.M03-610 (φ3.5)

STEREO

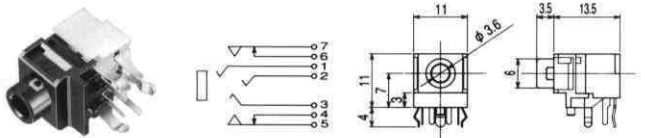

No.MJ-3-249A0

4-CONDUCTOR

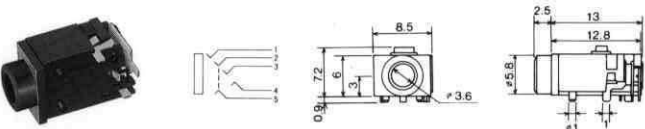

No.M03-772A0 (φ3.5)

STEREO

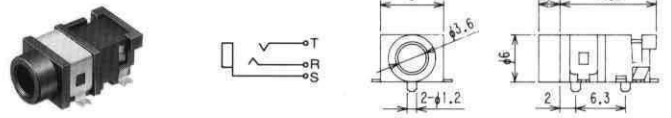

No.MJ-352 (φ3.5)

MONO

No.MJ-352N (φ3.5)

MONO W/O SCREW THREAD

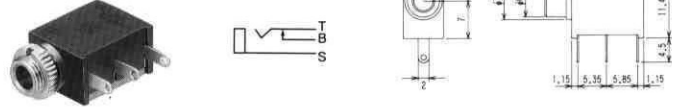

No.MJ-354A0 (φ3.5)

MONO

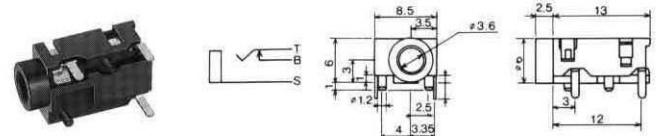

No.M03-663A0 (φ3.5)

STEREO

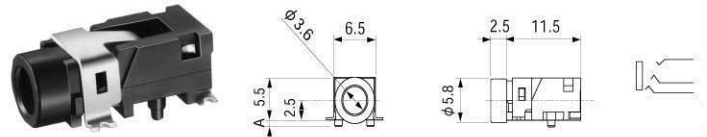

No.MJ-354W (φ3.5)

STEREO

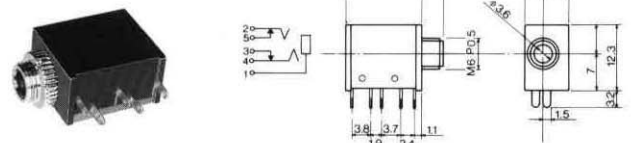

No.MJ-352W-C (φ3.5)

STEREO

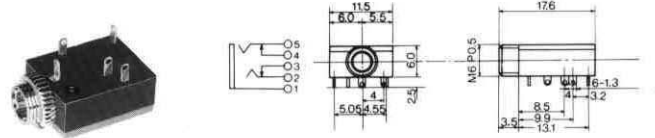

No.MJ-352W-0 (φ3.5)

STEREO

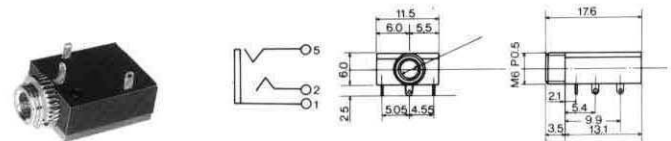

No.MX-233A1 (φ3.5)
5-CONDUCTOR

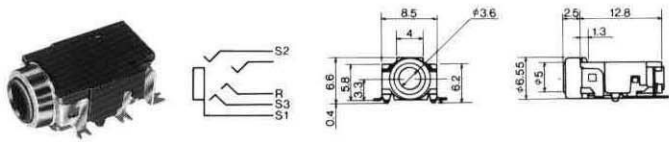

No.MX-385AGM (φ3.5)
5-CONDUCTOR

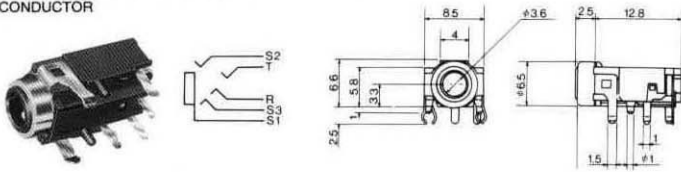

No.M03-428 (φ3.5)
6-CONDUCTOR

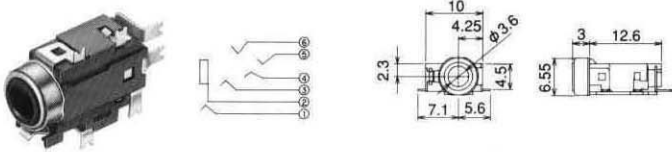

No.M03-721C0 (φ3.5)
6-CONDUCTOR

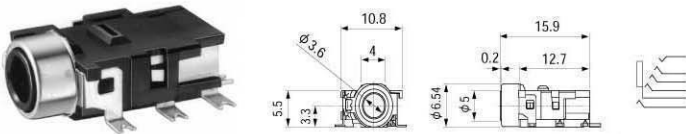

No.MJ-354W-S2
3.5MM STEREO JACK FOR P.C.
W/SHIELD HOUSING

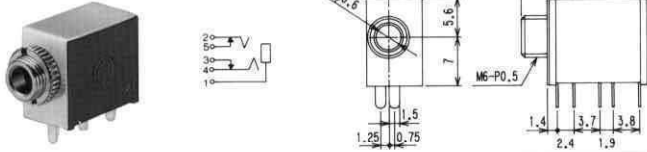

No.MJ-355 (φ3.5)
MONO

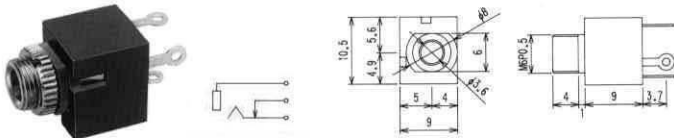

No.MJ-355W (φ3.5)
CHASSIS MTG. STEREO JACK

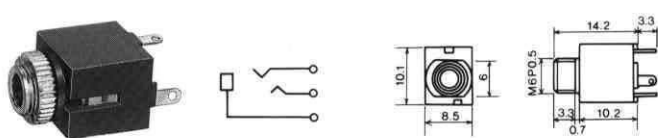

No.MX-362GL (φ3.5)
STEREO

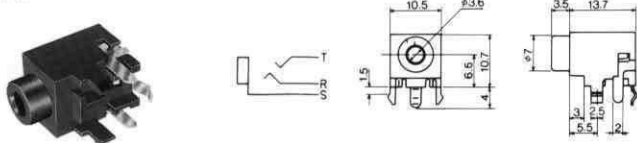

No.M03-292J1 (φ3.5)
STEREO

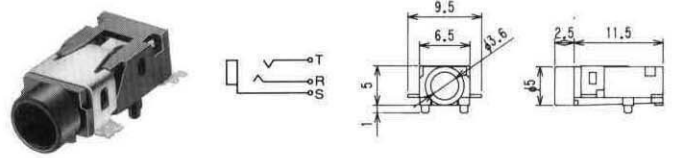

No.MJ-354W-SG (φ3.5)
STEREO

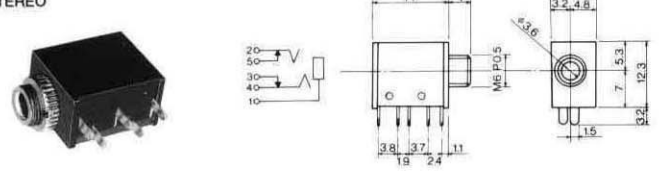

No.MJ-A18 (φ2.5)
STEREO

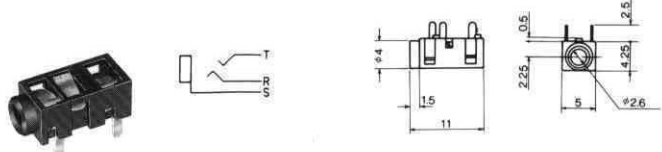

No.M02-641A0 (φ2.5)
STEREO

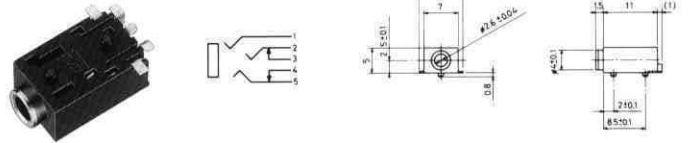

No.MJ-2-348A0 (φ2.5) With Metal Sleeve
No.MJ-2-348B0 (φ2.5) Without Metal Sleeve
SUB-MINIATURE STEREO JACK

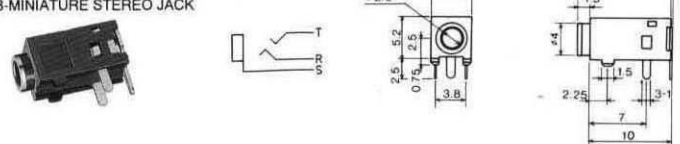

No.MJ-255 (φ2.5)
MONO

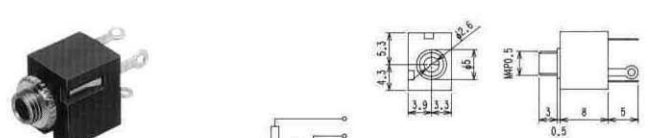

No.M03-681A0 (φ3.5)
STEREO

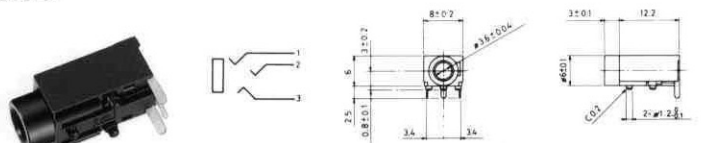

No.MJ-252 (φ2.5)
MONO

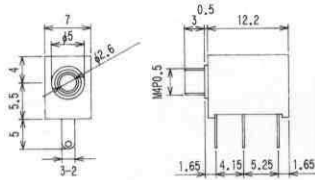
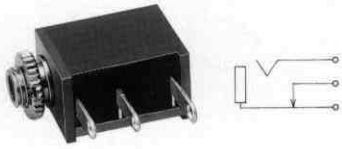

No.MJ-2435 (φ3.5)
STEREO

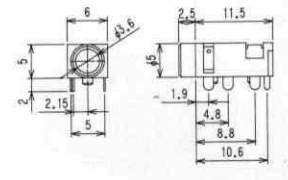

No.MJ-2925-5 (φ2.5)
STEREO

No.MJ-2925A (φ2.5)
STEREO

No.MJ-2925B (φ2.5)
STEREO

No.MJ-2925-3(φ2.5)
STEREO



No.MJ-2335 (φ3.5)
STEREO

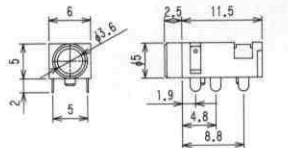

No.MJ-2235 (φ3.5)
MONO

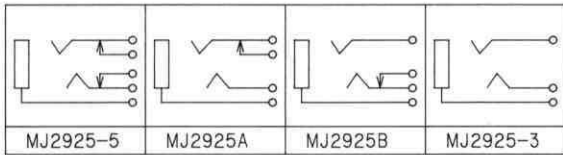
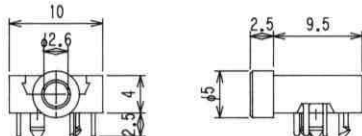
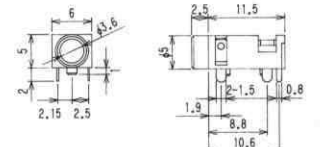

No.MJ-2135 (φ3.5)
4-CONDUCTOR

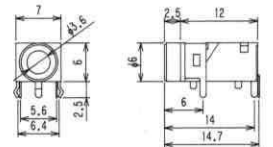

No.M02-815A0 (φ2.5)
STEREO

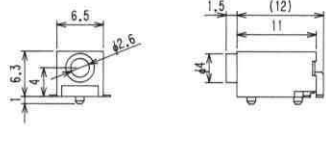
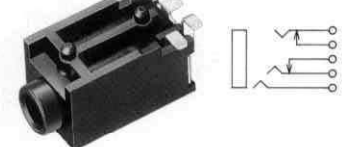

No.MJ-3335-6 (φ3.5)
STEREO

No.MJ-3335-5 (φ3.5)
STEREO

No.MJ-3335-4 (φ3.5)
STEREO

No.MJ-3335-3 (φ3.5)
STEREO

No.MJ-3335M (φ3.5)
MONO

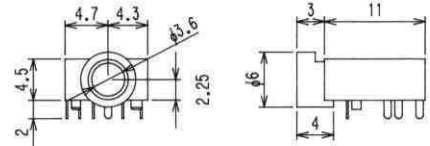

No.MJ-2625 (φ2.5)
MONO

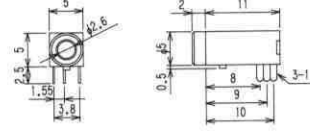

No.MJ-2035 (φ3.5)
STEREO

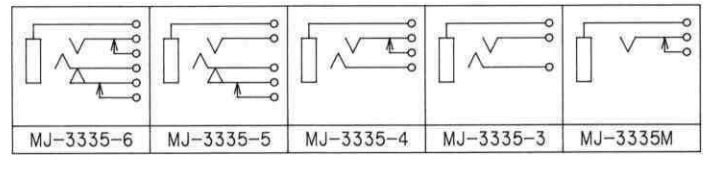
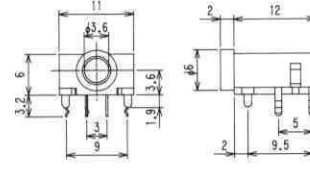
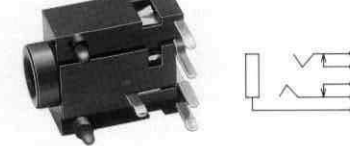

No.MJ-3235 (φ3.5)
MONO

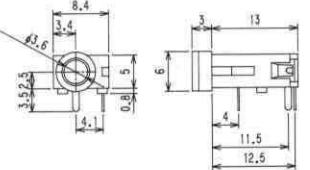

No.M03-798A0 (φ3.5)
STEREO

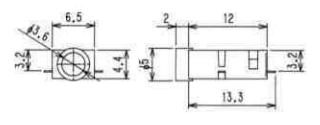

No.M03-749A0
3.5MM STEREO JACK FOR P.C.
WATER PROOF

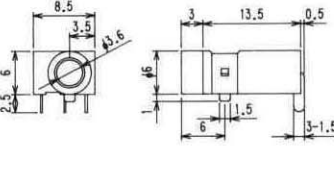
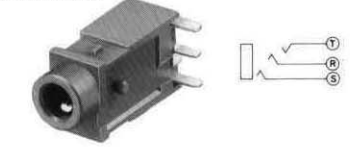

No.MJ-653
3.5MM DOUBLE STEREO JACK FOR P.C.
W/FULL SHIELD HOUSING

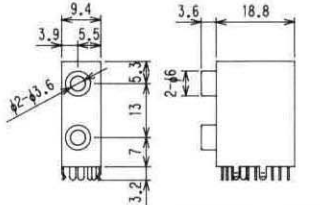
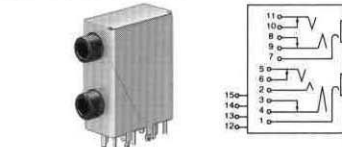

No.MJ-178M

NEW DESIGNED CHASSIS MTG.
3-CON. CLOSED CIRCUIT JACK
Net Weight : 7 gr.

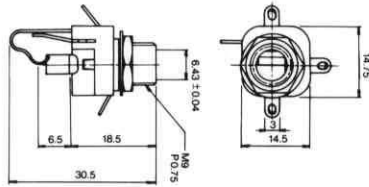

No.MJ-161M

NEW DESIGNED CHASSIS MTG.
3-CON. OPEN CIRCUIT JACK
Net Weight : 6.5 gr.

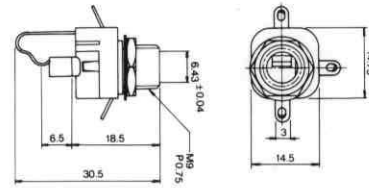

No.MJ-160M

NEW DESIGNED CHASSIS MTG.
2-CON. CLOSED CIRCUIT JACK
Net Weight : 6.5 gr.

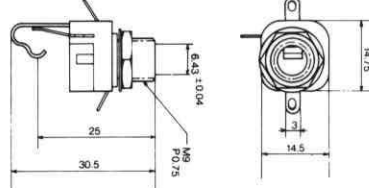

No.MJ-159M

NEW DESIGNED CHASSIS MTG.
2-CON. OPEN CIRCUIT JACK
Net Weight : 6 gr.

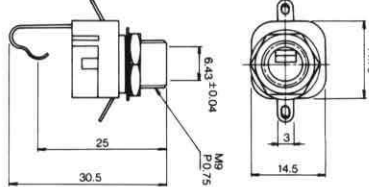

No.MJ-083

BRANDNEW MINIATURE (3.5mm) STEREO JACK
CLOSED CIRCUIT+CHASSIS MTG.
Net Weight : 2 gr.

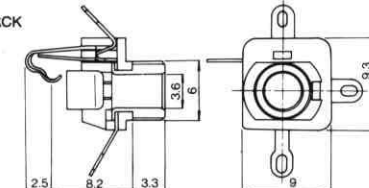

No.MJ-082

BRANDNEW MINIATURE (3.5mm) STEREO JACK
OPEN CIRCUIT+CHASSIS MTG.
Net Weight : 2 gr.

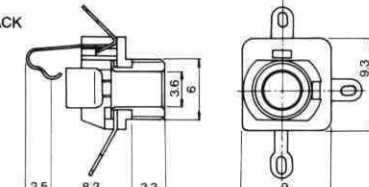

No.MJ-081

NEW DESIGNED MINIATURE (3.5mm) MONO JACK
CLOSED CIRCUIT+CHASSIS MTG.
Net Weight : 1.8 gr.

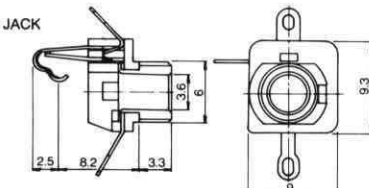

No.MJ-080

NEW DESIGNED MINIATURE (3.5mm) MONO JACK
OPEN CIRCUIT+CHASSIS MTG.
Net Weight : 1.5 gr.

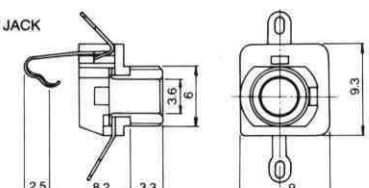

No.M03-517
3.5MM STEREO JACK FOR P.C.
w/metal sleeve

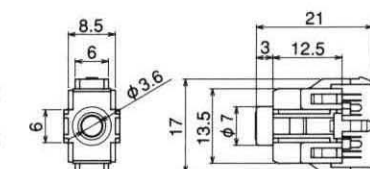
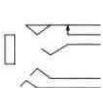

No.MJ-189

3-CONDUCTOR CLOSED CIRCUIT
PHONE JACK
Net Weight : 10 gr.

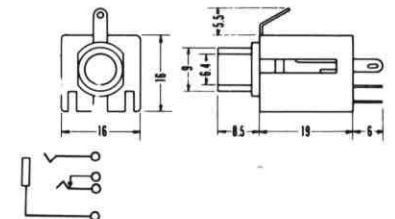

No.MJ-187

3-CONDUCTOR OPEN CIRCUIT
PHONE JACK
Net Weight : 9 gr.

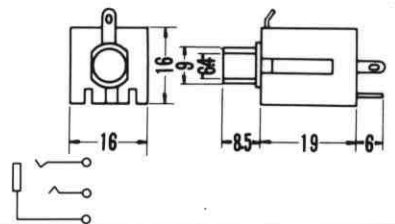

No.MJ-186

2-CONDUCTOR CLOSED CIRCUIT
PHONE JACK
Net Weight : 9 gr.

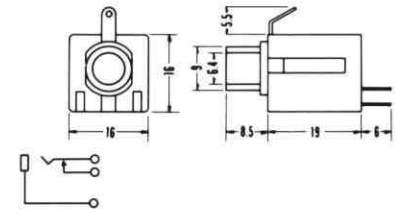

No.MJ-185

2-CONDUCTOR OPEN CIRCUIT
PHONE JACK
Net Weight : 9 gr.

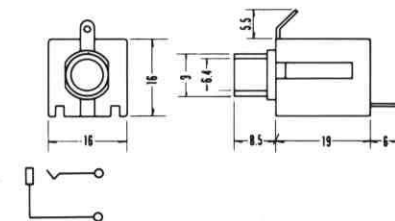

No.MJ-074N

CHASSIS MTG. 3-CON. STEREO
MINIATURE JACK (φ3.5)

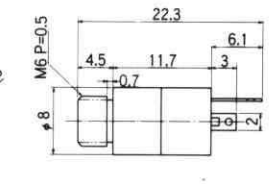
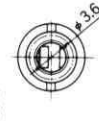
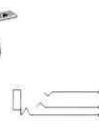

No.MJ-070N

CHASSIS MTG. 3-CON. SUB-MINI. JACK
(φ2.5)

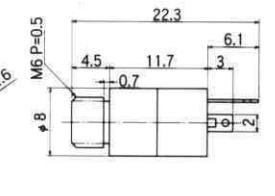
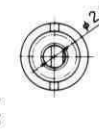

No.MJ-079

CHASSIS MTG. MINI. 4-CONDUCTOR
JACK(φ3.5)

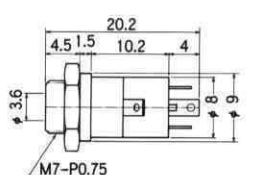
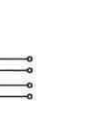
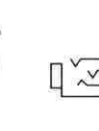

CHASSIS MTG. JACK

- No.MJ-073H (φ3.5) STEREO
- No.MJ-164H (φ3.5) MONO
- No.MJ-064H (φ3.5) 4-CONDUCTOR
- No.MJ-165H (φ2.5) MONO
- No.MJ-071H (φ2.5) STEREO

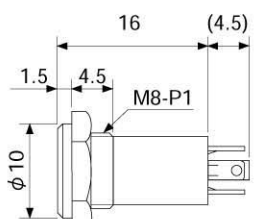

No.MJ-189LP

3-CONDUCTOR CLOSED CIRCUIT
PHONE JACK
Net Weight : 10 gr.

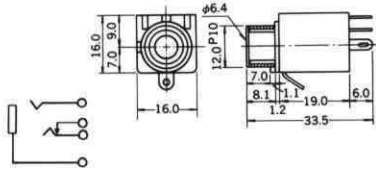

No.MJ-187LP

3-CONDUCTOR OPEN CIRCUIT
PHONE JACK
Net Weight : 9 gr.

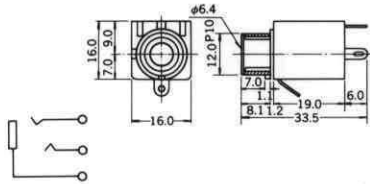

No.MJ-186LP

2-CONDUCTOR CLOSED CIRCUIT
PHONE JACK
Net Weight : 9 gr.

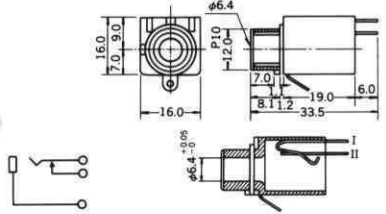

No.MJ-185LP

2-CONDUCTOR OPEN CIRCUIT
PHONE JACK
Net Weight : 9 gr.

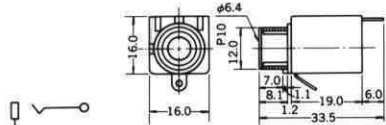

No.MJ-018E

3-CONDUCTOR DOUBLE CLOSED
CIRCUIT PHONE JACK
Net Weight : 13 gr.

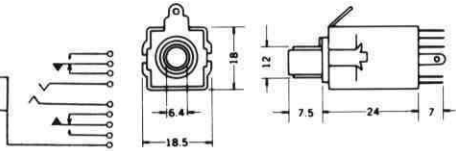

No.MJ-188LP-1~8

PC TYPE 3-CONDUCTOR
CIRCUIT 1/4" PHONE JACK
Net Weight : 11 gr.

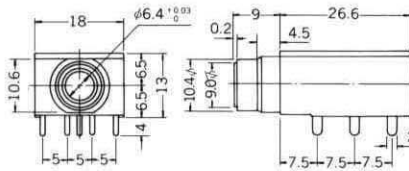

No.MX-616BLB

MONO
Net Weight : 3.5 gr.

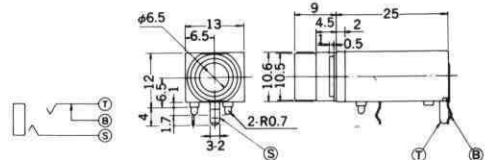

No.MX-616GLB

STEREO
Net Weight : 3.5 gr.

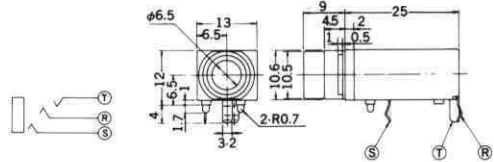

No.MX-617BMB

MONO
Net Weight : 3.5 gr.

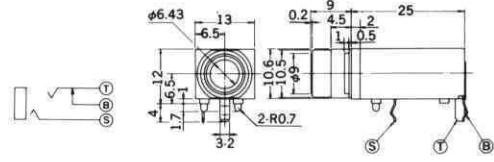

No.MX-617GMB

STEREO
Net Weight : 4 gr.

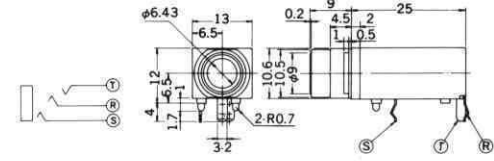

No.MJ-188

3-CONDUCTOR
CIRCUIT PHONE JACK
Net Weight : 12.5 gr.

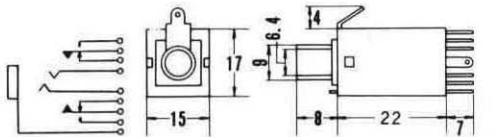

SCHEMATIC

STYLE	Dimensions L	Dimensions H	Circuit Diagrams			
	6.5		MJ-188LP-8	MJ-188LP-6	MJ-188LP-6S	MJ-188LP-5S
MJ-188LP-5						
MJ-188LP-3						
MJ-188LP-4						
MJ-188LP-2S						
MJ-188LP-2						
MJ-188LP-1						

No.MJ-073 STEREO (3.5φ)
No.MJ-164A MONO (3.5φ)

3-CON. MINIATURE INLINE JACK w/cable protector
Net Weight: 3.5 gr

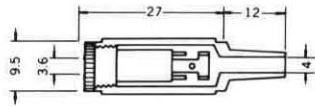

No.MJ-075 STEREO (3.5φ)
No.MJ-164 MONO (3.5φ)

Net Weight: 3 gr

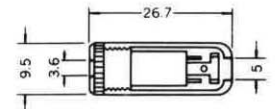

No.MJ-072 STEREO (2.5φ)
No.MJ-165A MONO (2.5φ)

Net Weight: 3 gr

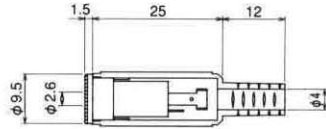

No.MJ-071 STEREO (2.5φ)
No.MJ-165 MONO (2.5φ)

SUB-MINIATURE INLINE JACK
Net Weight: 3 gr

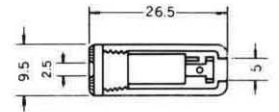

No.MJ-168A MONO(6.3φ)

2-CON. 1/4" PHONE INLINE JACK
Net Weight: 8 gr

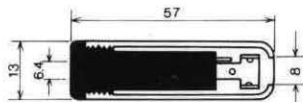

No.MJ-076M STEREO (3.5φ)
No.MJ-166M MONO (3.5φ)

Net Weight: 6 gr

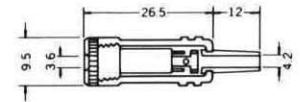

No.MJ-177MS STEREO (6.3φ)
No.MJ-169MS MONO (6.3φ)

Net Weight: 12.5 gr

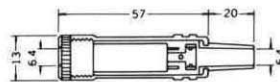

No.MJ-117M STEREO (6.3φ)
No.MJ-116M MONO (6.3φ)

Net Weight: 8 gr

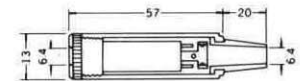

No.MJ-177A STEREO(6.3φ)

3-CON. 1/4" PHONE INLINE JACK w/shielded handle
Net Weight: 12.5 gr

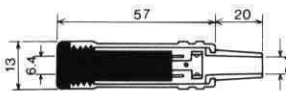

No.MJ-175M STEREO (6.3φ)
No.MJ-168M MONO (6.3φ)

Color: Black,Red,Gray
Net Weight: 8 gr

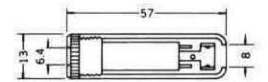

No.MJ-169A MONO(6.3φ)

2-CON. 1/4" PHONE INLINE JACK w/shielded handle
Net Weight: 12.5 gr

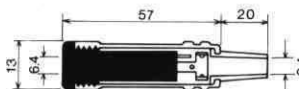

No.MJ-116A MONO(6.3φ)

2-CON. 1/4" PHONE INLINE JACK
Net Weight: 8 gr

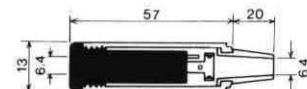

No.MJ-117A STEREO(6.3φ)

3-CON. 1/4" PHONE INLINE JACK
Net Weight: 8 gr

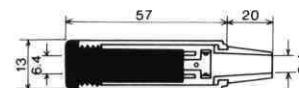

No.MJ-175A STEREO(6.3φ)

3-CON. 1/4" PHONE INLINE JACK
Net Weight: 8 gr

