



IDM260-411S USB Kit

IDM

MOBILE HANDHELD SCANNERS

SICK
Sensor Intelligence.



Ordering information

Type	Part no.
IDM260-411S USB Kit	6080740

Included in delivery: IDM260-411S (1), Connection cable (1)

Other models and accessories → www.sick.com/IDM



Detailed technical data

Features

Application	Industrial application
Scanner design	Cable connection variant
Sensor resolution	1,280 px x 800 px
Light source	LED, Visible, Red, 660 nm
Alignment aid	Laser, Red, 630 nm
Laser class	1 (EN/IEC 60825-1:2014)
Reading distance	30 mm ... 400 mm
Code resolution	≥ 0.07 mm ¹⁾ ≥ 0.13 mm ²⁾

¹⁾ Valid for Code 39.

²⁾ Valid for Data Matrix code.

Mechanics/electronics

Supply voltage	5 V DC, ± 10 %
Current consumption	Operation (vibration deactivated): 395 mA Operation (vibration activated): 420 mA Standby: 220 mA
Housing color	Blue, gray
Enclosure rating	IP65
Weight	208 g, without cable
Dimensions (L x W x H)	104 mm x 76.3 mm x 176 mm
MTBF	100,000 h

Performance

Readable code structures	1D codes, 2D codes, Stacked
Bar code types	Code 39, Code 39 Full ASCII, Code 32, Code 128, GS1-128, Codabar, Code 11, Code 93, GS1 DataBar, Standard and Industrial 2 of 5, Interleaved & Matrix 2 of 5, IATA, UPC / EAN / JAN, UPC / EAN / JAN (with addition), Telepen, MSI/Plessey, UK/Plessey, Australian Post, China Post, German Post, US Planet, US Postnet, British Post, Intelligent Mail, Japan Post, Korea Post, Dutch KIX Post, Posi LAPA 4 State Code

2D code types	Data Matrix, MaxiCode, QR code, Aztec, MicroQR-Code, GS1 QR code, GS1 Data-Matrix
Stacked code types	PDF417, MicroPDF417, Code 49, Code 16K, Composite, Codablock F

Interfaces

USB	✓
Function	Keyboard wedge, COM-Port emulation
Optical indicators	2 LEDs (operational status, good read)
Acoustic indicators	Beeper, can be switched off
Vibration	Yes
Configuration software	IDM Setup Tool

Ambient data

Shock resistance	50 drops from 2 m height on concrete
Ambient operating temperature	-20 °C ... +50 °C
Storage temperature	-40 °C ... +70 °C
Permissible relative humidity	95 %, Non-condensing
Ambient light immunity	100,000 lx

General notes

Note	Not free of paint wetting impairment substances.
-------------	--

Classifications

ECLASS 5.0	27280101
ECLASS 5.1.4	27280101
ECLASS 6.0	27280101
ECLASS 6.2	27280101
ECLASS 7.0	27280101
ECLASS 8.0	27280101
ECLASS 8.1	27280101
ECLASS 9.0	27280101
ECLASS 10.0	27280101
ECLASS 11.0	27280101
ECLASS 12.0	27280101
ETIM 5.0	EC002550
ETIM 6.0	EC002550
ETIM 7.0	EC002550
ETIM 8.0	EC002550
UNSPSC 16.0901	43211701

Connection diagram

PROFINET IO/RT

PROFINET IO/RT

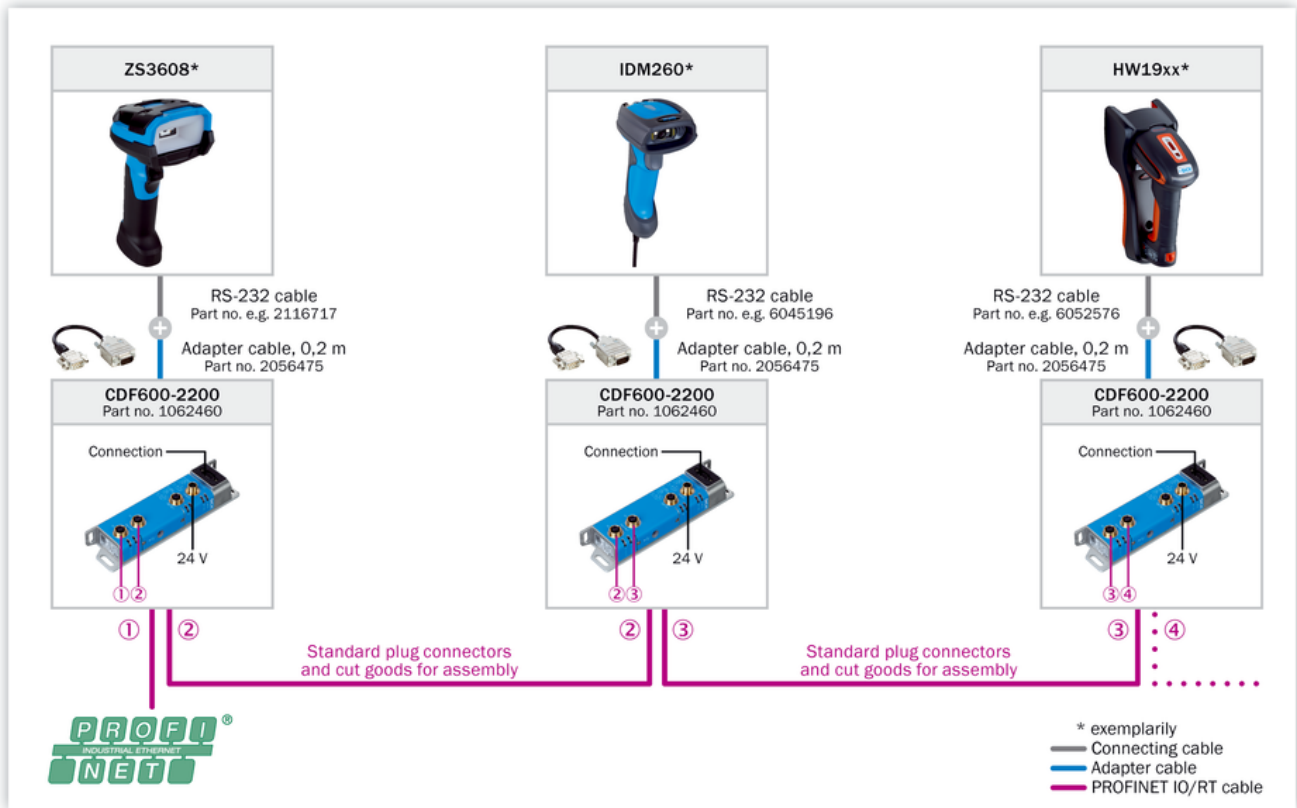

PROFIBUS DP

PROFIBUS DP

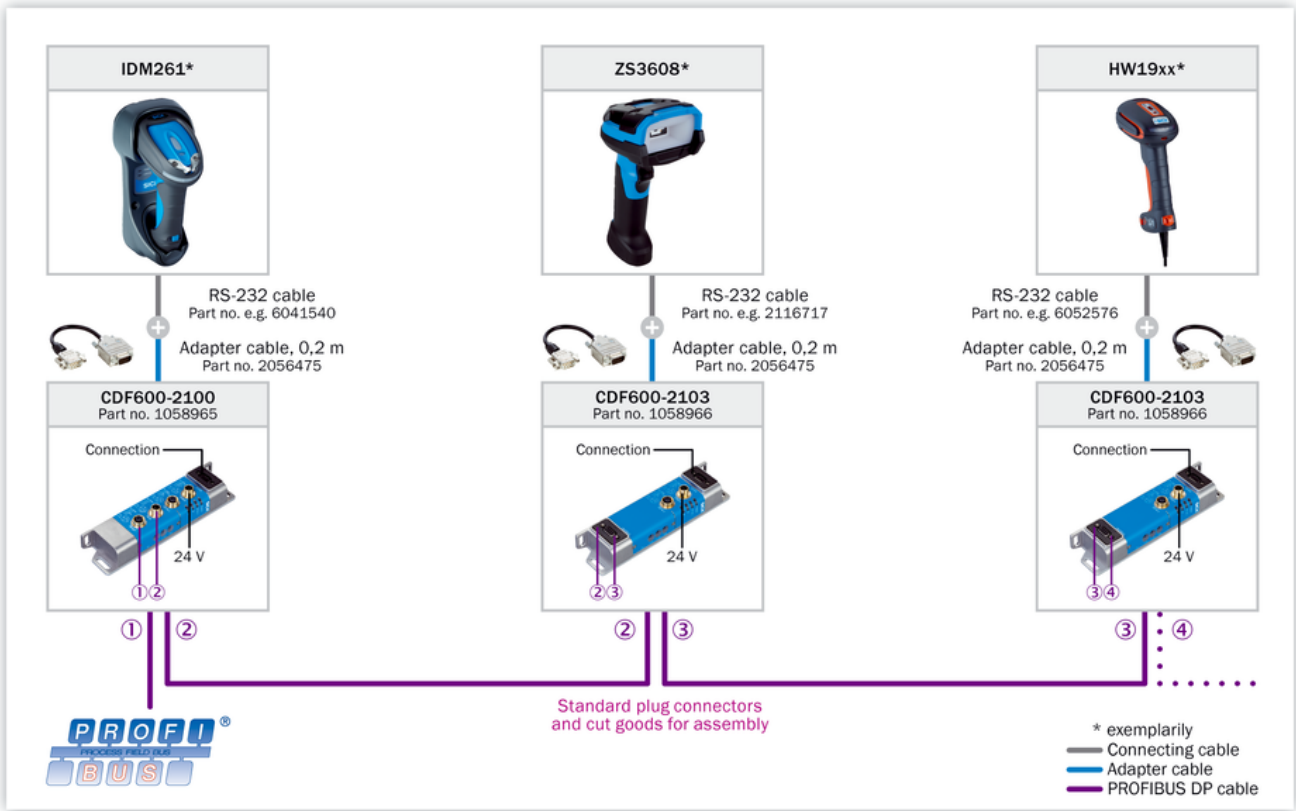

Ethernet TCP/IP

Ethernet TCP/IP

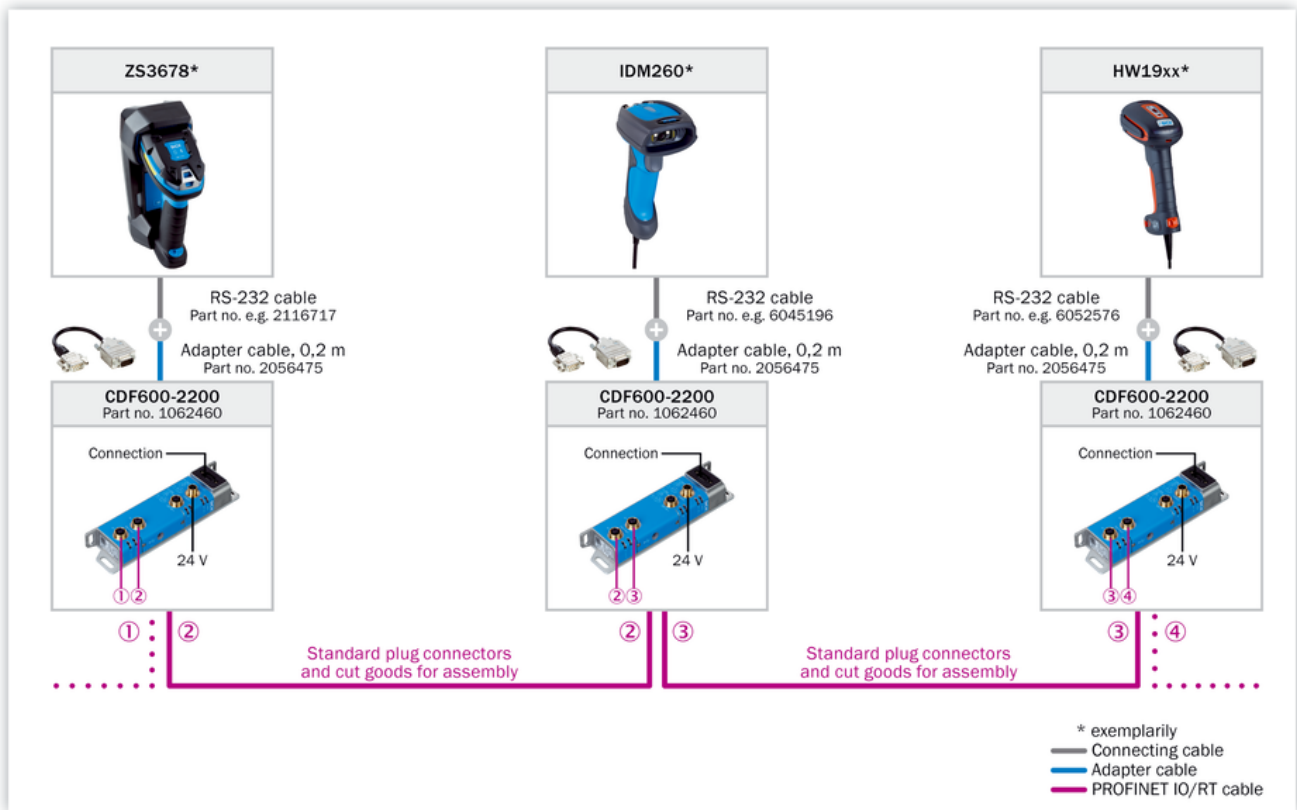

EtherCAT®

EtherCAT®

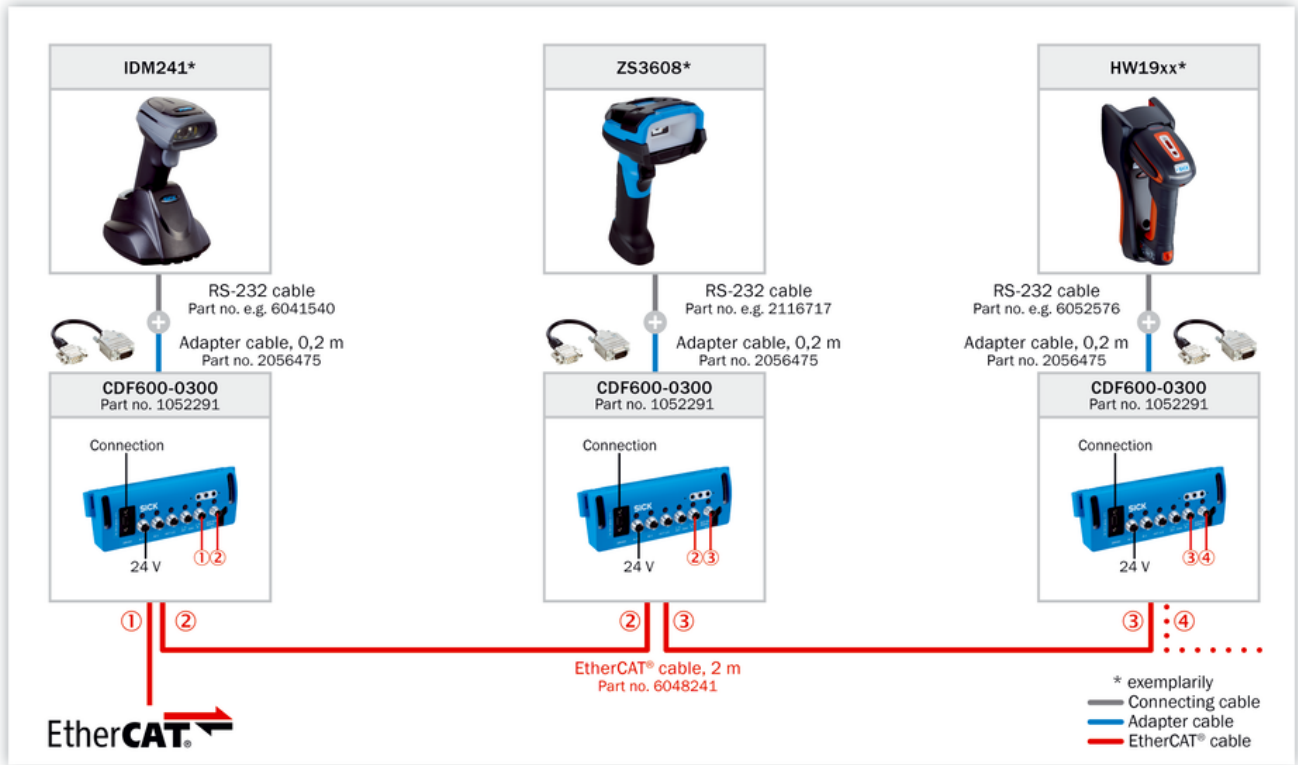

AUX looping

Looping-in via AUX

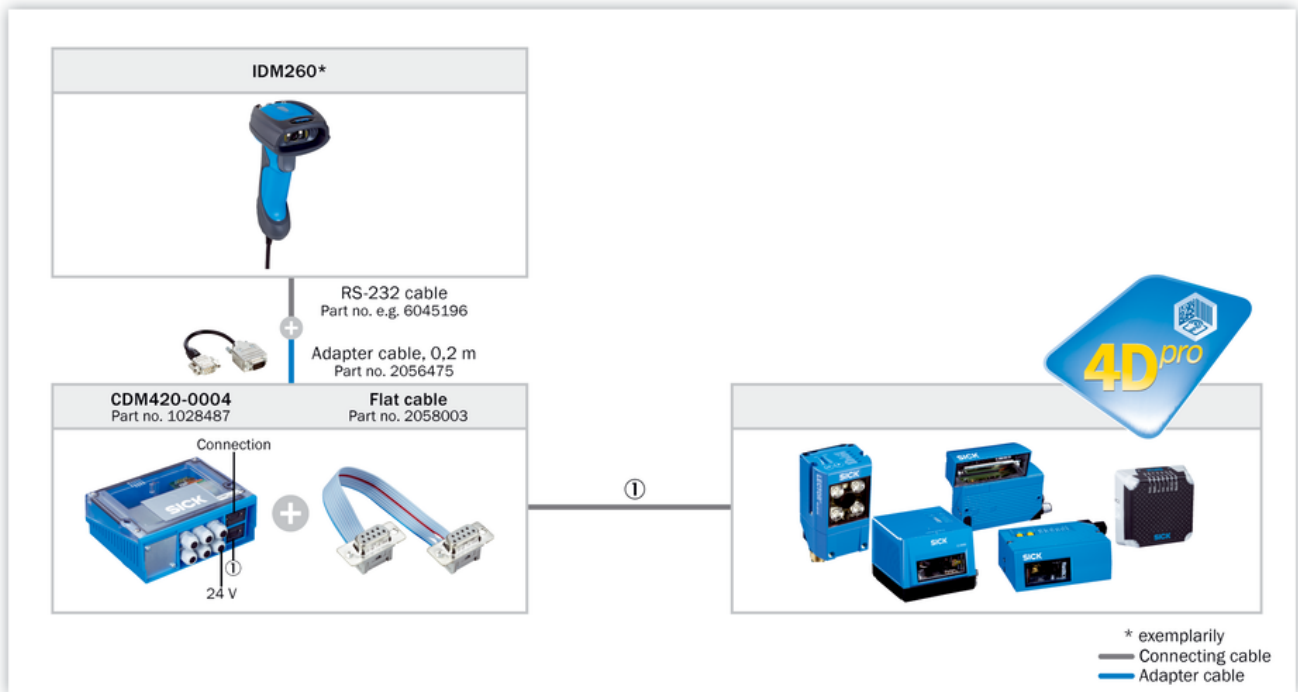

Selection Guide



*1) For EtherNet/IP third party gateway is required from e.g. Control or HMS (requires local sourcing).

Recommended services

Additional services → www.sick.com/IDM

	Type	Part no.
<p>Extended warranty</p> <ul style="list-style-type: none"> • Product area: Identification solutions, machine vision, Detection and ranging solutions, safety camera sensors, Safety laser scanners, Safety radar sensors • Range of services: The services correspond to the scope of the statutory manufacturer warranty (SICK general terms of delivery). • Duration: Five-year warranty from delivery date. 	Extended warranty for a total of five years from delivery date	1680671

SICK AT A GLANCE

SICK is one of the leading manufacturers of intelligent sensors and sensor solutions for industrial applications. A unique range of products and services creates the perfect basis for controlling processes securely and efficiently, protecting individuals from accidents and preventing damage to the environment.

We have extensive experience in a wide range of industries and understand their processes and requirements. With intelligent sensors, we can deliver exactly what our customers need. In application centers in Europe, Asia and North America, system solutions are tested and optimized in accordance with customer specifications. All this makes us a reliable supplier and development partner.

Comprehensive services complete our offering: SICK LifeTime Services provide support throughout the machine life cycle and ensure safety and productivity.

For us, that is “Sensor Intelligence.”

WORLDWIDE PRESENCE:

Contacts and other locations –www.sick.com