

Switching element

46-312.1Z10

Distribution by
Newark



<https://newark.eao.com/p/46-312.1Z10>

Your product:



46-312.1Z10

Switching element

FRONT

Colour: Red

ELECTRICAL CHARACTERISTICS

Switching voltage and switching current:	at AC-15				
	Voltage	24 V	120 V	240 V	600 V
	Current	10 A	6 A	3 A	1,2 A
	at DC-13				
	Voltage	24 V	120 V	240 V	
	Current	5 A	1,1 A	0,55 A	

Insulation voltage: Ui 690V - Uimp 4KV (IEC-EN60947-1)

Pollution degree: 3

Thermal current I_{th}: 10 A (IEC-EN60947-1)

Contacts: 1 NC

MECHANICAL CHARACTERISTIC

Weight: 0.011 kg

Terminal: Screw terminal

Tightening torque: 0.8 ... 1 Nm for screw terminal

Switching system: Slow-make switching element

Mechanical lifetime: 1 Mio. cycles of operation

Contact material: Silver

Operating force: 2 N

AMBIENT CONDITION

Shock resistance: 30g, 18ms (EN-IEC 60068-2-27)
50g, 11ms (EN-IEC 60068-2-27)

Operating temperature: - 25 °C ... + 55 °C

Climate resistance: +25°C-97%RH / +45°C-93%RH (IEC-EN60068-2-30)

IP Protection: IP20

Vibration resistance: 5g f= 2...500Hz (EN-IEC 60068-2-6)

CERTIFICATE

Standards: CSA C22-2, IEC EN 60947-1, IEC EN 60947-5-1, UL508

Approbations: CSA, EAC, UL

Conformities: CE

OTHER

Short Description: Switching element, Slow-make switching element, Silver, 1 NC, Screw terminal

Material: Plastic

Dimension drawings:

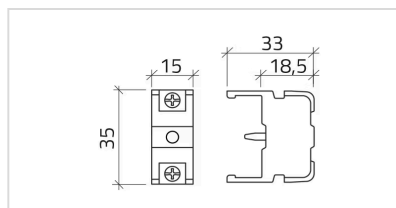

Wiring diagrams:

