

battery type: Alkaline Manganese (Mercury free)
battery size: IEC: LR6; JIS: AM-3; ANSI: 15A; MN1500; AA; Mignon
chemical system: Zn / KOH-H₂O / MnO₂

Conditions

nominal voltage: 1.5 V
open circuit voltage: 1.57...1.65 V new battery
 1.55...1.65 V after 1 year storage at 20°C

capacity rated: 2900 mAh all measurements at 20°C ambient
 discharge at 10mA load; 24hours/day
 End Voltage (EV): 0.8V
 2800 mAh discharge at 43ohms load; 4hours/day
 End Voltage (EV): 0.9V

minimum: 19 h at 10ohms constant resistance discharge
 (for IQC measurement) 24h/d; End Voltage (EV): 0.9V
 46 min at 1000mA constant current discharge
 24h/d; End Voltage (EV): 0.9V

typical service output

Load	10 Ω	1000mA	1000mA	1.5W/0.65W	3.9 Ω	250mA	10 Ω	24 Ω	43 Ω	
Test mode	24h/d	24h/d	10s/m 1h/d	2s/28s 5m/h	1h/d	1h/d	1h/d	15s/m 8h/d	4h/d	
end voltage	0.9V	0.9V	0.9V	1.05V	0.8V	0.9V	0.9V	1.0V	0.9V	
Initial	MAD	19.0 h	46m	470 pulses	87 pulses	7.3h	7.3h	19.2 h	43 .0h	88.0 h
	Normal	19.8 h	57 m	520 pulses	105 pulses	7.7h	7.7h	20.0 h	45.0 h	91.0h
After 1 year	MAD	18.6 h	41 m	390 pulses	75 pulses	7.1h	6.8h	18.5 h	42.0 h	87.0 h
	Normal	19.2h	47 m	460 pulses	93 pulses	7.4h	7.3h	19.2 h	44.0 h	90.0 h

m: minute h: hour d: day

internal resistance: ≤ 0.2 Ω at 1kHz, sine wave measurement
 (new batttery) according to IEC 896-2

shelf life: 7 years under proper storage conditions

leakage resistance

over discharge: no leakage 10ohms continuous discharge for 48h; ta: 20°C; RH: 60±15%
 high temperature: no leakage store 20days at ta: 60°C; RH:90±5%

ambient temperature range:

- 10...50 °C

recommended storage conditions:

5....25 °C ambient temperature
 45...75 % rel. humidity

mechanical specifications

cell dimensions

diameter d1: 14.4 - 0.5 mm
 diameter d2: 5.4 - 0.5 mm
 height h1: 50.4 - 0.5 mm
 height h2: 1.7 - 0.5 mm
 weight: 23 ± 2 g

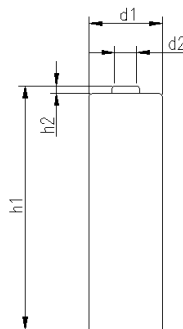

	ANSMANN Specifications for model:	Premium Quality Alkaline Battery AA - size
	data sheet no. / part no.	
	s.n.	701381
	author / date	TG / 10.07.2019