

Technical Information

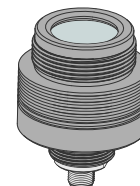

For complete technical information about this product, including installation instructions, application requirements and guidelines, technical specifications, dimensions, and accessories, please refer to the manual at www.bannerengineering.com. Scan the QR code or follow the link below to go to the product series web page, and search for the GS60 Guide Spotlight manual, p/n 238181, in the Downloads. Use of this document assumes familiarity with pertinent industry standards and practices.
<https://www.bannerengineering.com/qr/GS60>



Model Key

Housing	Color	Lens Angle	Control	Connection
GS60	W	L4		Q
60 mm diameter Guide Spotlight	W = White R = Red G = Green B = Blue Y = Yellow I = Infrared UV395 = 395 nm Ultraviolet	Visible and IR models: L4 = ± 4 degree lens UV models: L8 = ± 8 degree lens	Blank = Hi/Low/Off A = Adjustable PWM/Strobe and 1 V to 10 V dimming	Q = Integral 4-pin or 5-pin M12 male quick-disconnect connector ⁽¹⁾

The following caution applies to white LED models and blue LED models:



CAUTION:
Risk Group 2: Possibly hazardous optical radiation emitted from this product.

Do not stare at the operating lamp. May be harmful to the eyes. Risk Group 2 (RG 2) products generally do not pose a realistic optical hazard if aversion responses limit the exposure duration or where lengthy exposures are unrealistic.

- IEC 62471

The following caution applies to ultraviolet models:



CAUTION:
Risk Group 2: UV Emitted from this product.

Eye or skin irritation may result from exposure. Use appropriate shielding and eye protection. Risk Group 2 (RG 2) products generally do not pose a realistic optical hazard if aversion responses limit the exposure duration or where lengthy exposures are unrealistic.

- IEC 62471

The following caution applies to infrared models:



CAUTION:
Risk Group 2: IR Emitted from this product.

Avoid eye exposure. Use appropriate shielding or eye protection. Risk Group 2 (RG 2) products generally do not pose a realistic optical hazard if aversion responses limit the exposure duration or where lengthy exposures are unrealistic.

- IEC 62471

Wiring

Pinout	Pin Number	Wire Color	High/Low/Off Models	1 V to 10 V Analog Dimming and Strobing/PWM Dimming Models
	Pin 1	Brown	12 V DC to 30 V DC	12 V DC to 30 V DC
	Pin 2	White	Not used	NPN PWM/Strobe Input: For maximum intensity, leave the white wire floating, or connect to 12 V DC to 30 V DC. Connecting to DC common causes the LEDs to shut off.
	Pin 3	Blue	DC common	DC common
	Pin 4	Black	Connect to 12 V DC to 30 V DC for 50% maximum intensity. For maximum intensity, leave the black wire floating or connect to common.	PNP PWM/Strobe Input: For maximum intensity, leave the black wire floating, or connect to DC common. Connecting to 12 V DC to 30 V DC causes the LEDs to shut off.
	Pin 5	Gray	Not present	1 V DC to 10 V DC Analog Dimming NOTE: Connect to 12 V DC to 30 V DC for maximum intensity, or apply 1 V to 10 V for analog dimming of 10% to 100% intensity.

Specifications

Refer to the manual for complete information.

Supply Voltage

12 V DC to 30 V DC

Supply Protection Circuitry

Protected against reverse polarity and transient voltages

Mounting

30 × 1.5 mm thread base mount

Construction

Black anodized aluminum housing
 Polycarbonate window
 Nickel-plated quick-disconnect connector
 Black anodized aluminum mounting nut

Connections

Integral 4-pin or 5-pin M12 male quick-disconnect connector

Operating Temperature

-40 °C to +50 °C (-40 °F to +122 °F)

Storage Temperature

-40 °C to +70 °C (-40 °F to +158 °F)

Environmental Rating

IP66, IP67

⁽¹⁾ Hi/Low/Off models have 4-pin quick-disconnect connectors. Adjustable models have 5-pin quick-disconnect connectors.

Certifications



Required Overcurrent Protection



WARNING: Electrical connections must be made by qualified personnel in accordance with local and national electrical codes and regulations.

Overcurrent protection is required to be provided by end product application per the supplied table.
 Overcurrent protection may be provided with external fusing or via Current Limiting, Class 2 Power Supply.
 Supply wiring leads < 24 AWG shall not be spliced.
 For additional product support, go to www.bannerengineering.com.

Supply Wiring (AWG)	Required Overcurrent Protection (A)	Supply Wiring (AWG)	Required Overcurrent Protection (A)
20	5.0	26	1.0
22	3.0	28	0.8
24	1.0	30	0.5

Supply Current

Color	Max. Current Draw (A) at 12 V DC	Typical Current Draw (A)			
		12 V DC	24 V DC	30 V DC	50% Intensity at 24 V DC
Daylight White	0.45	0.34	0.18	0.15	0.08
Red	0.45	0.33	0.15	0.12	0.06
Green	0.45	0.405	0.18	0.14	0.06
Blue	0.45	0.41	0.18	0.14	0.065
Yellow	0.45	0.36	0.18	0.145	0.07
IR	0.45	0.185	0.09	0.07	0.045
UV	0.45	0.3	0.15	0.13	0.075

Key Accessories

Refer to the manual for additional accessories and complete information.

MQDC-406

Straight 4-pin threaded M12 cordset—single ended

SMBAMS30P

30 mm flat bracket with curved slot for versatile orientation

SMB30A

30 mm right-angle bracket with curved slot for versatile orientation

ACC-GS60 M48 Front Mount

M48X2 mounting knurl nut for the GS60

Banner Engineering Corp Limited Warranty

Banner Engineering Corp. warrants its products to be free from defects in material and workmanship for one year following the date of shipment. Banner Engineering Corp. will repair or replace, free of charge, any product of its manufacture which, at the time it is returned to the factory, is found to have been defective during the warranty period. This warranty does not cover damage or liability for misuse, abuse, or the improper application or installation of the Banner product.

THIS LIMITED WARRANTY IS EXCLUSIVE AND IN LIEU OF ALL OTHER WARRANTIES WHETHER EXPRESS OR IMPLIED (INCLUDING, WITHOUT LIMITATION, ANY WARRANTY OF MERCHANTABILITY OR FITNESS FOR A PARTICULAR PURPOSE), AND WHETHER ARISING UNDER COURSE OF PERFORMANCE, COURSE OF DEALING OR TRADE USAGE.

This Warranty is exclusive and limited to repair or, at the discretion of Banner Engineering Corp., replacement. **IN NO EVENT SHALL BANNER ENGINEERING CORP. BE LIABLE TO BUYER OR ANY OTHER PERSON OR ENTITY FOR ANY EXTRA COSTS, EXPENSES, LOSSES, LOSS OF PROFITS, OR ANY INCIDENTAL, CONSEQUENTIAL OR SPECIAL DAMAGES RESULTING FROM ANY PRODUCT DEFECT OR FROM THE USE OR INABILITY TO USE THE PRODUCT, WHETHER ARISING IN CONTRACT OR WARRANTY, STATUTE, TORT, STRICT LIABILITY, NEGLIGENCE, OR OTHERWISE.**

Banner Engineering Corp. reserves the right to change, modify or improve the design of the product without assuming any obligations or liabilities relating to any product previously manufactured by Banner Engineering Corp. Any misuse, abuse, or improper application or installation of this product or use of the product for personal protection applications when the product is identified as not intended for such purposes will void the product warranty. Any modifications to this product without prior express approval by Banner Engineering Corp will void the product warranties. All specifications published in this document are subject to change; Banner reserves the right to modify product specifications or update documentation at any time. Specifications and product information in English supersede that which is provided in any other language. For the most recent version of any documentation, refer to: www.bannerengineering.com.

For patent information, see www.bannerengineering.com/patents.

Document title: GS60 Guide Spotlight Datasheet Part number: 238180 Revision: C Original Instructions © Banner Engineering Corp. All rights reserved.	 238180
--	---