

REVISIONS				
REV	DATE	DESCRIPTION	BY	APP'D
A1	17SEP2024	ADDED TE LOGO, PN & YYWWD	TR	RCC

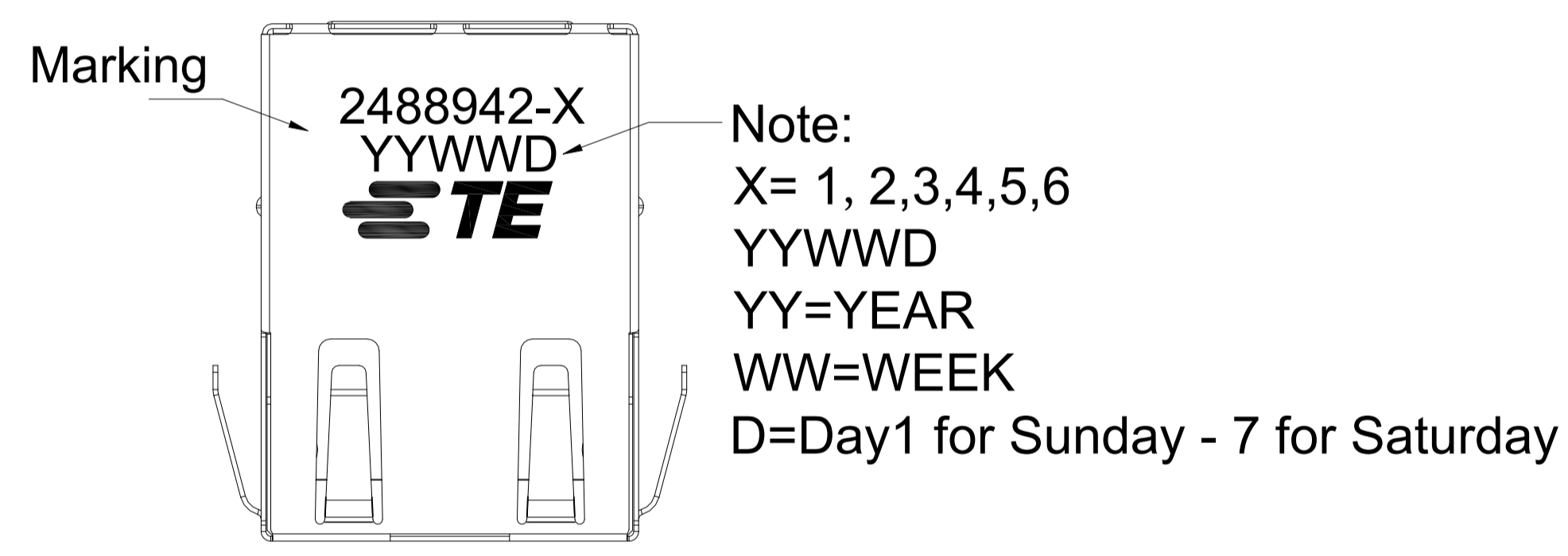

NOTES

- HOUSING MATERIAL: GLASS FILLED PA46(BLACK) UL94V-0(ROHS)
- CONTACT: PHOSPHOR BRONZE, 50 MICROINCHES MIN. OVERALL DUCTILE NICKEL UNDERPLATE WITH (REFER P/N TABLE) MICROINCHES GOLD AT MATING INTERFACE
- SHIELD: 0.2mm THICKNESS WITH BRASS.
- JACK CAVITY CONFORMS TO FCC RULES AND REGULATIONS PART 68 SUBPART F
- THE PART IS RECOMMENDED FOR WAVE SOLDERING PROCESS PEAK SOLDERING TEMPERATURE IS 260°C MAX, 10 SECS MAX.
- OPERATING TEMPERATURE: -40°C TO +85°C.
 STORAGE TEMPERATURE: -40°C TO +85°C.

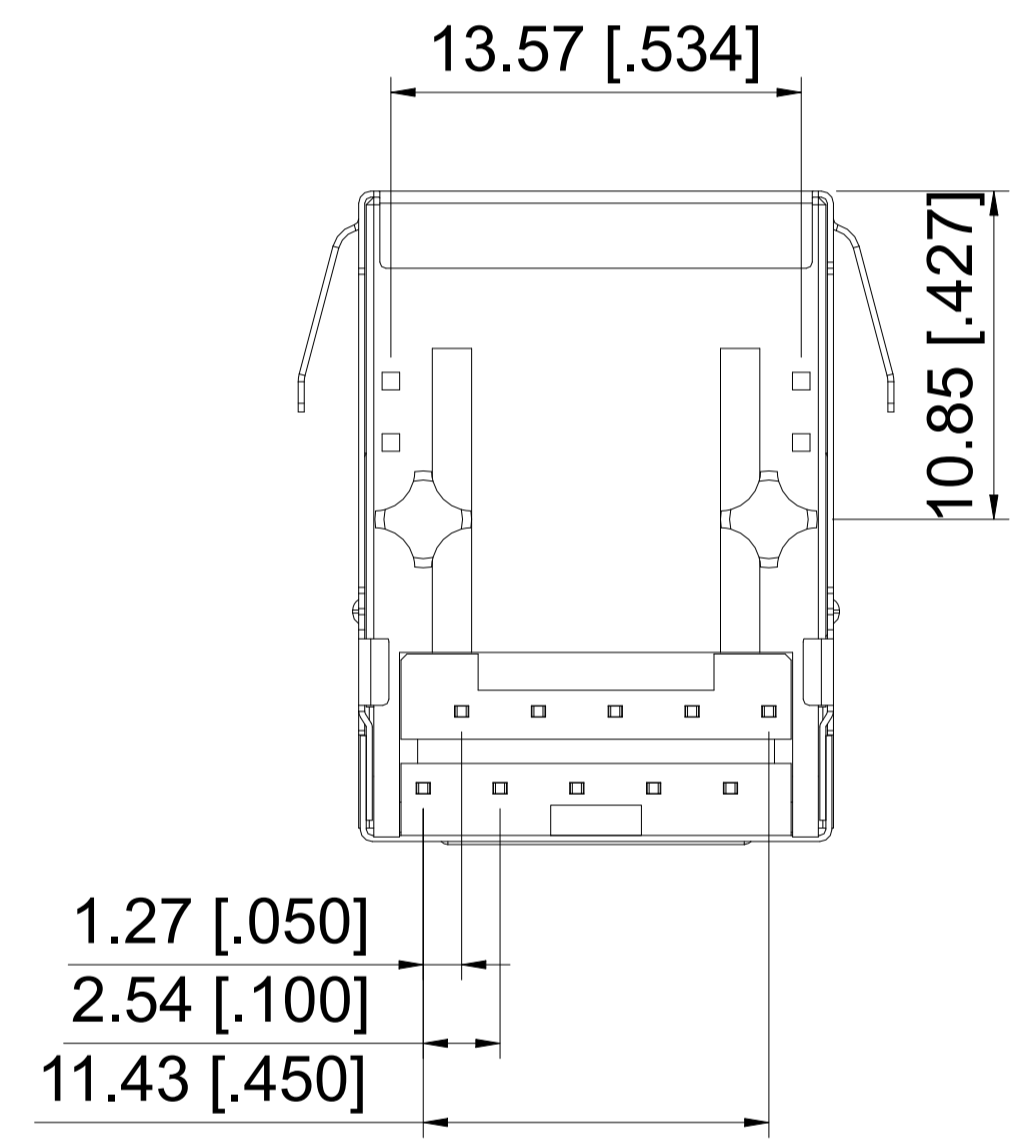
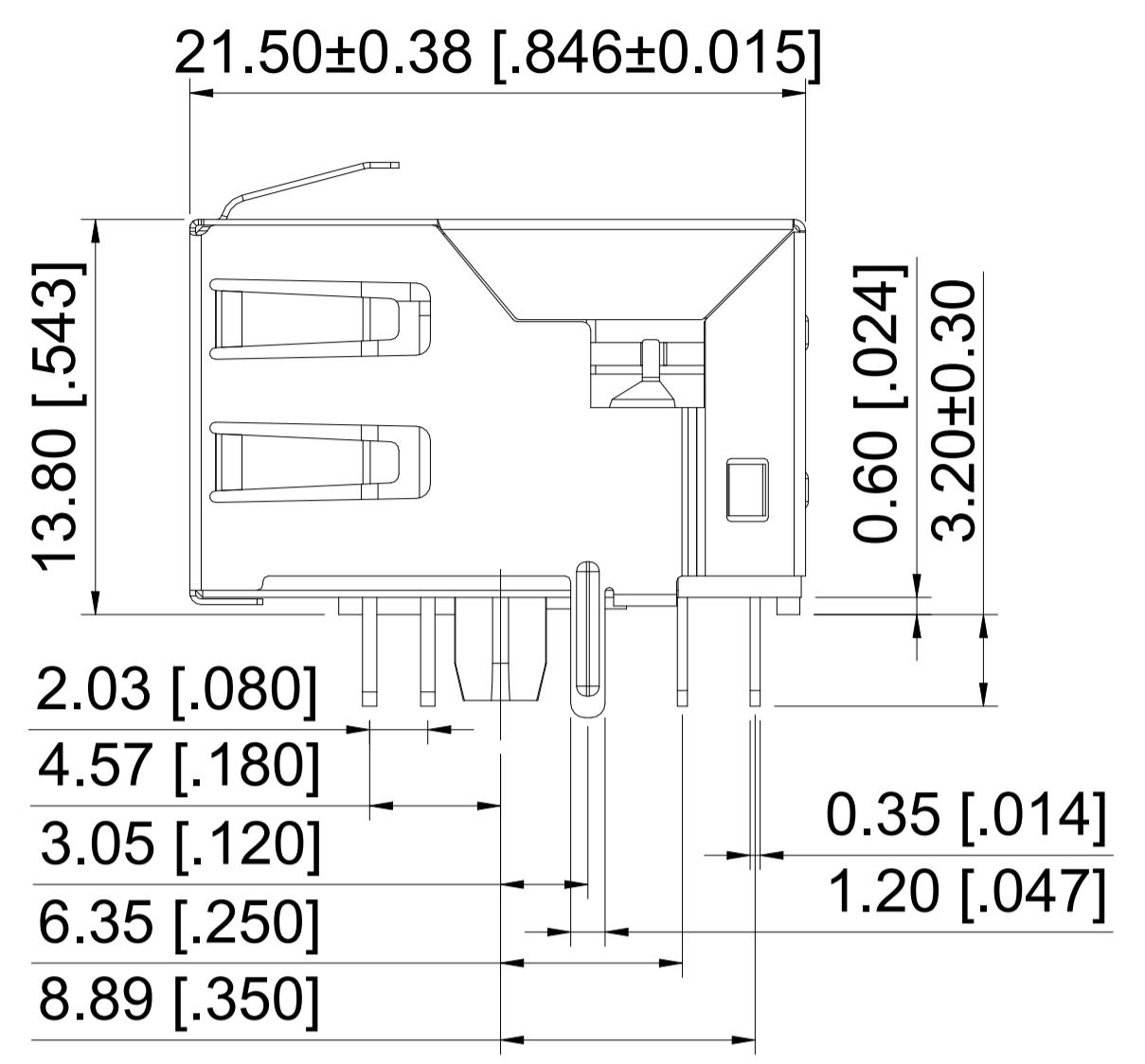
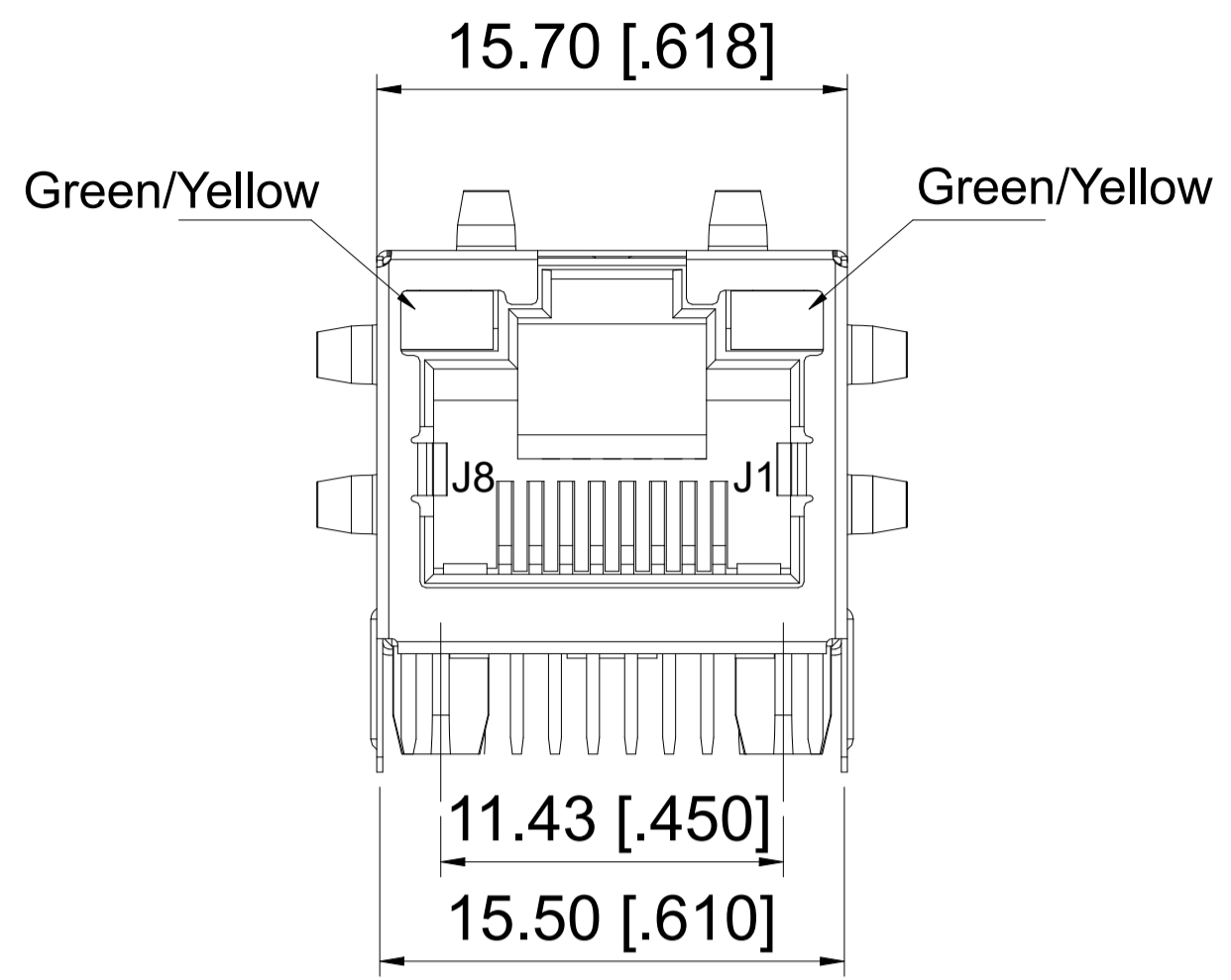
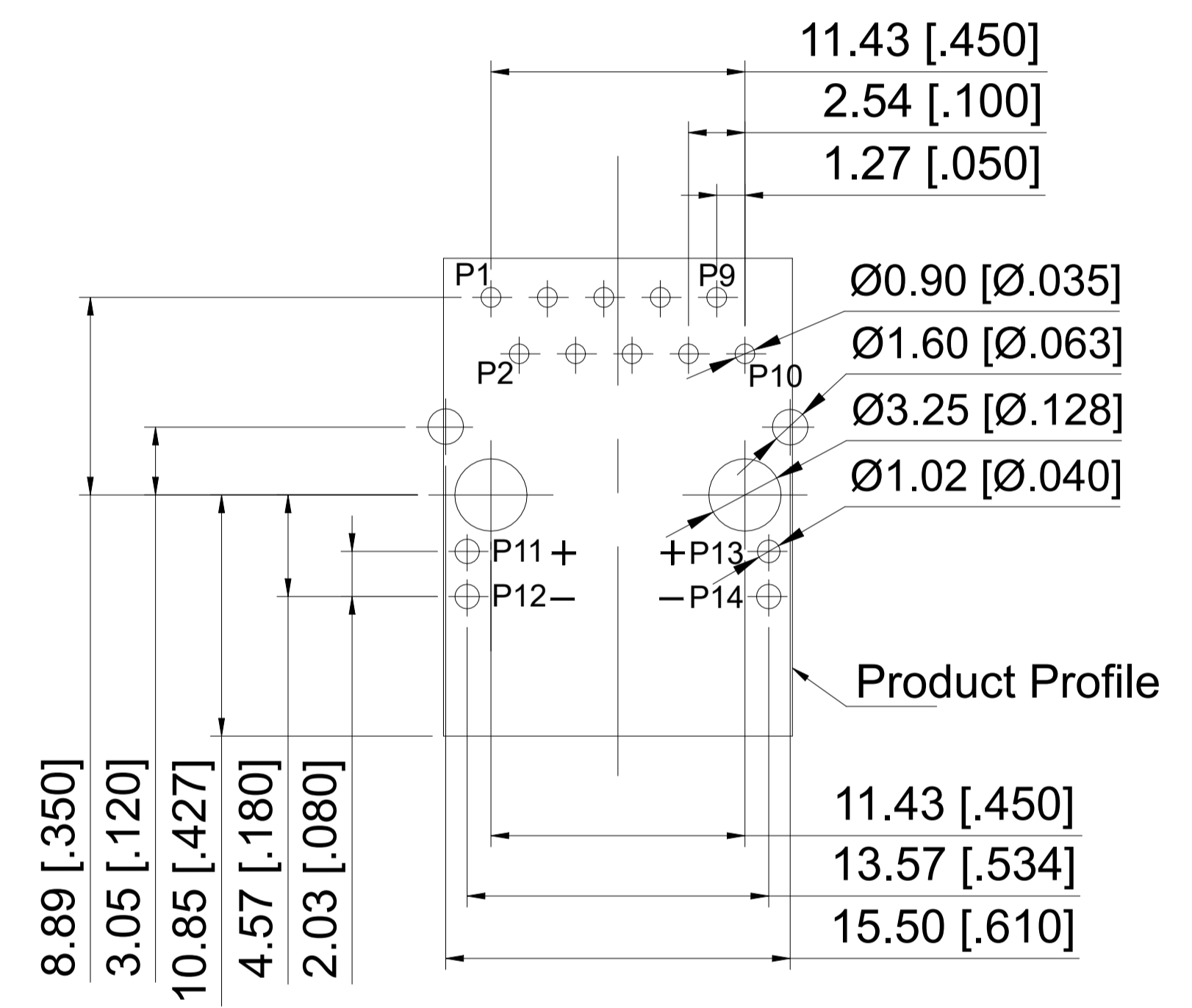

RECOMMENDED P.C.B LAYOUT TOP VIEW (COMPONENT SIDE)
 Dimensions Tolerance: All PCB LAYOUT Tolerances: ±0.05 [.002]

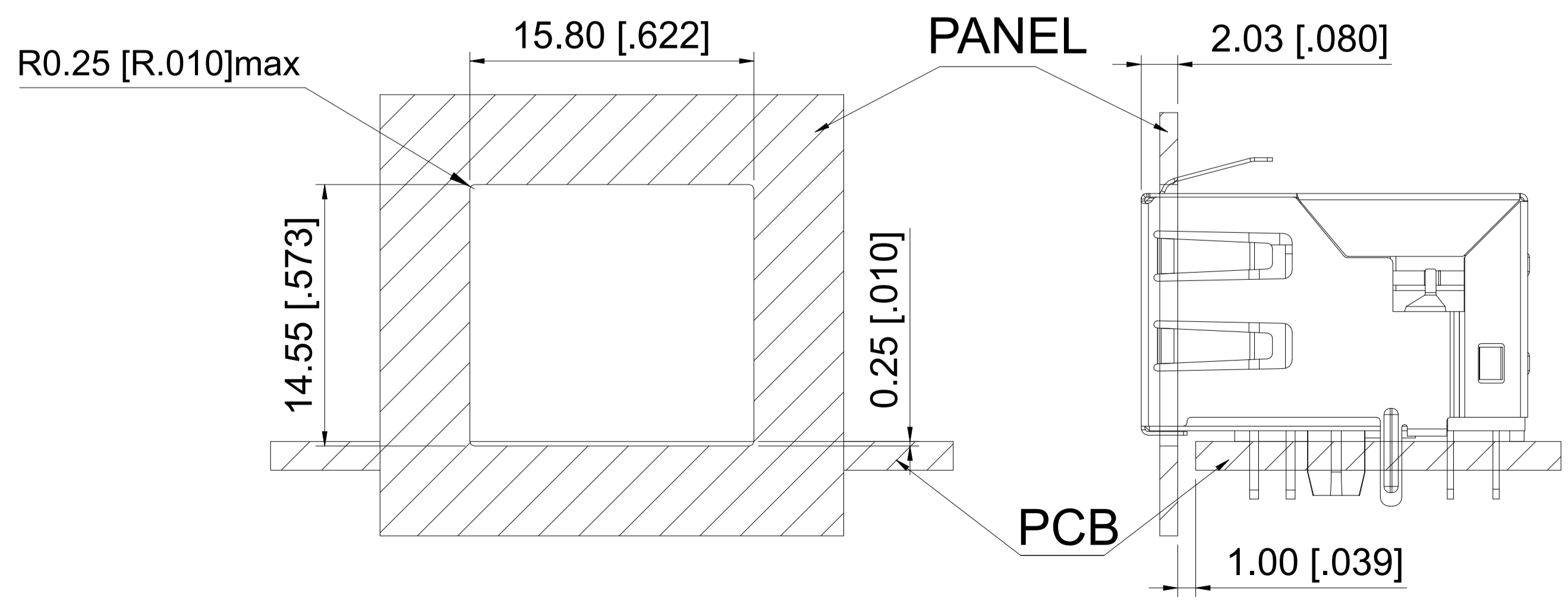

GOLD PLATING THICKNESS	PART NUMBER
GF	2488942-6
0.0762 µm [3µ"]	2488942-5
0.1524 µm [6µ"]	2488942-4
0.381 µm [15µ"]	2488942-3
0.762 µm [30µ"]	2488942-2
1.27 µm [50µ"]	2488942-1

THIS DRAWING IS A CONTROLLED DOCUMENT.

DIMENSIONS: mm [NCHES]	TOLERANCES UNLESS OTHERWISE SPECIFIED:	DWG: RAMESH KIVADER 11JUN2024	CHK: RAMESH KIVADER 11JUN2024	NAME: RAMESH KIVADER
0. PLC ± 0.10	1. PLC ± 0.25	APPROD: EPS SATHISH 11JUN 2024	PRODUCT SPEC: 108-161443	APPLICATION SPEC: 114-161076
2. PLC ± 0.25	3. PLC ± 0.25	SIZE: A1	CAGE CODE: 00779	DRAWING NO: C=2488942
4. PLC ± 0.25	ANGLES ± 2	WEIGHT: 0	CUSTOMER DRAWING	SCALE: 1:1

TE Connectivity
 RJ45 1X1 Tab_Down/Through Hole 10G Base-T W/LED
 SHEET 1 OF 2

REVISIONS				
REV	DATE	DESCRIPTION	BY	APP'D
-	-	SEE SHEET 1	-	-

Schematic

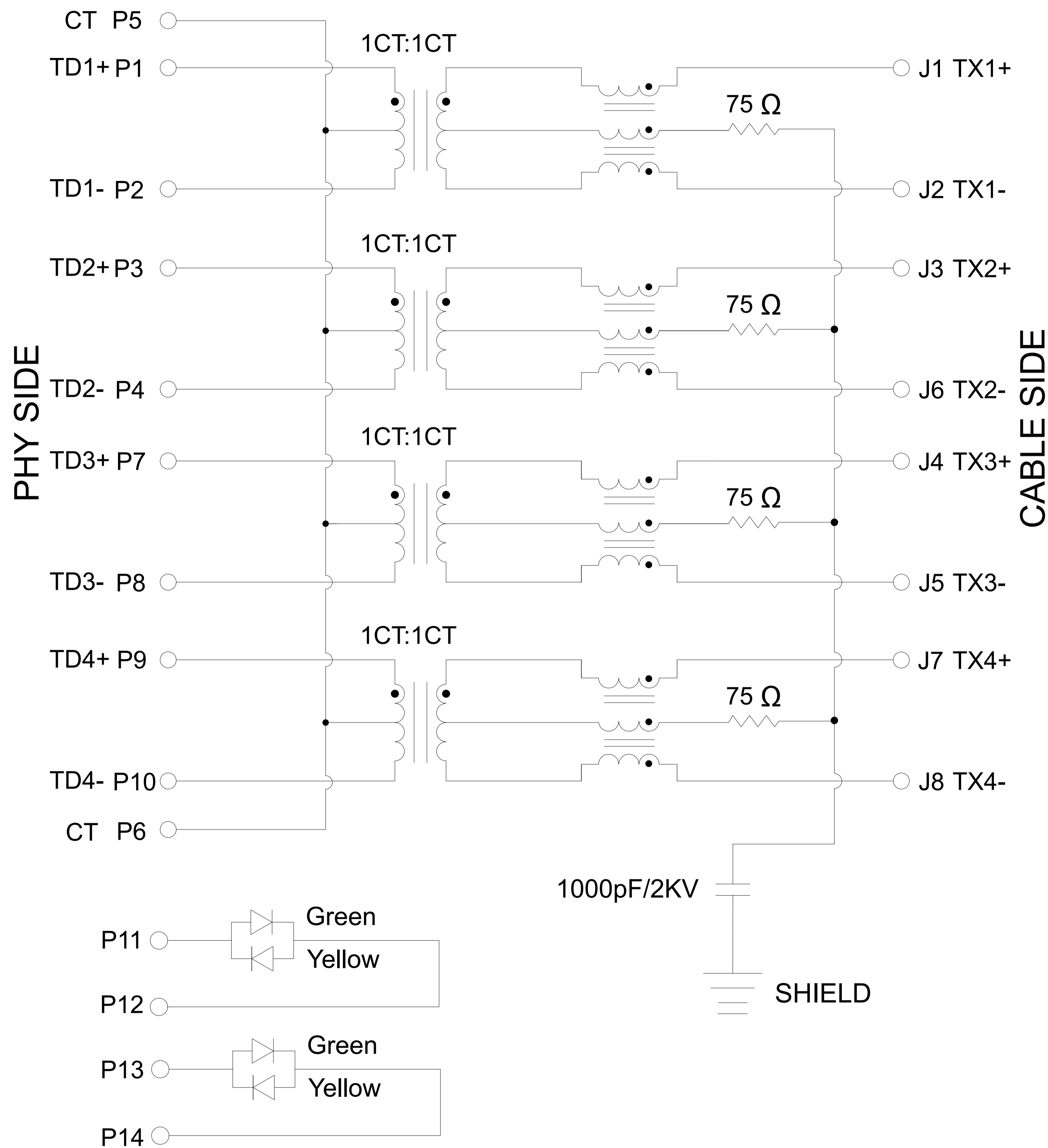

PARAMETER	SPECIFICATIONS
OPERATING TEMPERATURE	-40°C To +85°C
TURNS RATIO	1:1±3%
INDUCTANCE(OCL)	350uH MIN@100KHz/100mV With 8mA DC Bias
INSERTION LOSS	-1.0dB MAX@0.3MHz-100MHz;
RETURN LOSS (Z out=100 OHM)	-18dB MIN@1MHz-30MHz; -16dB MIN@30MHz-60MHz; -12dB MIN@60MHz-80MHz; -10dB MIN@80MHz-100MHz;
CROSSTALK (ADJACENT CHANNELS)	-30dB MIN@1MHz-100MHz;
COMMON MODE REJECTION RATIO	-30dB MIN@1MHz-100MHz;
HI-POT	2250 VDC@60 SECONDS

LED SPECIFICATION			
STANDARD LED	WAVELENGTH	Farward V(max)	TYP
GREEN	570nm	2.4V	2.2V
YELLOW	590nm	2.5V	2.1V

*WITH A FORWARD CURRENT OF 20mA

THIS DRAWING IS A CONTROLLED DOCUMENT.		DIM: RAMESH_KIVADER 11JUN2024 CHK: RAMESH_KIVADER 11JUN2024 APVD: PS_SATHISH 11JUN 2024 NAME:		TE Connectivity	
DIMENSIONS: mm [INCHES]		TOLERANCES UNLESS OTHERWISE SPECIFIED: 0. PLC ± 0.10 1. PLC ± 0.25 2. PLC ± 0.25 3. PLC ± 0.25 4. PLC ± 0.25 ANGLES ± 2°		PRODUCT SPEC: 108-161443 APPLICATION SPEC: 114-161076	
MATERIAL: - FINISH: -		WEIGHT: -		SIZE: A1 CAGE CODE: 00779 DRAWING NO: 2488942 RESTRICTED TO: -	
CUSTOMER DRAWING		SCALE: 1:1		SHEET 2 OF 2 REV: A1	