

# 3900 Splashproof Metal Lever Switches 16A 250Vac



16(4)A 250Vac T85 (3900 & 3950)  
 10(4)A 250Vac T85 (All other circuits)  
 UL CSA 20A 125/277Vac (ON-OFF Circuits)  
 UL CSA 16A 125/277Vac (Other Circuits)  
 UL CSA 7A 72Vdc, 14A 36Vdc  
 UL 250Vac 1hp, 125Vac 1/2hp  
 UL 85°C, file E45221, CSA file LR10990

Inrush rating - Contact factory for details

Approvals and ratings vary with function  
 3mm contact gap except where marked  $\mu$   
 Integral O-ring neck seal  
 Technical data on pages 4 & 5

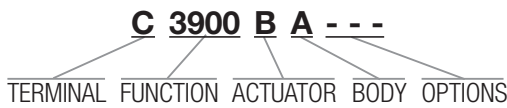

TERMINAL	FUNCTION	ACTUATOR
<b>C</b>  6.3 x 0.8	<b>Single pole</b>  <b>3900</b>  ON - OFF <b>3901</b>  ON - OFF (momentary ON) <b>3902</b>  ON - OFF (momentary OFF) <b>3910</b>  ON - ON <b>3911</b>  ON - ON (momentary 1 side) <b>3920</b>  ON - OFF - ON $\mu$ <b>3921</b>  ON - OFF - ON $\mu$ (momentary 1 side) <b>3922</b>  ON - OFF - ON $\mu$ (momentary 2 sides)	<b>Double pole</b>  <b>3950</b>  <b>3951</b>  <b>3952</b>  <b>3960</b>  <b>3961</b>  <b>3970</b>  <b>3971</b>  <b>3972</b> 
<b>S</b>  Screw & clamp available for On - Off switches only		<b>B</b>  17.5 Finish is nickel plate
<b>T</b>  03.1 Solder		



C3900BA ---



C3920BA ---



**Guard R17-10**

Anti-rotation tab can be specified for guard fitted in On or Off position



C3950BB ---



C3972BB ---

**BODY**

**A**  
Without terminal barrier  
Single pole

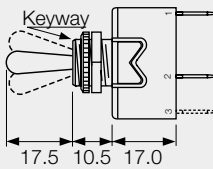

**B**  
With terminal barrier  
Double pole only

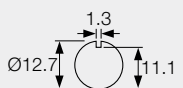
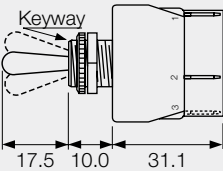

Panel hole (all types)

**OPTIONS**

**Neck Seal M539**

Actuator is visible



**Cover M1080**



Covers have internal nylon nuts

**Fixing nuts**

Nickel plated brass are supplied



Hex Back nut



Knurled Front nut

Panel thickness 4.0 with backnut

**DIMENSIONS** (mm) \* Indicates ON position (for On - Off switches)

**Single Pole**

(C terminals shown)

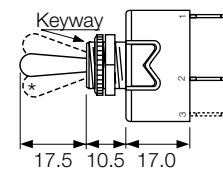
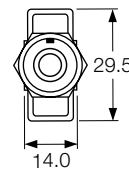

Optional  
P232 plate  
SP or DP

**Double Pole**

(C terminals shown)

