

Features

- ◆ Rugged, compact metal case
- ◆ Easy chassis mount
- ◆ Screw terminal adaptor available for easy connection
- ◆ Ultra wide 4:1 input voltage range
- ◆ Full load operation up to 60°C with convection cooling
- ◆ Soft start
- ◆ Reverse input voltage protection
- ◆ Input protection filter
- ◆ 3-year product warranty

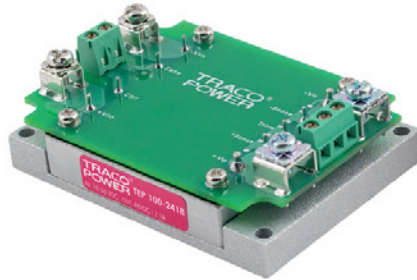

(Models pictured with chassis mount adaptor and optional heatsink)

The TEP-75WI Series is a family of isolated high performance dc-dc converter modules with ultra-wide 4:1 input voltage ranges which come in a rugged, sealed metal case.

These converters are suitable for a wide range of applications, but the product is designed particularly also for industrial applications where often no PCB mounting is possible but the module has to be mounted on a chassis. Four threaded M3 inserts in the module makes chassis mount or attachment of a heatsink for optimal thermal management very simple.

For easy connection there is also a unique adaptor available with screw terminals. A very high efficiency allows an operating temperature up to +60°C with natural convection cooling without power derating. Further features include output voltage trimming, Remote On/Off and under voltage lockout. The very wide input voltage range and reverse input voltage protection make these converters also an interesting solution for battery operated systems.

Models

Order code*	Input voltage	Output voltage	Output current max.	Efficiency typ.
TEP 75-2411WI	9 – 36 VDC (24 VDC nominal)	5.0 VDC	15.0 A	88 %
TEP 75-2412WI		12 VDC	6.3 A	88 %
TEP 75-2413WI		15 VDC	5.0 A	88 %
TEP 75-2415WI		24 VDC	3.2 A	87 %
TEP 75-2416WI		28 VDC	2.7 A	87 %
TEP 75-2418WI		48 VDC	1.6 A	87 %
TEP 75-4811WI	18 – 75 VDC (48 VDC nominal)	5.0 VDC	15 A	90 %
TEP 75-4812WI		12 VDC	6.3 A	89 %
TEP 75-4813WI		15 VDC	5.0 A	89 %
TEP 75-4815WI		24 VDC	3.2 A	87 %
TEP 75-4816WI		28 VDC	2.7 A	87 %
TEP 75-4818WI		48 VDC	1.6 A	87 %

* – add suffix **-CM**, **-CMF** for models with chassis mount adaptor, see last page.

– add suffix **-N** for negative remote control, see page 3 -> Remote On/Off

Input Specifications

Input current at no load	24 Vin; 5 – 15 VDC models: 185 mA typ. 24 Vin; 24 – 48 VDC models: 85 mA typ. 48 Vin; 5 – 15 VDC models: 90 mA typ. 48 Vin; 24 – 48 VDC models: 50 mA typ.
Input current at full load	24 Vin models: 3600 mA typ. (see Note 1) 48 Vin models: 1800 mA typ.
Start-up voltage / under voltage shut down	24 Vin models: 8.5 VDC / 7.5 VDC typ. 48 Vin models: 17.5 VDC / 16 VDC typ.
Surge voltage (100 msec. max.)	24 Vin models: 50 V max. 48 Vin models: 100 V max.
Conducted noise	EN 55022 level A, FCC part 15, level A (chassis mount option –CFM required)
ESD (electrostatic discharge)	EN 61000-4-2, air ±8 kV, contact ±6 kV, perf. criteria A
Radiated immunity	EN 61000-4-3, 10 V/m, perf. criteria A
Fast transient / Surge	EN 61000-4-4, ±2 kV, perf. criteria A EN 61000-4-5, ±1 kV perf. criteria A With external input capacitor e.g. Nippon chemi-con KY 200 µF, 100 V, ESR 48 mOhm or with chassis mount option –CFM
Conducted immunity	EN 61000-4-6, 10 Vrms, perf. criteria A
Reverse voltage protection	parallel diode
Recommended input fuse (slow blow)	24 Vin models: 10 A 48 Vin models: 5 A

Output Specifications

Voltage set accuracy	±1 %
Output voltage adjustment	+10 % / –20 % by external resistor see application note: www.tracopower.com/products/tep75wi-application.pdf
Regulation	– Input variation Vin min. to Vin max. 0.2 % max. – Load variation (0 – 100 %) 5 – 15 VDC models: 0.3 % max. 24 – 48 VDC models: 0.3 % max.
Temperature coefficient	±0.02 %/K
Minimum load	not required
Remote sense	10 % max. of Vout nom. (trim up value to subtract)
Ripple and noise (20 MHz Bandwidth)	5 VDC models: 75 mVpk-pk max. 12 & 15 VDC models: 100 mVpk-pk max. 24 & 28 VDC models: 200 mVpk-pk max. 48 VDC models: 300 mVpk-pk max.
Start up time (nominal Vin and constant resistive load)	25 ms typ. (at power On or remote On)
Transient response (25 % load step change)	200 µs typ.
Output current limitation	at 110 -140 % of Iout max.
Over voltage protection	at 115 -130 % of Vout nom.
Short circuit protection	indefinite, automatic recovery.

Note 1: For operation at low input voltage an input capacitor 4.7µF/50V X7R MLCC or 68µF/100V, 110mOhm Nippon chemi-con KY series is recommended for a reliable supply of the pulse current. Capacitor is already include with chassis mount option –CM and –CFM

Output Specifications

Capacitive load	5 VDC models:	30'000 μ F max.
	12 VDC models:	5'250 μ F max.
	15 VDC models:	3'330 μ F max.
	24 VDC models:	1'330 μ F max.
	28 VDC models:	960 μ F max.
	48 VDC models:	330 μ F max.

General Specifications

Temperature ranges	- Operating	-40°C to +75°C
	- Case temperature	+105°C max.
	- Storage	-55°C to +125°C
Thermal impedance	- without Heatsink	6.7 °C/W
	- with Heatsink	4.7 °C/W
Derating		see derating graphs page 4
Over temperature protection		at 115°C
Thermal shock		acc. MIL-STD-810F
Humidity (non condensing)		95 % rel H max.
Reliability, calculated MTBF (MIL-HDBK-217F, @ 25°C, ground benign)		75'000 h
Isolation voltage (60sec.)	- Input/Output	2'250 VDC (basic insulation)
	- Input/Case	1'500 VDC
Isolation capacity	- Input/Output	2500 pF max.
Isolation resistance	- Input/Output (500 VDC)	>1 GOhm min.
Switching frequency		300 kHz typ. (puls width modulation)
Safety standards		UL 60950-1 , IEC 60950-1, EN 60950-1
Safety approvals (pending)		UL 60950-1, CB- test report
Remote On/Off	- positive logic (standard)	- On: 3 to 12 VDC or open circuit
		- Off: 0 to 1.2 VDC or short circuit pin 1 and 3
	- negative logic (option -N)	- On: 0 to 1.2 VDC or short circuit pin 1 and 3
		- Off: 3 to 12 VDC or open circuit
	- Off idle current:	3 mA
Environmental compliance	- Reach	www.tracopower.com/products/tep75wi-reach.pdf
	- RoHS	RoHS directive 2002/95/EC
Application notes		www.tracopower.com/products/tep75wi-application.pdf

All specifications valid at nominal input voltage, full load and +25°C after warm-up time unless otherwise stated.

Output Power Derating

Models with heatsink

Models without heatsink

24 Vin models: Output 5-15 VDC

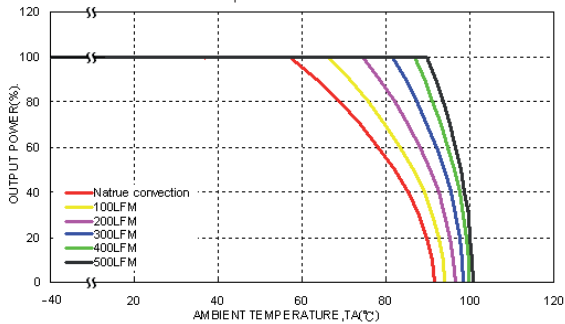

24 Vin models: Output 5-15 VDC

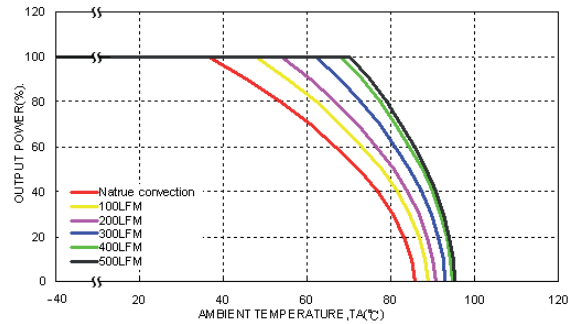

24 Vin models: Output 24-48 VDC

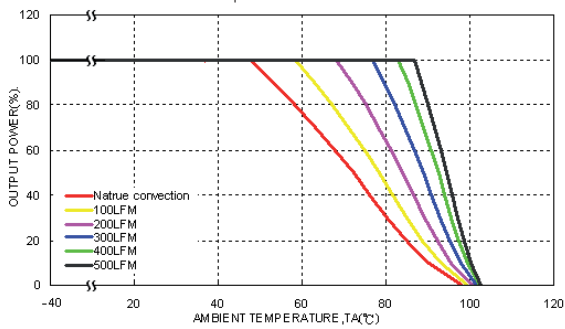

24 Vin models: Output 24-48 VDC

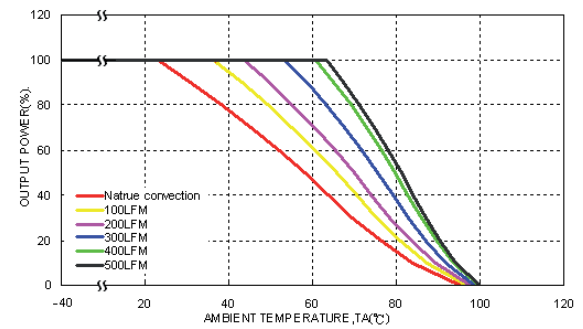

48 Vin models: Output 5-15 VDC

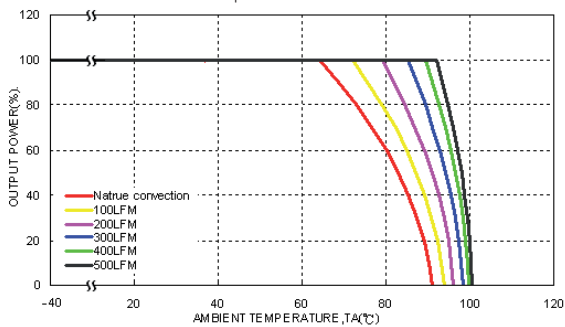

48 Vin models: Output 5-15 VDC

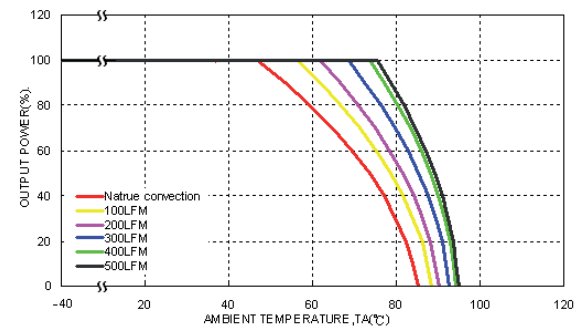

48 Vin models: Output 24-48 VDC

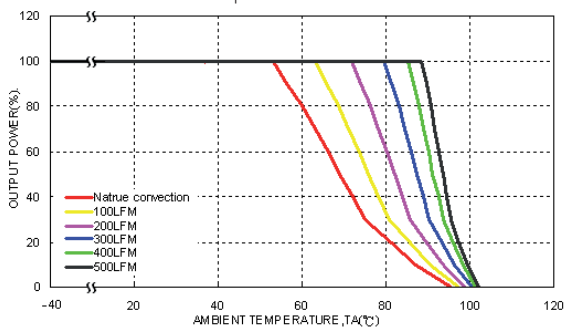

48 Vin models: Output 24-48 VDC

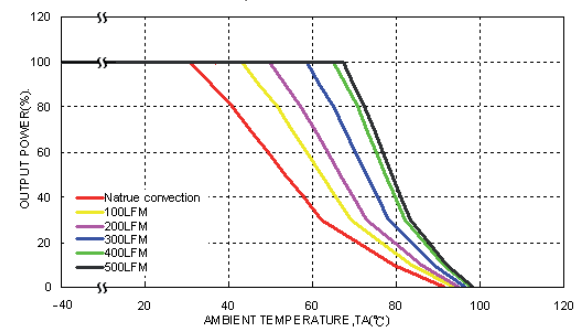

General Specifications

Casing material	metal
Potting material	silicon (UL94V-0 rated)
Base material	FR4
Vibration	acc. MIL-STD-810F

Dimensions

TEP 75 module

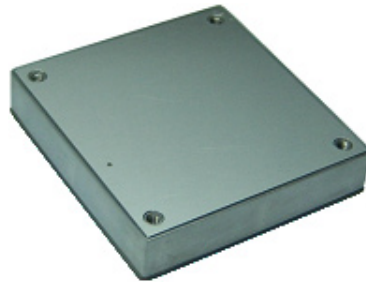
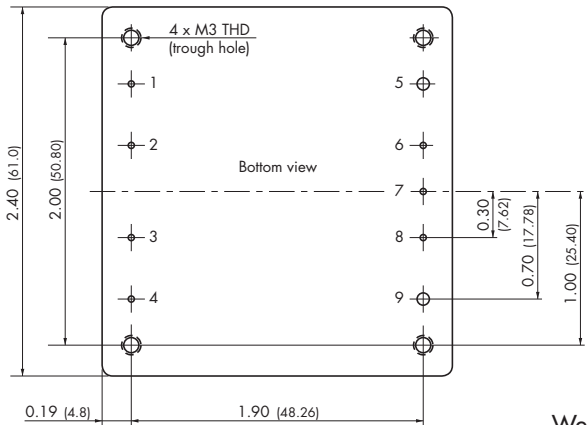

Weight: 97g (3.42 oz)

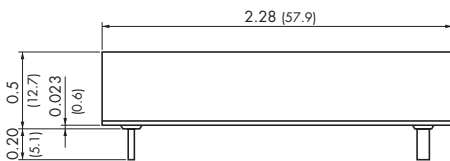

Pin diameter pin 5 & 9: 0.08 (2.0)
Pin diameter other pins: 0.04 (1.0)

Pin-Out	
Pin	
1	- Vin
2	Case
3	Remote On/Off
4	+ Vin
5	- Vout
6	- Sense*
7	Trim
8	+ Sense*
9	+ Vout

*Sense line to be connected to the output either at the module or at the load under regard of polarity.

TEP-HS1 Heatsink (pictured with heatsink mounted)

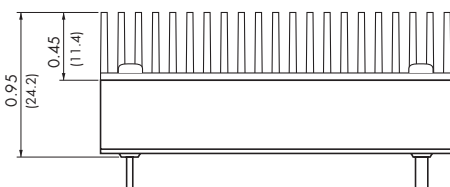

Order code: TEP-HS1

Includes heatsink with thermal pad and mounting screws
To order modules with mounted heatsink ask factory.

Weight: 135g (4.76 oz)
(Heatsink + Converter)

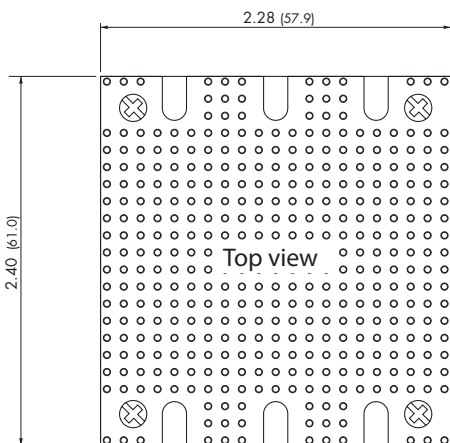

Dimensions in Inch, () = mm
Tolerances ±0.02 (0.5)
Pin pitch tolerances ±0.01 (0.25)
Mounting hole pitch tolerances ±0.01 (0.25)

Chassis Mount Adaptor

TEP 75 module with chassis mount adaptor (suffix -CM or -CMF)

For easy chassis mounting the converter modules can be supplied with an adaptor option consisting of a screw terminal connection board (soldered to converter pins) and a chassis mount adaptor.

In addition this Chassis mount option is available with an EMI-filter (see EMI specification)

Suffix -CM: Chassis mount adaptor

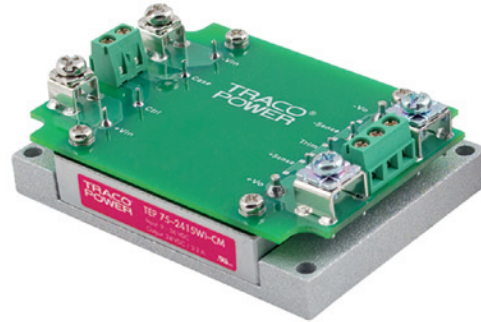
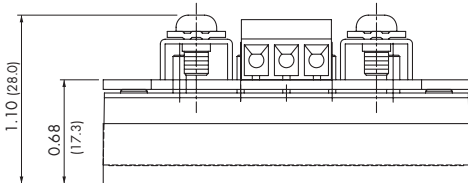

Suffix -CMF: Chassis mount adaptor with EMI filter

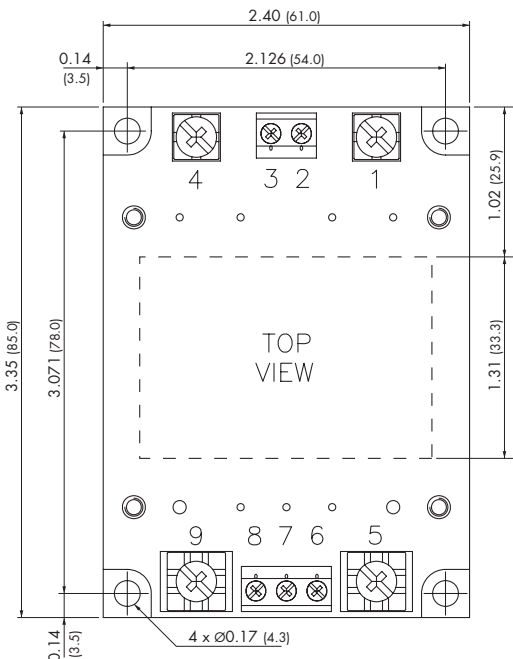
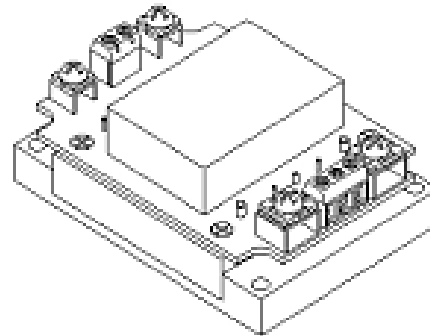
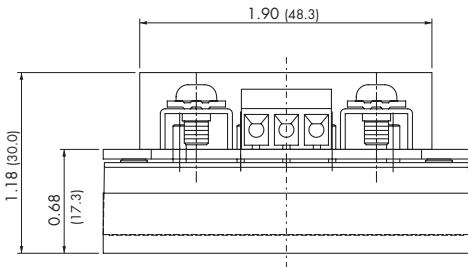

Please note that adaptors cannot be ordered as separate items but are factory assembled.

Connection	
Pin	
1	- Vin
2	Case
3	Remote On/Off
4	+ Vin
5	- Vout
6	- Sense*
7	Trim
8	+ Sense*
9	+ Vout

*Sense line to be connected to the output either at the module or at the load under regard of polarity.

Dimensions in Inch, () = mm
Tolerances ±0.02 (±0.5)
Mounting hole pitch tolerances ±0.01 (±0.25)

Specifications can be changed any time without notice.