

Spur Gearhead

Ø24 mm, 0.1 Nm

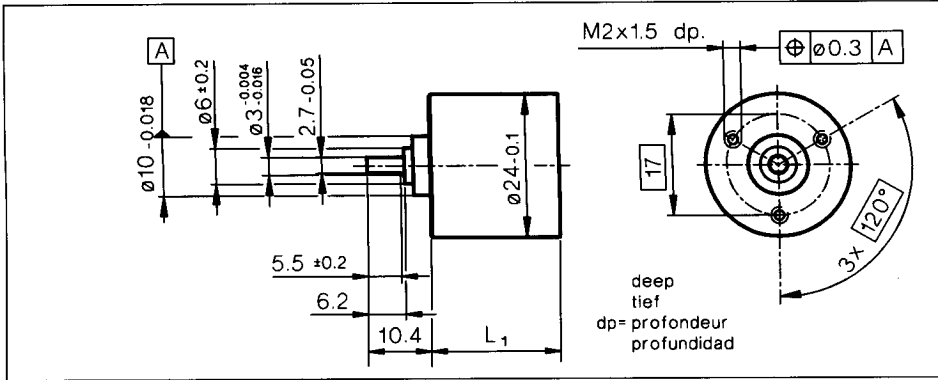

Technical Data

Spur gearhead	straight teeth
Bearing at output	sleeve bearing
Radial play, 8 mm from flange	0.038 mm
Axial play	0.03 - 0.30 mm
Max. perm. radial load, 8 mm from flange	5 N
Max. perm. axial load	8 N
Max. permissible force for press fits	500 N
Average backlash no load	< 2.5°
Backlash at 0.1 Nm torque	4°
Max. Efficiency per stage	~ 90%
Recommended input speed	< 4000 rpm
Recommended temperature range	-20/+65°C

Order Number	Reduction	No. of stages	max. Torque		Sense of direction	η max. [%]	Weight [g]	L1 max. [mm]	L2 max. [mm]	L3 max. [mm]	L4 max. [mm]	L5 max. [mm]	L6 max. [mm]	L7 max. [mm]	L8 max. [mm]	L9 max. [mm]	L10 max. [mm]
			Continuous [Nm]	Intermittent [Nm]													
110480	7.2 : 1	2	0.1	0.15	=	81	25	13.70	53.80	46.00	46.00	67.00	61.90	48.30	69.30	64.20	45.10
110481	20 : 1	4	0.1	0.15	=	66	28	17.40	57.50	49.70	49.70	70.70	65.60	52.00	73.00	67.90	48.80
110482	32 : 1	4	0.1	0.15	=	66	28	17.40	57.50	49.70	49.70	70.70	65.60	52.00	73.00	67.90	48.80
110483	64 : 1	4	0.1	0.15	=	66	28	17.40	57.50	49.70	49.70	70.70	65.60	52.00	73.00	67.90	48.80
110484	131 : 1	4	0.1	0.15	=	66	28	17.40	57.50	49.70	49.70	70.70	65.60	52.00	73.00	67.90	48.80
110485	199 : 1	6	0.1	0.15	=	53	30	21.20	61.30	53.50	53.50	74.50	69.40	55.80	76.80	71.70	52.60
110486	325 : 1	6	0.1	0.15	=	53	30	21.20	61.30	53.50	53.50	74.50	69.40	55.80	76.80	71.70	52.60

Stock program
 Standard program
 Special program (on request!)

+ Motor Order Number

25 15 - 62 . 1 2 1 - 0 0 0

Basic motor 2515....-11.111-000
Details see page 44

20 22 - 64 . 5 6 2 - 0 0 0

Basic motor 2022....-12.562-000
Details see page 46

25 22 . 9.. - 61 . 1 1 2 - 0 0 0

Basic motor 2522.9..-12.112-000
Details see page 48

25 22 . 9.. - 71 . 1 1 2 - 0 0 0

Basic motor 2522.9..-52.112-000
Details see page 49

25 22 . 9.. - 71 . 1 1 2 - 0 0 0

Basic motor 2522.9..-52.112-000
Details see page 49

25 22 . 9.. - 61 . 1 1 6 - 0 0 0

Basic motor 2522.9..-12.116-000
Details see page 50

25 22 . 9.. - 71 . 1 1 6 - 0 0 0

Basic motor 2522.9..-52.116-000
Details see page 51

25 22 . 9.. - 71 . 1 1 6 - 0 0 0

Basic motor 2522.9..-52.116-000
Details see page 51

20 23 - 61 . 5 2 1 - 0 0 0

Basic motor 2023....-21.581-000
Details see page 52

+ Tacho/Encoder

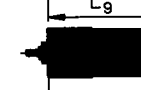
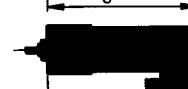
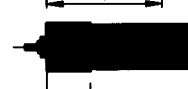
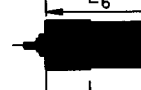
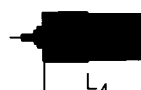
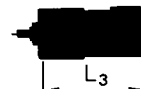
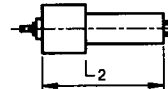

DC-Tacho
Ø22 mm, 0.52 V
Details see page 136

Digital Encoder
22 mm, 100 CPT, 2 channels
Details see page 141

DC-Tacho
Ø22 mm, 0.52 V
Details see page 136

Digital Encoder
22 mm, 100 CPT, 2 channels
Details see page 141