

1591E

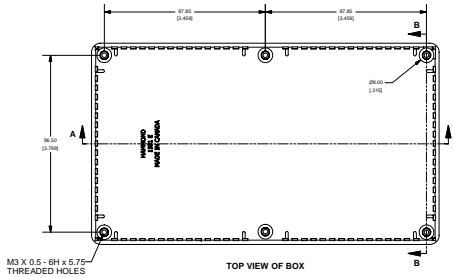

SIDE VIEW OF BOX



TOP VIEW OF BOX

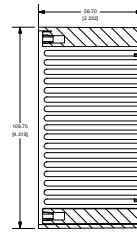

SECTION B-B
SCALE 3/4

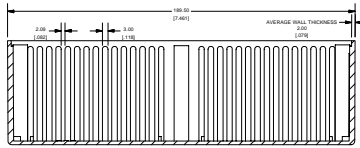

SECTION A-A
SCALE 3/4

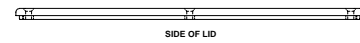
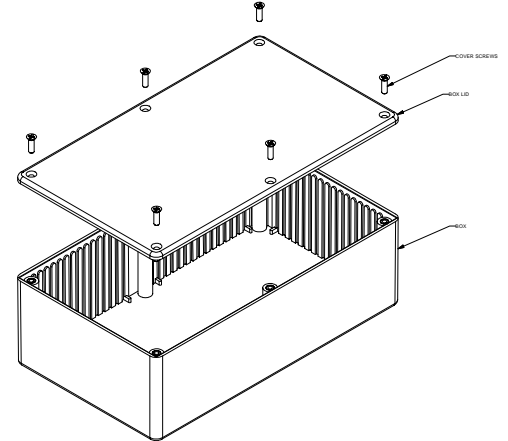

SIDE OF LID

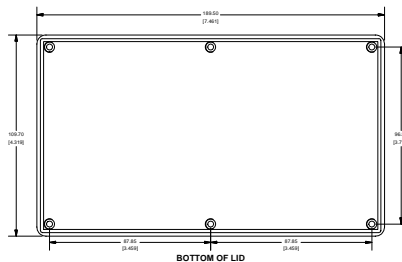

BOTTOM OF LID



SIDE OF LID

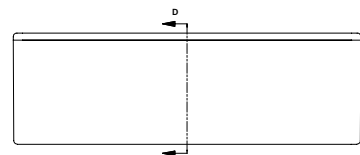

SIDE VIEW OF ASSEMBLY

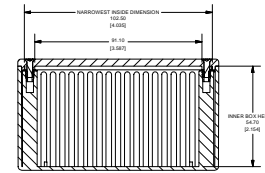

SECTION D-D
SCALE 3/4

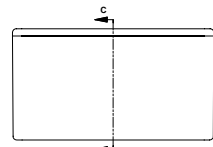

END VIEW OF ASSEMBLY

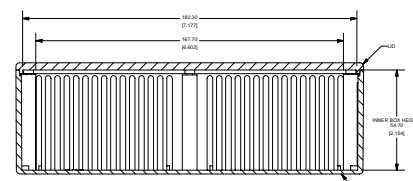

SECTION C-C
SCALE 3/4

PART NUMBERS		
1591E Enclosures		
Material	Colour	Part Number
ABS	Black	1591EBK
	Blue	1591EBU
	Grey	1591EGR
	Black Shielded	1591REBK
GP ABS	Black	1591ESBK
Translucent Polycarbonate	Ice Blue	1591ETBU
	IR Red	1591ETRD
	Crystal Clear	1591ETCL
Accessories		
Material	Description	Part Number
Used with ABS and Translucent Polycarbonate Enclosures	PC Board Card Adapters	See Accessories Section
	Flange Kits	See Accessories Section
	Replacement Screws, nickel plated M3 - 0.5 x 10mm, Pack of 100	1591MS100
	Replacement Screws, self tapping, black oxide, #4 x 0.5, Pack of 100	1591MS100BK (Black)
Used with GP ABS Enclosure	BeltPocket Clip, w/ nylon screws (insulated to avoid interference) and mounting template	1599CLIP - Black 1599CLIPGY - Grey
	Clear Lids - clear, flame retardant polycarbonate - Lid ONLY	1591EC
	PC Board Card Adapters	See Accessories Section
	Flange Kits	See Accessories Section
Required for use of Enclosures (see lubrication)	BeltPocket Clip, w/ nylon screws (insulated to avoid interference) and mounting template	1599CLIP - Black 1599CLIPGY - Grey
	Replacement Screws, self tapping, black oxide, #4 x 0.5, Pack of 100	1591TS100BK
	Clear Lids - clear, flame retardant polycarbonate - Lid ONLY	1591EC
	M3 - 0.5 x 10mm Screws	30-40 ch/m
#4 x 0.5 Screws	30-40 ch/m	

