

1591H

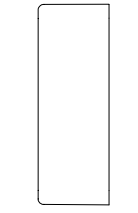

SIDE VIEW OF BOX

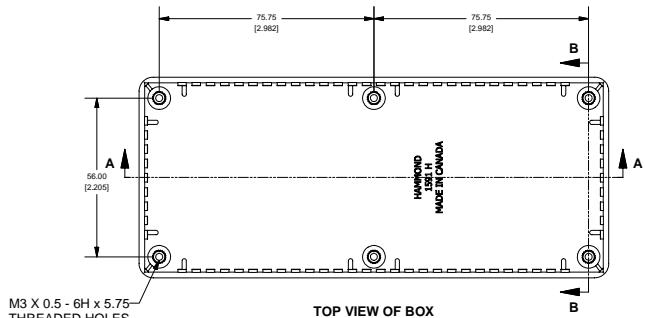

TOP VIEW OF BOX

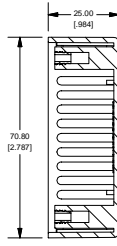

SECTION B-B
SCALE 3 / 4

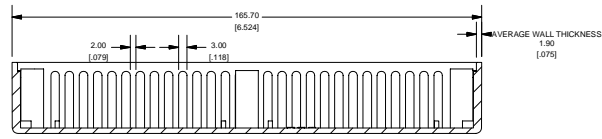

SECTION A-A
SCALE 3 / 4

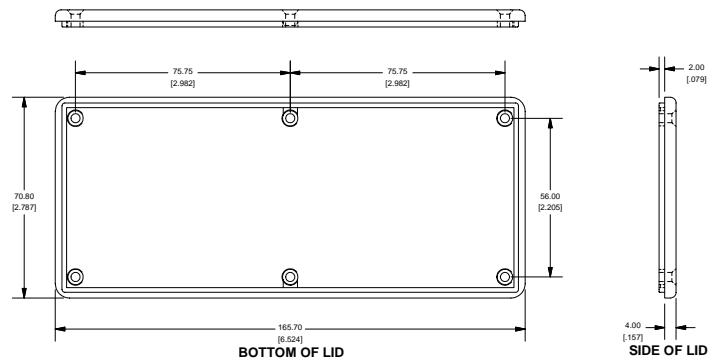
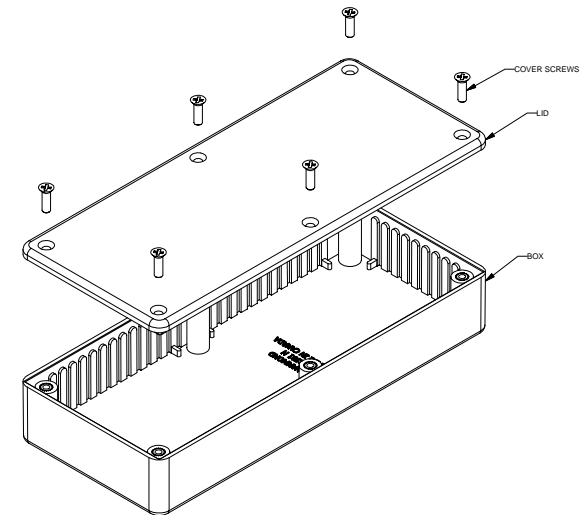

BOTTOM OF LID

SIDE OF LID

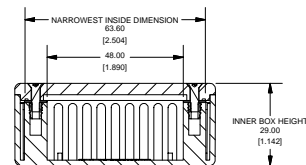
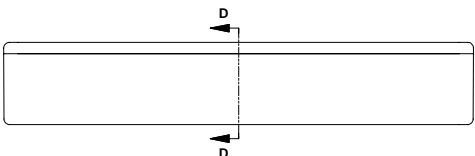

SECTION D-D
SCALE 3 / 4

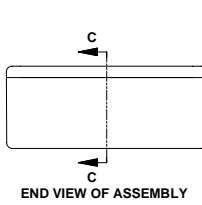

END VIEW OF ASSEMBLY

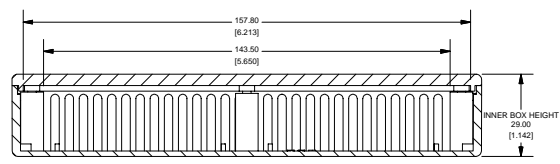

SECTION C-C
SCALE 3 / 4

PART NUMBERS		
1591H Enclosures		
Material	Colour	Part Number
ABS	Beige	1591HBG
	Black	1591HBK
	Blue	1591HBU
	Grey	1591HGY
	Black Shielded	1591RHBK
GP ABS	Black	1591HSBK
Translucent Polycarbonate	Ice Blue	1591HTBU
	IR Red	1591HTRD
	Crystal Clear	1591HTCL
Accessories		
	Description	Part Number
Used with ABS and Translucent Polycarbonate Enclosures	PC Board Card Adapters	See Accessories Section
	Flange Kits	See Accessories Section
	Replacement Screws, nickel plated M3 - 0.5 x 10mm, Pack of 100.	1591MS100
	Belt/Pocket Clip, w/ nylon screws (insulated to avoid interference) and mounting template	1591MS100BK (Black) 1599CLIP - Black 1599CLIPGY - Grey
	Clear Lids - clear, flame retardant polycarbonate - Lid ONLY	1591HC
Used with GP ABS Enclosure	PC Board Card Adapters	See Accessories Section
	Flange Kits	See Accessories Section
	Belt/Pocket Clip, w/ nylon screws (insulated to avoid interference) and mounting template	1599CLIP - Black 1599CLIPGY - Grey
	Replacement Screws, self tapping, black oxide, #4 x 0.5, Pack of 100	1591TS100BK
	Clear Lids - clear, flame retardant polycarbonate - Lid ONLY	1591HC
Required Torque on Fasteners (no lubrication)		
	M3 - 0.5 x 10mm Screws	30-40 cN*m
	#4 x 0.5 Screws	30-40 cN*m