

Push-in/threaded fitting
Type QS-...
with teflon-coated R-thread.

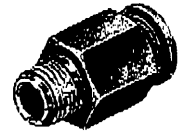
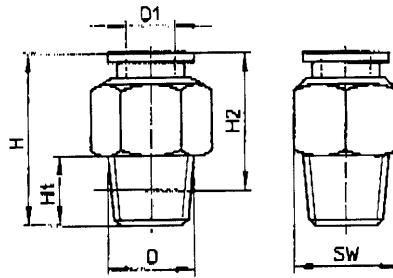

Technical Data see sheet 9/21-1

Order code		Connection	Nominal size mm	For tubing outside dia. D ₁	Weight kg	Dimensions			
Part No.	Type					D	H	H ₁	H ₂
153 001	QS-1/8-4	R 1/8	3	4	0.009	21	8	17	10
153 002	QS-1/8-6	R 1/8	4.6	6	0.009	22.5	8	18.5	12
153 004	QS-1/8-8	R 1/8	6	8	0.015	28	8	24	14
153 003	QS-1/4-6	R 1/4	4.6	6	0.017	24.5	11	18.5	14
153 005	QS-1/4-8	R 1/4	7	8	0.015	26.5	11	20.5	14
153 007	QS-1/4-10	R 1/4	8.5	10	0.020	30	11	24	17
164 980	QS-1/4-12	R 1/4	11	12	0.040	36	11	30	21
153 006	QS-3/8-8	R 3/8	7	8	0.023	24	12	17.5	17
153 008	QS-3/8-10	R 3/8	8.5	10	0.026	29.5	12	23	17
153 009	QS-3/8-12	R 3/8	11	12	0.036	32	12	25.5	21
164 957	QS-3/8-16	R 3/8	11	16	0.060	46	12	40	22
153 010	QS-1/2-12	R 1/2	11	12	0.050	34	15	26	21
153 011	QS-1/2-16	R 1/2	13	16	0.068	41.5	15	33.5	24

Push-in/threaded fitting
Type QS-...-I
with internal hexagon socket
and teflon-coated R-thread.

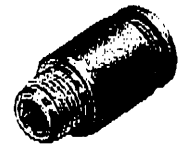
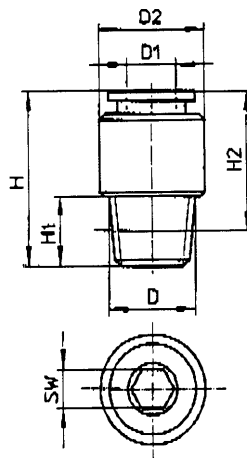

Technical Data see sheet 9/21-1

Order code		Connection	Nominal size mm	For tubing outside dia. D ₁	Weight kg	Dimensions				⌀
Part No.	Type					D ₂ dia.	H	H ₁	H ₂	
153 012	QS-1/8-4-I	R 1/8	2.6	4	0.008	9.5	21	8	17	2.5
153 013	QS-1/8-6-I	R 1/8	4.2	6	0.008	12	22.5	8	18.5	4
153 015	QS-1/8-8-I	R 1/8	5.3	8	0.014	14	28	8	24	5
153 014	QS-1/4-6-I	R 1/4	4.2	6	0.014	14	22.5	11	16.5	4
153 016	QS-1/4-8-I	R 1/4	6.3	8	0.015	14	26.5	11	20.5	6
153 018	QS-1/4-10-I	R 1/4	6.3	10	0.022	18	30	11	24	6
153 017	QS-3/8-8-I	R 3/8	6.3	8	0.022	17	24	12	17.5	6
153 019	QS-3/8-10-I	R 3/8	6.3	10	0.027	18	29.5	12	23	6
153 020	QS-3/8-12-I	R 3/8	8.5	12	0.034	21	32	12	25.5	8
153 021	QS-1/2-12-I	R 1/2	8.5	12	0.048	21	34	15	26	8

c) Comparative table of threads

M = Metric Thread
 G = (B.S.P.) British Standard Pipe
 NPT = National Pipe thread (Tapered)
 (mainly used in the USA)
 UNF = Unified Fine
 (fine thread in Anglo-Saxon countries)

Comparison of the most important threads used by FESTO in pneumatics.

Outside dia. mm	Core dia. mm	Pitch* Threads/inch	Metric Equivalent	G ≈ BSP	NPT	UNF
3.8-3.9	3.2-3.4	3.7	M 4			
4.0-4.2	3.4-3.6	36				No. 8
4.6-4.8	4.0-4.2	32				No. 10
4.8-4.9	4.1-4.3	0.8	M 5			
5.7-5.9	4.9-5.2	1.0	M 6			
7.7-7.9	6.9-7.2	1.0	M 8 x 1			
7.7-7.9	6.6-6.9	1.25	M 8			
7.7-7.9	6.8-7.1	24				5/16 x 24
Largest 7.9	Smallest 6	27			1/16	
9.5-9.7	8.5-8.8	28		G 1/8		
9.7-9.9	8.9-9.2	1.0	M 10 x 1			
9.7-9.9	8.6-8.9	1.25	M 10 x 1.25			
9.7-9.9	8.4-8.7	1.5	M 10			
Largest 10.3	Smallest 8.3	27			1/8	
10.9-11.1	9.7-10.0	20				7/16 x 20
11.7-11.9	10.6-10.9	1.25	M 12 x 1.25			
11.7-11.9	10.4-10.7	1.5	M 12 x 1.5			
11.6-11.9	10.1-10.4	1.75	M 12			
12.5-12.7	11.3-11.7	20				1/2 x 20
12.9-13.2	11.4-11.9	19		G 1/4		
Largest 13.7	Smallest 10.7	18			1/4	
15.7-15.9	14.4-14.7	1.5	M 16 x 1.5			
15.6-15.9	13.8-14.2	2.0	M 16			
15.7-15.9	14.4-14.7	16				5/8 x 16
16.4-16.7	14.9-15.4	19		G 3/8		
Largest 17.1	Smallest 14.2	18			3/8	
18.8-19.1	17.3-17.8	16				3/4 x 18
19.7-19.9	18.9-19.2	1.0	M 20 x 1			
19.7-19.9	18.4-18.7	1.5	M 20 x 1.5			
19.6-19.9	17.3-17.7	2.5	M 20			
20.7-20.9	18.6-19.2	14		G 1/2		
Largest 21.3	Smallest 17.4	14			1/2	
21.7-21.9	20.4-20.7	1.5	M 22 x 1.5			
21.9-22.6	20.3-20.8	14				7/8 x 14
23.7-23.9	22.4-22.7	1.5	M 24 x 1.5			
23.6-23.9	20.8-21.3	3.0	M 24			
25.1-25.4	23.1-23.6	12				1 x 12
26.2-26.4	24.1-24.7	14		G 3/4		
26.6-26.9	24.8-25.2	2.0	M 27 x 2			
Largest 26.7	Smallest 22.5	14			3/4	
28.3-28.6	26.3-26.8	12				1 1/8 x 12
29.7-29.9	28.4-28.7	1.5	M 30 x 1.5			
31.5-31.7	29.5-30.0	12				1 1/4 x 12
32.9-33.2	30.3-30.9	11		G 1		
Largest 33.4	Smallest 28.5	11 1/2			1	
35.7-35.9	34.4-34.7	1.5	M 36 x 1.5			
35.6-35.9	33.8-34.2	2.0	M 36 x 2			
37.7-37.9	36.4-36.7	1.5	M 38 x 1.5			
37.8-38.1	35.8-36.4	12				1 1/2 x 12
41.6-41.9	38.9-39.6	11		G 1 1/4		
41.7-41.9	40.4-40.7	1.5	M 42 x 1.5			
41.6-41.9	39.8-40.2	2.0	M 42 x 2			
Largest 42.2	Smallest 37.0	11 1/2			1 1/4	
44.7-44.9	43.4-43.7	1.5	M 45 x 1.5			
47.4-47.8	44.8-45.5	11		G 1 1/2		
47.6-47.9	45.8-46.2	2.0	M 48 x 2			
Largest 48.3	Smallest 43.5	11 1/2			1 1/2	
59.3-59.6	56.7-57.3	11		G 2		
59.7-59.9	58.4-58.7	1.5	M 60 x 1.5			
Largest 60.3	Smallest 55.0	11 1/2			2	
79.7-79.9	78.4-78.7	1.5	M 80 x 1.5			

* with metric thread