

**Material and Finish**

Inner Shield: copper alloy,  
tin plated

Outer Shield: steel, tin plated

Body: PBT thermoplastic  
UL94V-0 rated  
color - black

Contacts: pins 1 and 2 - brass,  
tin plated

pin 3 - phosphor bronze,  
tin plated

**Electrical Characteristics**

Contact Rating:  
#1,#2: 7.5A max. @ 20V DC  
#3: 1.0A max. @ 20V DC

Insulation Resistance:  
50 Megohms min. at 250V DC

Dielectric Strength:  
250 V AC rms for 1 minute

Contact Resistance:  
50 milliohms max.

**Recommended PCB Layout  
(Bottom View)**

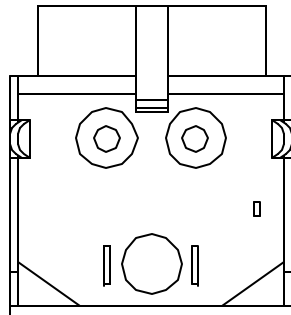
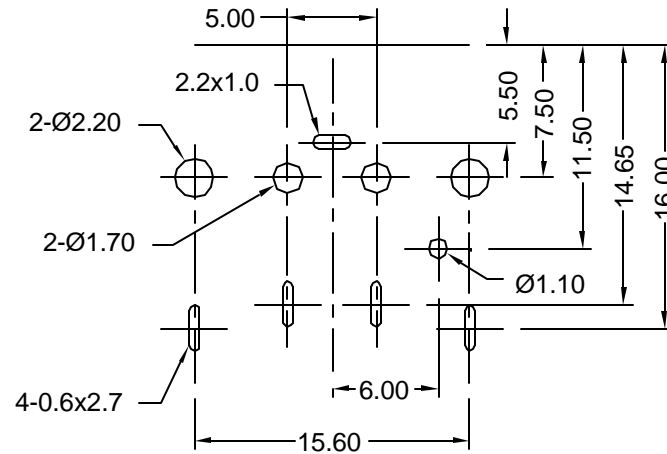

**RoHS COMPLIANT**  
EU Directive 2002/95/EC



Tolerances
X.X ± 0.25
X.XX ± 0.15
Unless Stated
Otherwise

REV.	DATE	DESCRIPTION	REV. BY	CHK. BY	DRAWN BY	DATE
A1	4/13/05	New Drawing	H. MA	C. Furumasu	H. MA	4/13/05

**KPJX-3S-S**

**DC Power Jack, RoHS Compliant**  
**3 Position, Shielded**

