

FEATURES AND SPECIFICATIONS

Features and Benefits

- Passive (friction) lock
- 1 to 15 circuit housings
- Panel and PCB mountable
- 1-piece strain reliefs available (42148 Series)
- Male and female terminals may be used in plug housing

Reference Information

Packaging: Bag
 UL File No.: E29179
 CSA File No.: LR19980
 Mates With: Standard .093" receptacle and 42148 strain relief
 Designed In: Inches

Electrical

Voltage: 250V
 Current: 12.0A max.
 Dielectric Withstanding Voltage: 1500V AC rms

Mechanical

Contact Retention to Housing: 20 lb min.

Physical

Housing: Nylon, UL 94V-2
 Temperature: -40 to +105°C

molex® 2.36mm (.093") Diameter .093" Pin and Socket Plug

Standard .093"

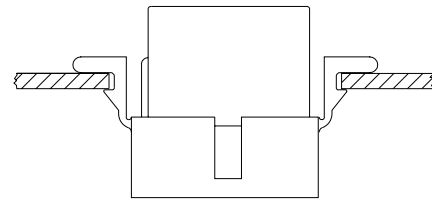
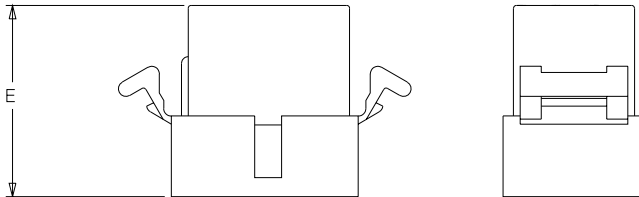
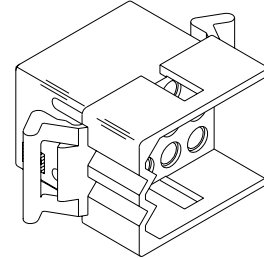

PANEL CUTOUT INFORMATION

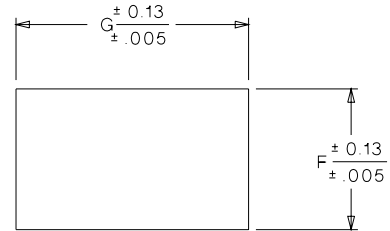
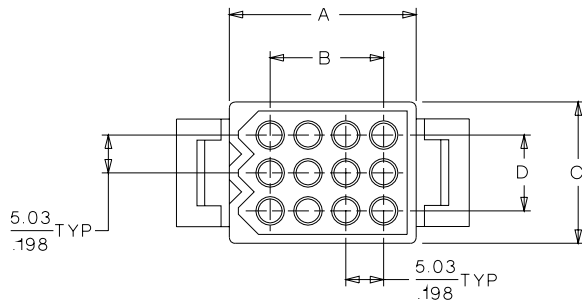

RECOMMENDED PANEL THICKNESS: $\frac{2.29}{.090}$ MAX

ORDERING INFORMATION AND DIMENSIONS

| Circuits | Series No. | Order No. | | Amperes per Circuit* | Dimension | | | | | | |
|-----------|------------|---------------------------|--------------|----------------------|---------------|--------------|--------------|--------------|---------------|--------------|---------------|
| | | Panel Mount | Free Hanging | | A | B | C | D | E | F | G |
| 1 | 1951 | N/A | • 03-09-2014 | 12 | | | 11.20 (.440) | | 57.20 (2.250) | | |
| 1 | 1619 | N/A | • 03-09-2011 | 12 | | | 9.10 (.360) | | 25.40 (1.000) | | |
| 2 | 1545 | • 03-09-2021 | • 03-09-2022 | 12 | 16.30 (.640) | 6.30 (.248) | 8.90 (.350) | | 25.40 (1.000) | 9.53 (.375) | 20.32 (.800) |
| 3 | 1396 | • 03-09-2031 | • 03-09-2032 | 12 | 19.60 (.770) | 10.06 (.396) | 8.60 (.340) | | 25.40 (1.000) | 9.53 (.375) | 23.70 (.933) |
| 4 (1 x 4) | 1490 | • 03-09-2041 | • 03-09-2042 | 9 | 24.70 (.970) | 15.09 (.594) | 8.60 (.340) | | 25.40 (1.000) | 9.53 (.375) | 28.73 (1.131) |
| 4 (2 x 2) | 2163 | • 03-09-2040 | • 03-09-2049 | 9 | 13.70 (.540) | 5.03 (.198) | 13.70 (.540) | 5.03 (.198) | 26.00 (1.020) | 17.65 (.695) | 14.10 (.555) |
| 5 | 2629 | N/A | • 03-09-2057 | 9 | 30.00 (1.180) | 20.12 (.792) | 8.60 (.340) | | 25.40 (1.000) | | |
| 6 | 1261 | • 03-09-2061 | • 03-09-2062 | 9 | 13.70 (.540) | 5.03 (.198) | 18.60 (.730) | 10.06 (.396) | 25.40 (1.000) | 17.65 (.695) | 19.05 (.750) |
| 9 | 1292 | • 03-09-2091 | • 03-09-2092 | 9 | 19.60 (.770) | 10.06 (.396) | 18.50 (.730) | 10.06 (.396) | 25.40 (1.000) | 16.76 (.660) | 23.80 (.937) |
| 12 | 1360 | • 03-09-2122 | • 03-09-2121 | 7.5 | 24.90 (.980) | 15.09 (.594) | 18.80 (.740) | 10.06 (.396) | 24.90 (.980) | 19.30 (.760) | 29.34 (1.155) |
| 15 | 1375 | • 03-09-2152 ¹ | • 03-09-2159 | 7.5 | 29.70 (1.170) | 20.12 (.792) | 18.80 (.740) | 10.06 (.396) | 24.90 (.980) | 19.30 (.760) | 34.11 (1.343) |

• US Standard Product, available through Molex franchised distributors

* Rating based on fully loaded housings and 14 AWG wire

¹ Vertical headers may be assembled using PC tail terminals in standard housings