

This document is the property of Amphenol Corporation and is delivered on the express condition that it is not to be disclosed, reproduced or used, in whole or in part, for manufacture or sale by anyone other than Amphenol Corporation without its prior consent, & that no right is granted to disclose or to use any information in this document.

# Customer drawing

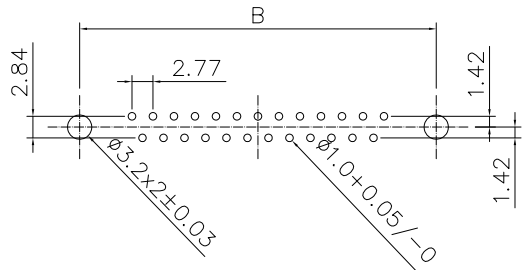

Recommended PCB Layout  
Tolerance: ±0.05mm

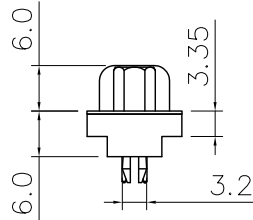
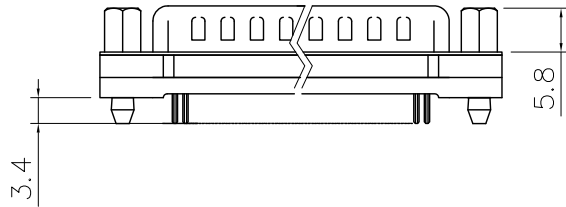
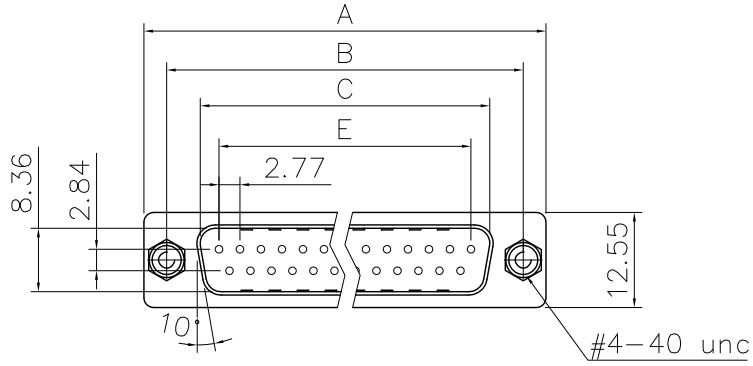

## Dimensions

Positions	A	B	C	E
9	30.81	24.99	16.92	11.08
15	39.20	33.30	25.25	19.39
25	53.05	47.04	38.96	33.24
37	69.40	63.50	55.42	49.86

REVISIONS				
SYM	ECN	DESCRIPTION	DATE	APPROVED
1	HK--	First Release Drawing	04/01/08	IP
2	HK--	Update the Drawing	02/11/14	IP

## D-SUB TECHNICAL DATA

SHELL : Steel, 100u" Tin over 50u" min nickel over 50u" min Copper  
 BODY : PBT, UL 94V-0, Color:Black.  
 CONTACTS : Copper Alloy.  
 15u" gold over 50u" nickel on mating area  
 100u" tin over 50u" nickel on solder area  
 SCREW: Copper Alloy, Nickel Plated  
 BOARDLOCK: Copper Alloy, Tin Plated.  
 ELECTRICAL: Voltage rating 250 V RMS  
 Current Rating 3 AMP  
 Withstanding Voltage >1000 V RMS  
 Insulation resistance >1000 M Ohms  
 Contact resistance 20 mOhms max.  
 MARKING: Amphenol...(Series No.)  
 Commercial reference  
 Manufacturing date

## PRODUCT CODE

**L 777 TS X H XX P OL2 RM8**

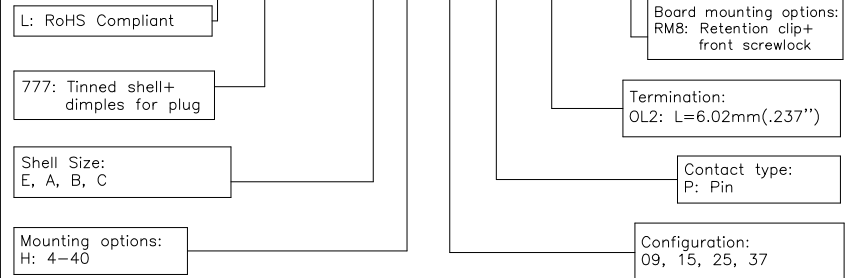

UNLESS OTHERWISE SPECIFIED TOLERANCES		APPROVAL		DATE
U.S.	METRIC	DRAWN	Checked	DATE
.X +/-	0.50	Felix Liu		02/11/14
.XX +/-	0.30	Tony Tang		02/11/14
.XXX +/-	0.20	CHECKED		
FRACTIONS +/-				
ANGLES +/-	5°			
FOR MATERIALS AND FINISHES SEE NOTES		DRAWING FILE :		
REMOVE SHARP EDGES		ANGLE OF PROJECTION		
DIMENSIONS				
U.S.	INCHES			
METRIC	MM			

Amphenol		
Amphenol East Asia Limited		
TITLE D-SUB connector,TS series		
SIZE	DRAWING NO.	REV.
A4	C L777TSXHXXPOL2RM8	2
SCALE	NONE	SHEET 1 OF 1