

POSITRONIC INDUSTRIES BELIEVES THE DATA ON THIS DRAWING TO BE RELIABLE SINCE THE TECHNICAL INFORMATION IS GIVEN FREE OF CHARGE, THE USER EMPLOYS SUCH INFORMATION AT HIS OWN DISCRETION. POSITRONIC INDUSTRIES ASSUMES NO LIABILITY OR RESPONSIBILITY FOR RESULTS OBTAINED OR DAMAGES INCURRED FROM USE OF SUCH INFORMATION IN WHOLE OR IN PART.

SK6936

DATE	REV	REVISION RECORD	APP	DR	CK
1-11-06	NC	ECO 25331		YK	

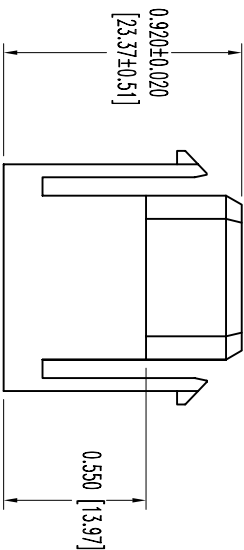
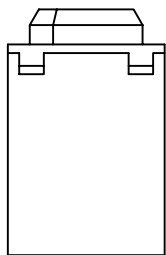
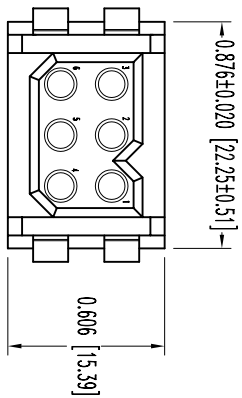

- NOTES:
1. MATERIALS AND FINISHES:
INSULATOR: GLASS FILLED POLYESTER, UL 94V-0, COLOR BLUE.
 2. ELECTRICAL CHARACTERISTICS:
INSULATOR RESISTANCE: 5 G OHMS PER IEC 512-2, TEST 3d, METHOD A.
WORKING VOLTAGE: 600 VAC.
 3. WORKING TEMPERATURE: -55°C TO +125°C
 4. CONNECTORS ARE ROHS COMPLIANT PER ROHS DIRECTIVE 2002/95/EC OF 27 JAN 2003.
 5. DIMENSIONS ARE INCHES [MILLIMETERS]



POSITRONIC INDUSTRIES INC.
www.connectpositronic.com



DECIMAL TOL.
± 0.015 [0.38]



ANGULAR TOL.
± 5°

DATE	1-11-06	DRAWING NUMBER	SK6936	REV.	NC
TITLE	PCS SERIES				
	P1B06F0000/AA				
SCALE	N.T.S.	DRAWN BY	YK		
APPROVED BY					