

THIS DRAWING CONTAINS INFORMATION PROPRIETARY TO POSITRONIC INDUSTRIES. THE DATA ON THIS DRAWING TO BE RELEASED SINCE THE USER EMPLOYER'S SUCH INFORMATION AT HIS OWN DISCRETION. RESULTS OBTAINED OR DAMAGES INCURRED FROM USE OF SUCH INFORMATION IN WHOLE OR IN PART.

SK11094

DATE	REV	REVISION RECORD	APP	DR	CK
10-28-09	NC	ECO 31674	TK	BS	TK
12-21-12	A	ECO 38101	COLB	BE	COLB

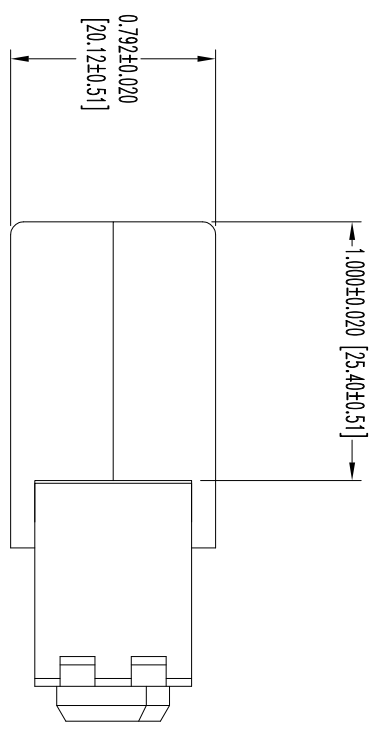
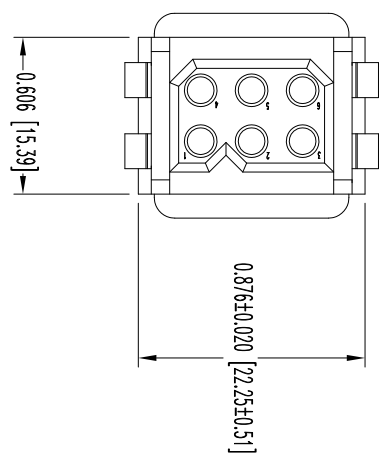
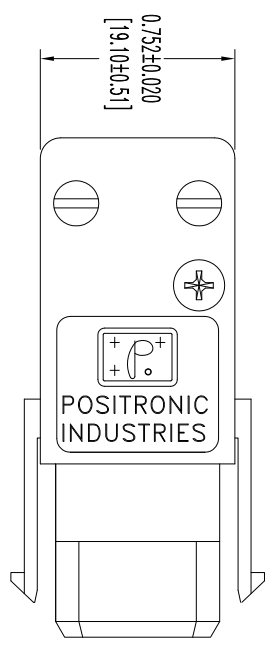

NOTES:

1. MATERIALS AND FINISHES:

INSULATOR: GLASS FILLED POLYESTER, UL 94V-0, COLOR BLUE.  
 HOOD: GLASS FILLED POLYESTER, UL 94V-0, COLOR BLUE.  
 SCREWS: STEEL, ZINC PLATE WITH CHROMATE SEAL.

CABLE CLAMP: STEEL, NICKEL PLATE.

CABLE CLAMP SCREWS: STEEL, ZINC PLATE WITH CHROMATE SEAL.

2. DETAILED PRODUCT, MECHANICAL, AND ELECTRICAL INFORMATION IS AVAILABLE IN THE LATEST POWER CONNECTION SYSTEMS PRODUCT PUBLICATION.

VISIT [CONNECTPOSITRONIC.COM/PRODUCTS/20/POWERCONNECTIONSYSTEMS](http://CONNECTPOSITRONIC.COM/PRODUCTS/20/POWERCONNECTIONSYSTEMS) OR [CONNECTPOSITRONIC.COM](http://CONNECTPOSITRONIC.COM).

3. CONNECTORS ARE COMPLIANT TO THE CURRENT ROHS DIRECTIVE.

4. DIMENSIONS ARE IN INCHES [MILLIMETERS].



**POSITRONIC INDUSTRIES INC.**  
[www.connectpositronic.com](http://www.connectpositronic.com)

FSC# 28198

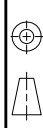

DECIMAL TOL.  $\pm 0.015$  [0.38]

SCALE: N.T.S. DRAWN BY: B SHELLADY

TITLE: PCS SERIES APPROVED BY: T KEPLER

FSC# 28198

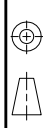

ANGULAR TOL.  $\pm 5^\circ$

DATE	DRAWING NUMBER	REV.
10-28-09	SK11094	A

DATE: 10-28-09

DRAWING NUMBER: SK11094

REV.: A