

REVISIONS				
REV	LTN	DESCRIPTION	DATE	APVD
A		ECO-14-005495	10APR2014	AD AD

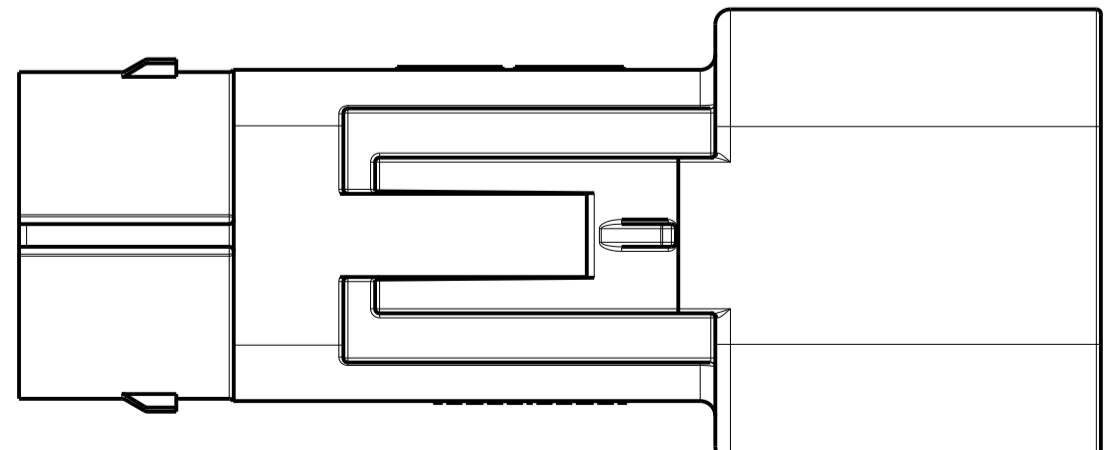
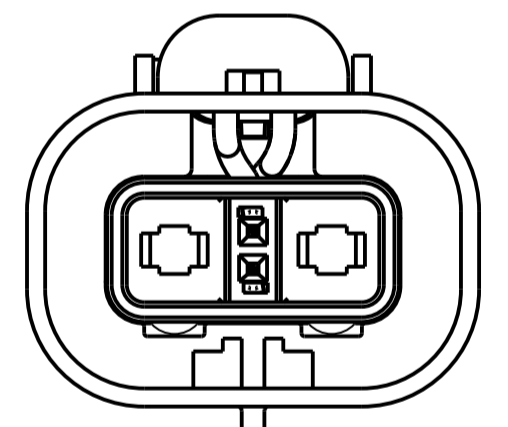
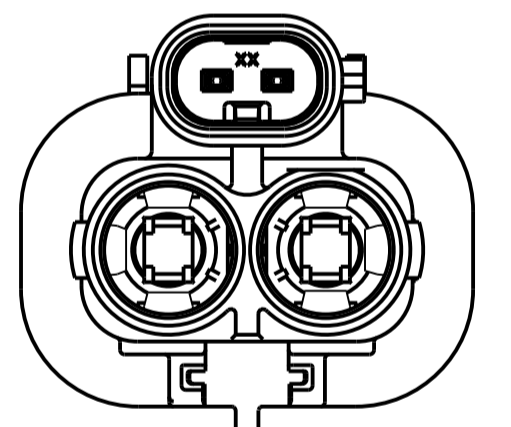
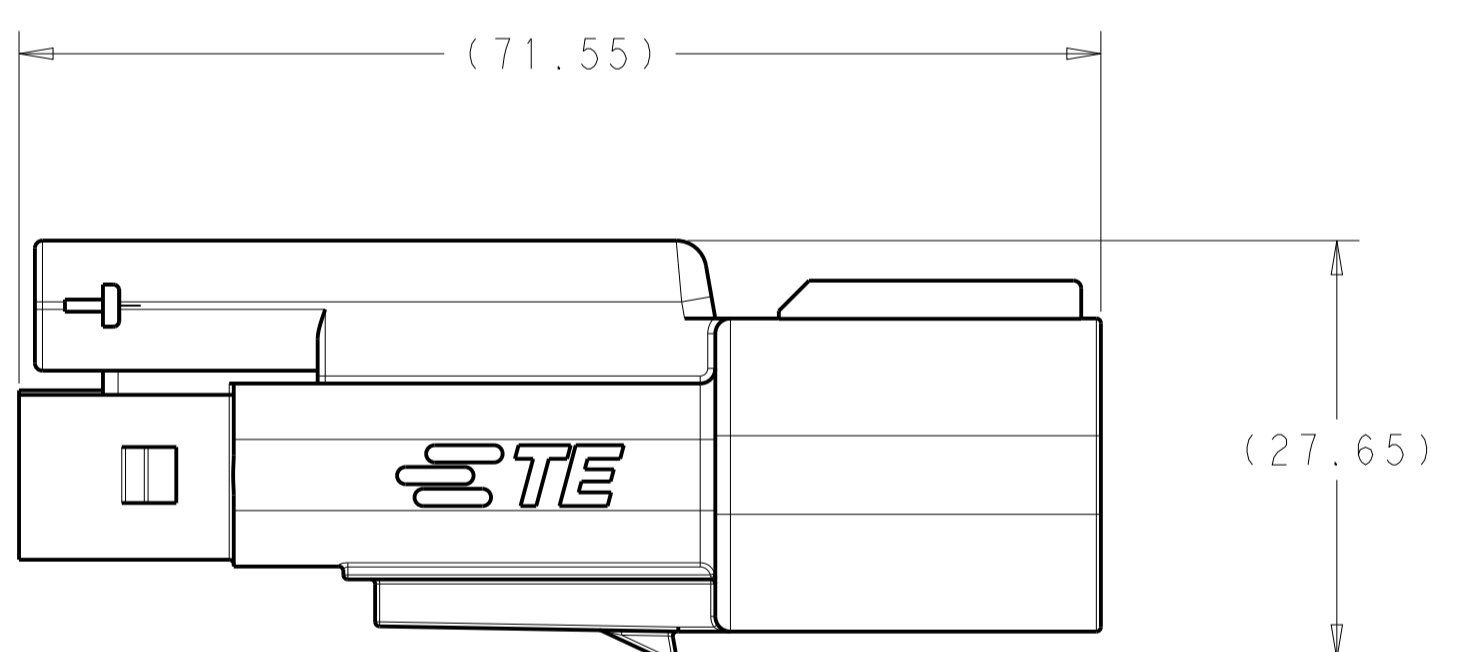
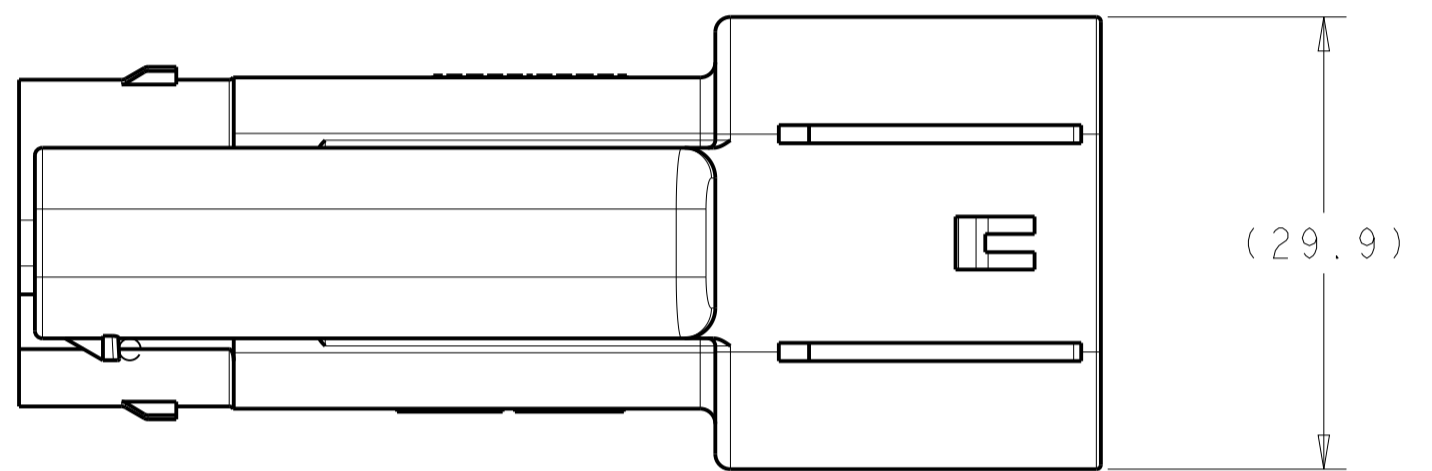
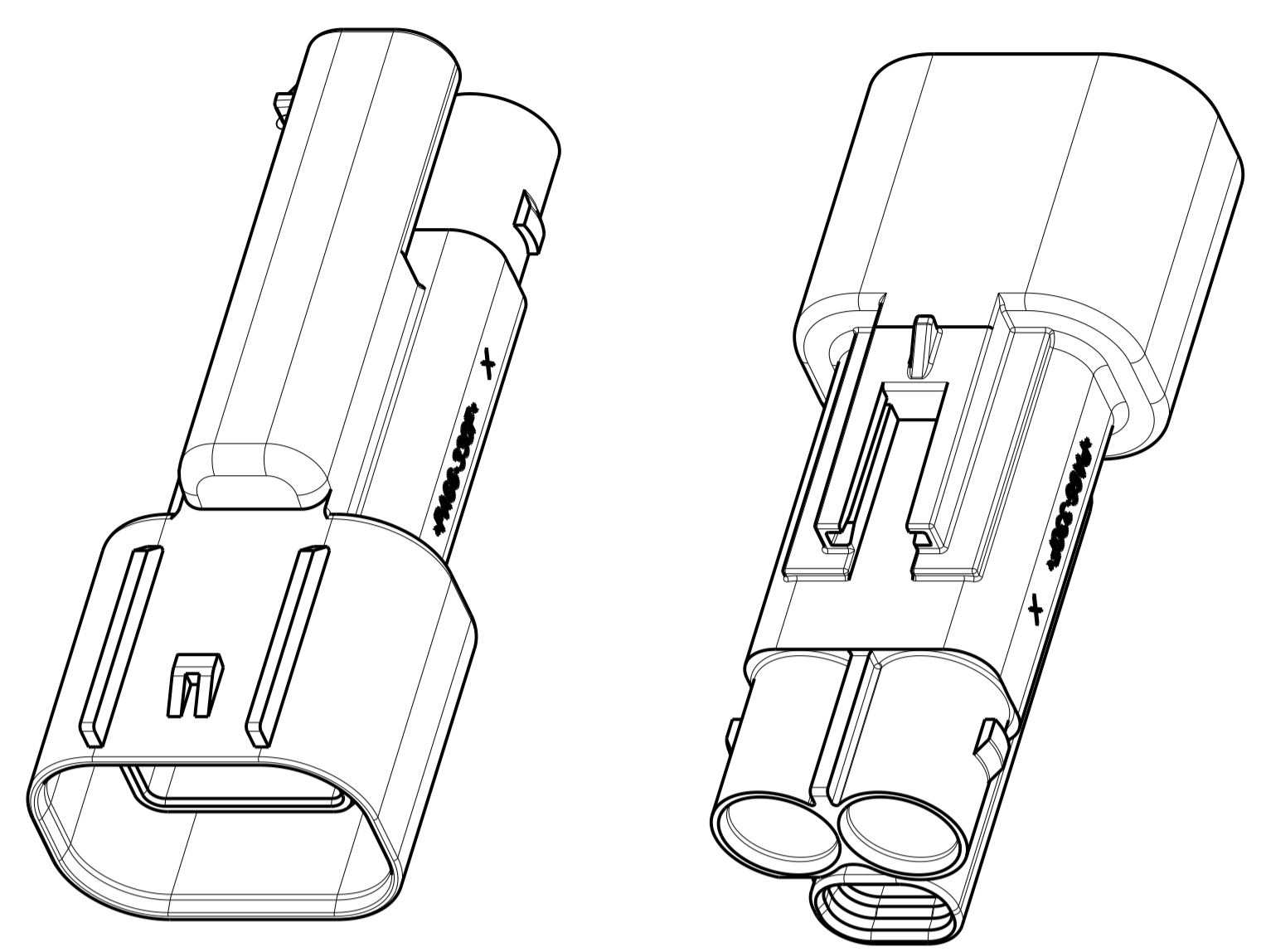
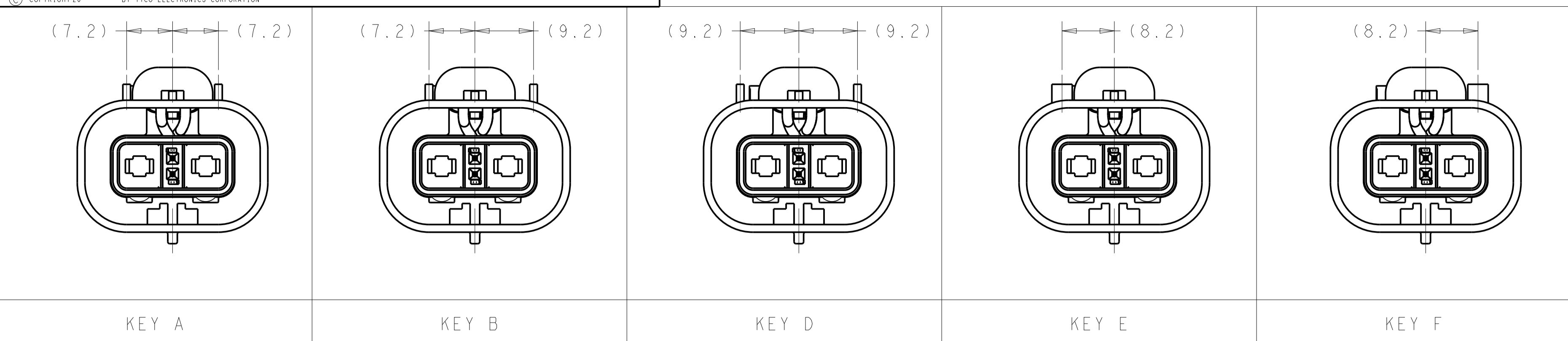

DESCRIPTION	PART NO
CAP SUBASSEMBLY, KEY F, HVA280 2PHI	2103191-6
CAP SUBASSEMBLY, KEY E, HVA280 2PHI	2103191-5
CAP SUBASSEMBLY, KEY D, HVA280 2PHI	2103191-4
CAP SUBASSEMBLY, KEY B, HVA280 2PHI	2103191-2
CAP SUBASSEMBLY, KEY A, HVA280 2PHI	2103191-1

THIS DRAWING IS A CONTROLLED DOCUMENT.		OWN: A DE CHAZAL 08DEC2011	TE Connectivity
DIMENSIONS: mm		CHK: A DE CHAZAL 08DEC2011	
TOLERANCES UNLESS OTHERWISE SPECIFIED: 0 PLC ±0.5 1 PLC ±0.5 2 PLC ±0.13 3 PLC ±0.013 4 PLC ±0.0001 ANGLES ±0.0001		APVD: A DE CHAZAL	NAME: CAP SUBASSY, HVA280-2PHI
MATERIAL: -		FINISH: -	PRODUCT SPEC: -
-		APPLIC. SPEC: -	APPLICATION SPEC: -
-		WEIGHT: -	SIZE: A100779C=2103191
-		CUSTOMER DRAWING	RESTRICTED TO: -
-		SCALE: 2:1	SHEET 1 OF 1 REV A