

REVISIONS				
REV	ECO	DESCRIPTION	DATE	BY APPR
A1	-	RELEASED DRAWING	Jun-28-2017	Flan Tommy

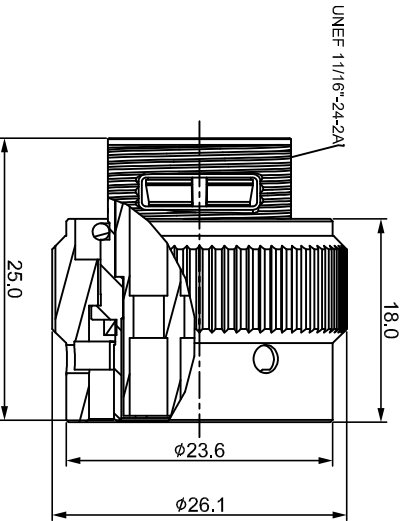
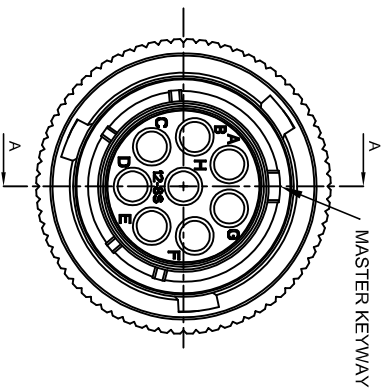
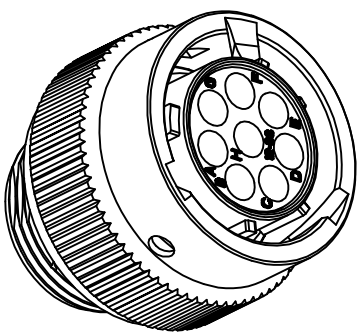

SECTION A-A

KEY POS	PART NUMBER	PART NUMBER
	-40°C ~ 105°C	-40°C ~ 125°C
N	RT06128SNHSS	RT06128SNH03SS
W	RT06128SWHSS	RT06128SWH03SS
X	RT06128SXHSS	RT06128SXH03SS
Y	RT06128SYHSS	RT06128SYH03SS
Z	RT06128SZHSS	RT06128SZH03SS

- NOTES :
1. MATERIAL :  
SHELL : ZINC ALLOY , NICKEL PLATED.  
INSERT : THERMOPLASTIC , UL94 V-0.  
COUPLING NUT : AL ALLOY , NICKEL PLATED.  
SEAL GASKET : SILICONE RUBBER.  
O-RING : NBR/SILICONE RUBBER.
  2. SPECIFICATIONS :  
2.1 RATED CURRENT : 13A (MAX).  
2.2 RATED VOLTAGE : 300V ( AC/DC ).  
2.3 OPERATING TEMPERATURE : SEE CHART.  
2.4 DIELECTRIC WITHSTANDING VOLTAGE : LESS THAN 2 MILLIAMPS CURRENT LEAKAGE@2000 VOLTS AC.  
2.5 INSULATION RESISTANCE : 5000 MEGOHMS MIN.  
2.6 IP--CLASS : IP67 AND IP69K.  
2.7 MATING CYCLES DURABILITY : 500 CYCLES MIN.  
2.8 RoHS COMPLIANT.
  3. SUITABLE CONTACTS : 16# CONTACTS.
  4. ALL DIMENSIONS ARE FOR REFERENCE USE ONLY.

QUANTITY	SEE PART NUMBER CHART	PART NUMBER	DESCRIPTION	ITEM
<b>MATERIALS LIST</b>				
UNLESS OTHERWISE SPECIFIED 1) All dimensions are in millimeters. 2) Tolerances are as follows: 1 Pt. DEC 240.30 Fractions 1/16" 3 Pt. DEC 240.08 Angles 1° 3) Note reference =				
MATERIAL SPECIFICATIONS: CUSTOMER: Tommy Jun-28-2017 APPROVAL: Tommy Jun-28-2017				
PROCESS SPECIFICATIONS: NEXT ASSY:				
THIS DRAWING IS SUPERSEDED BY THE LATEST REVISIONS. SPECIFICATIONS AND PERFORMANCE DATA ARE THE PROPERTY OF SINE SYSTEMS, INC. ALL RIGHTS OF REPRODUCTION ARE RESERVED. ALL MANUFACTURING VARIATIONS.				
SIZE TYPE DWG NO. <b>B C-</b>		RT PLUG SOCKET 8POS, SIZE 12		
SCALE: NONE		<b>Amphenol</b> Sine Systems - www.amphenol-sine.com 44724 Morley Drive Clinton Township, MI 48036		
SHEET 1 OF 1		REVISION: A1 DWG NO.: RT06128S*H*SS TITLE: RT PLUG SOCKET 8POS, SIZE 12		