

NOTES:

- PHYSICAL CHARACTERISTICS
- INSULATOR MATERIAL : LCP 30% GF
 - CONTACT MATERIAL : COPPER ALLOY
 - GROUNDING MATERIAL : BRASS

- ELECTRICAL CHARACTERISTICS
- NOMINAL CURRENT : 5A (STANDARD CONDITIONS)
 - CONTACT RESISTANCE : <25mΩ
 - VOLTAGE PROOF : >1000 V.r.m.s.
 - RATED VOLTAGE : 300 V.r.m.s.
 - Insulation resistance : >5000MΩ
 - Creepage and clearance distance : >1mm
 - Average wiping length : 2mm

COPLANARITY AREA OF TERMINATION : ≤0.1mm

NOTE RoHS INFORMATIONS

- The "LF" products meet European union Directives and other country regulations as described in GS-47-0004
- The housing will withstand exposure to 260 C peak temperature for 3.5 seconds in a reflow solder application with a 1.6 mm minimum thick circuit board. See application notes/procedures if they are available.

RECOMMENDED PCB LAYOUT(1.6mm)

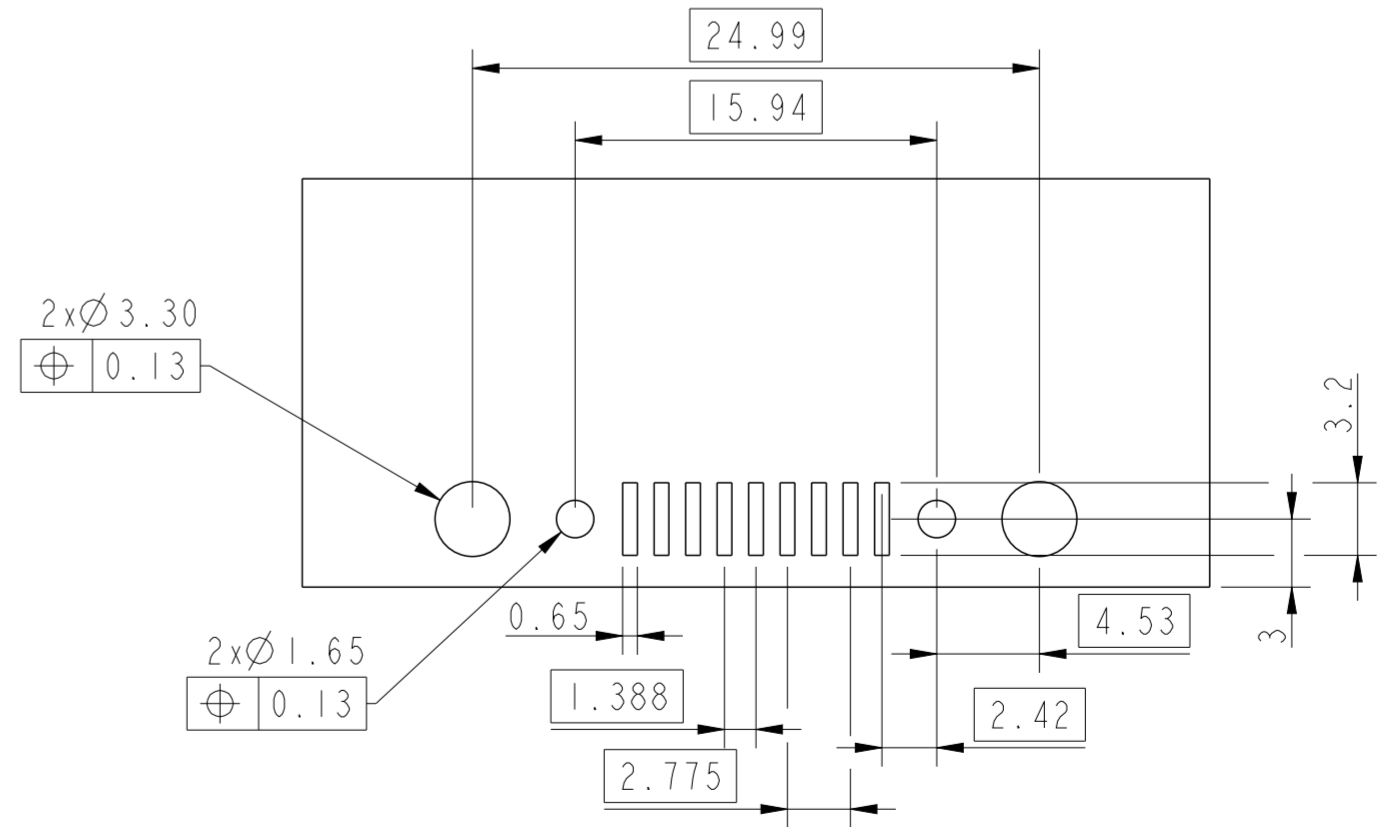

PART NUMBER	DESCRIPTION
D09P7IS6GA00LF	Harpoons + Std.Hole + ele.continuity + Tray packing
D09P7IS6GA12LF	Harpoons + Std.Hole + ele.continuity + Tape & Reel packing
D09P7IS6GX12LF	Harpoons + Insert UNC 4-40 + ele.continuity + Tape & Reel packing
D09P7IS6GL12LF	Harpoons + Insert M3 + ele.continuity + Tape & Reel packing

spec ref	dr Sreeraj K-R	2020/05/14	projection	mm	size A2	scale 4:1
tolerance std	eng Gregar Mathew	2020/05/14		mm	ecn no	rel level Released
ISO 406	chr					
ISO 1302	appr Kuriakosa, San	2020/05/14	product family	D SUB		
surface	linear	0.X ±0.1 0.XX ±0.05 0.XXX ±	Amphenol FCI		title	09 position Male connector
ISO 1302	angular	0° ±2°	Amphenol FCI		D-Sub SMT Slimline	dwg no 10155375
			cat. no.	Product - Customer Drw	sheet 1 of 1	rev A

Amphenol FCI

© 2016 AFCI