

| REVISION HISTORY |             |       |          |
|------------------|-------------|-------|----------|
| REV              | DESCRIPTION | DATE  | APPROVED |
| -                | NRN 45757   | 04/21 | SEE PDM  |
| A                | DCN 50729   | 04/21 |          |

# PRODUCT DATA DRAWING

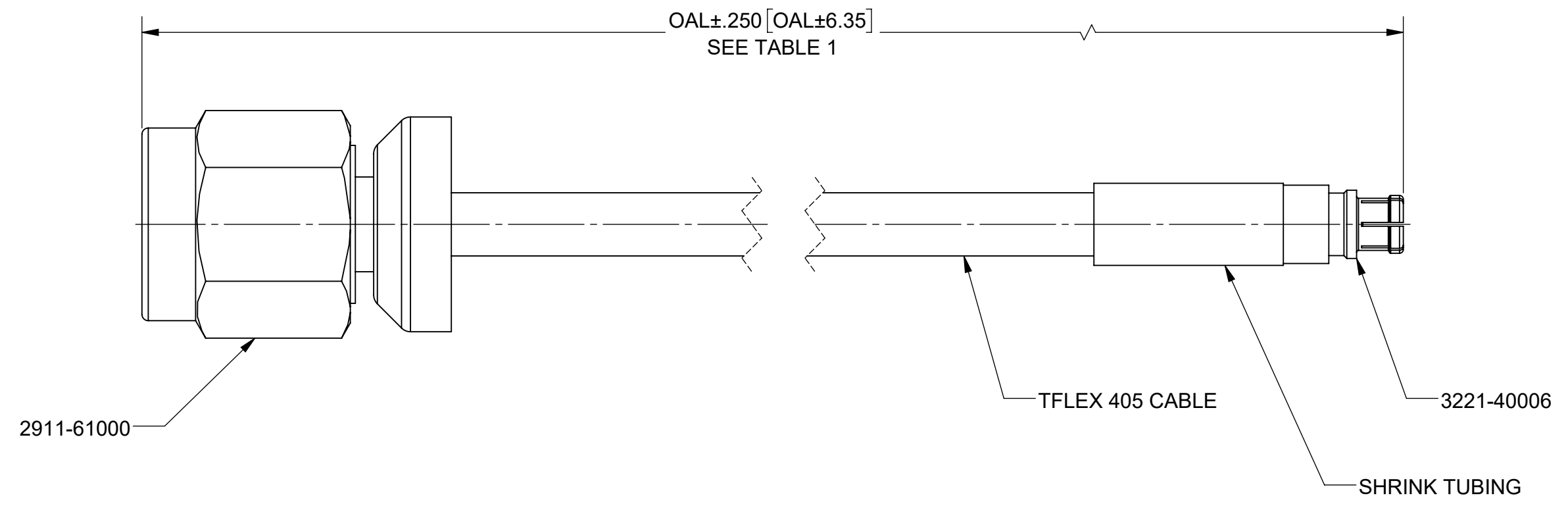
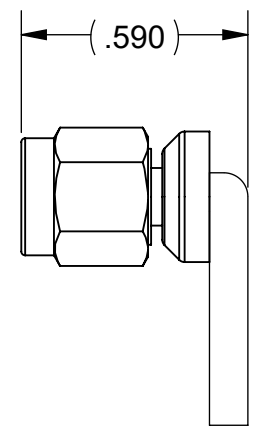

| SV P/N    | OAL     |
|-----------|---------|
| 7029-3639 | 6.000"  |
| 7029-3640 | 12.000" |

**MATERIAL:**

CONNECTORS: 2911-61000 (SMA STRAIGHT MALE LOPRO RF)  
3221-40006 (SMPM STRAIGHT FEMALE)

CABLE: 200-70-139 (TFLEX 405 HF CABLE)

SHRINK TUBING: M23053/5 OR EQUIVALENT

**PERFORMANCE:**

IMPEDANCE: 50 OHMS  
FREQ. RANGE: DC TO 18 GHZ

|  |  |  |   |
|--|--|--|---|
| MATERIAL: PER BOM  | DIMENSIONS ARE IN INCHES TOLERANCES:<br>FRACTIONAL: ±1/64 ANGULAR: X° ±1°0'<br>X°X' ±15' | UNLESS OTHERWISE SPECIFIED<br>1) ALL DIMENSIONS ARE AFTER PLATING.<br>2) BREAK CORNERS & EDGES .005 R. MAX.<br>3) CHAM. 1ST & LAST THREADS.<br>4) SURFACE ROUGHNESS 63 / MIL-STD-10.<br>5) DIA.'S ON COMMON CENTERS TO BE CONCENTRIC WITHIN .005 T.I.R.<br>6) REMOVE ALL BURRS | <br>www.svmicrowave.com<br>Amphenol                               |
| FINISH: PER BOM  | DECIMAL: X ±.030<br>.XX ±.010<br>.XXX ±.005  | INTERPRET DIMENSIONS AND TOLERANCES PER ASME Y14.5M - 1994   |   |
| <b>PROPRIETARY</b><br>THE INFORMATION CONTAINED IN THIS DRAWING IS THE SOLE PROPERTY OF SV MICROWAVE, INC. ANY REPRODUCTION IN PART OR AS A WHOLE WITHOUT THE WRITTEN PERMISSION OF SV MICROWAVE, INC IS PROHIBITED. | THIRD ANGLE PROJECTION   | DRAWN: TSW 04/20/21  | TITLE: SMA STR. M TO SMPM STR. F TFLEX405 LOPRO RF CABLE ASSEMBLY |
|  |  | CHECKED: SEE PDM   | SIZE DWG. NO. <b>B</b> 7029-3639-3640.PDD                         |
|  |  | APPROVED: SEE PDM  | E.M. SIMULATION: N/A  |