

TABLE OF CONTENTS	
SHEET NO.	SHEET DESCRIPTION
1	GENERAL NOTES
2	CONFIGURATIONS
3	ALL KEY CONFIGURATIONS
4	BLADE CONNECTOR ASSEMBLY
5	8W BOM
6	9W BOM
7	10W BOM

NOTES: VALID UNLESS OTHERWISE SPECIFIED

1. GENERAL:
- a. APPLICATION SPECIFICATION SEE: 1601110001-AS
- CONTAINS: PRODUCT INTRODUCTION, PRODUCT SUMMARY, CONNECTOR ASSEMBLY, PACKAGING INFORMATION, CONNECTOR MATING, SERVICE INSTRUCTIONS, ELECTRICAL CONTINUITY CHECKING, CRIMPING, AND TROUBLESHOOTING.
  - DESIGNED TO MATE WITH CONNECTOR AS SPECIFIED IN THE MATING CONNECTOR DRAWINGS CHART.
  - FOR TERMINALS TO BE USED WITH THIS ASSEMBLY SEE MOLEX DRAWING TBD.
  - SYSTEM TO BE USED WITH WIRE WITHIN DIAMETER RANGE OF 1.2 mm TO 2.69 mm.
  - ASSEMBLY SHIPPED WITH PLR IN PRE-LOCK POSITION (SEE PLR PRE-LOCK VIEW SHEET 5).

- b. PRODUCT SPECIFICATION SEE: 1600760001-PS
- CONTAINS: PRODUCT INTRODUCTION, PRODUCT SUMMARY, RATINGS (CURRENT, TEMPERATURE, SEALING, AND FLAMMABILITY), AND PRODUCT VALIDATION.
- c. PACKAGING SPECIFICATION PER MOLEX DRAWING: SEE PACKAGING CHART
- d. PARTS MUST BE IN COMPLIANCE TO MOLEX CHEMICAL SUBSTANCES FOR PRODUCTS AND PACKAGING SPECIFICATION: QEHS-699000-300
- e. DATA MUST BE SUBMITTED UNDER THE MOLEX PART NUMBER TO IMDS (COMPANY ID#13255)

2. DESIGN - MATERIALS:
- a. SEE BOM TABLE (SHEET 4)

3. DESIGN - GEOMETRY:
- a. ALL GRAPHIC DATA IS BASIC (NO TOLERANCE) AND MUST BE TAKEN FROM THE DATA FILE AT ITS LATEST REVISION.
- b. GEOMETRIC DIMENSIONS AND TOLERANCES PER ASME Y14.5M-2009
- c. EDGES AND UNDIMENSIONED DETAILS PER ISO13715
- d. CORNERS SHOWN AS SHARP TO BE R 0.2 MAX.
- e. LETTERING SHALL BE 0.15 MAX RAISED IN 0.25 MAX RECESS PAD. THIS INCLUDES RECYCLING CODE, CAVITY ID, VENDOR IDENTIFICATION, AND CUSTOMER MATERIAL NUMBER.
- f. VISUAL DEFECTS SHALL MEET COSMETIC STANDARD PS-45499-002 (Class B).
- g. LASER MARKING:
- PART NUMBER
  - DAY OF THE YEAR
  - SHIFT
  - YEAR
- FOR ADDITIONAL INFORMATION REFERENCE SECTION 5 UNDER PROCEDURES IN ES-34735-008.
- h. PRODUCT DESIGN MODEL NUMBER: SEE BOM TABLE

PACKAGING	
DESCRIPTION	DRAWING NO.
10 WAY HYBRID (1.5/2.8)	PK-31300-635
8 WAY HYBRID (1.5/6.3)	
9 WAY HYBRID (1.5/2.8/6.3)	

MATING CONNECTOR DRAWINGS	
DESCRIPTION	MOLEX INLINE
10 WAY HYBRID (1.5/2.8)	SD-160076-0001
8 WAY HYBRID (1.5/6.3)	
9 WAY HYBRID (1.5/2.8/6.3)	

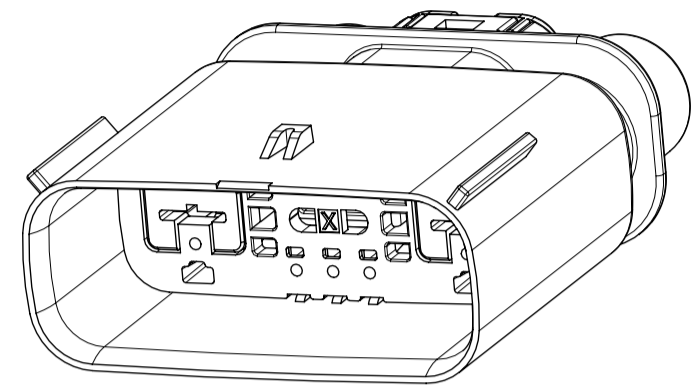

8W HYBRID

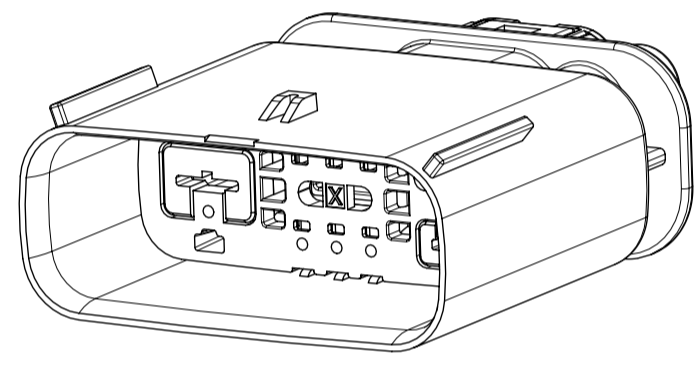

9W HYBRID

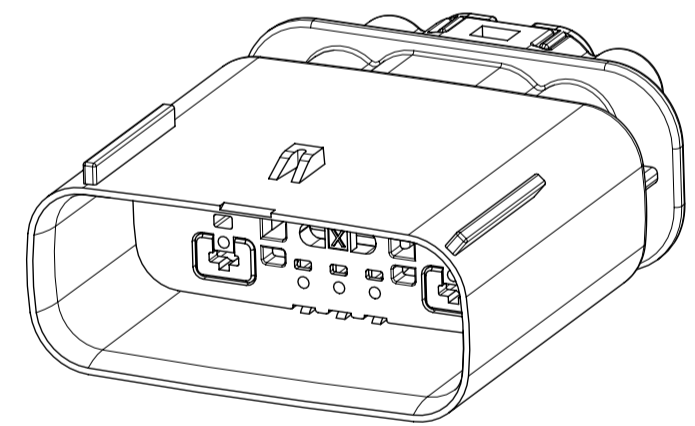

10W HYBRID

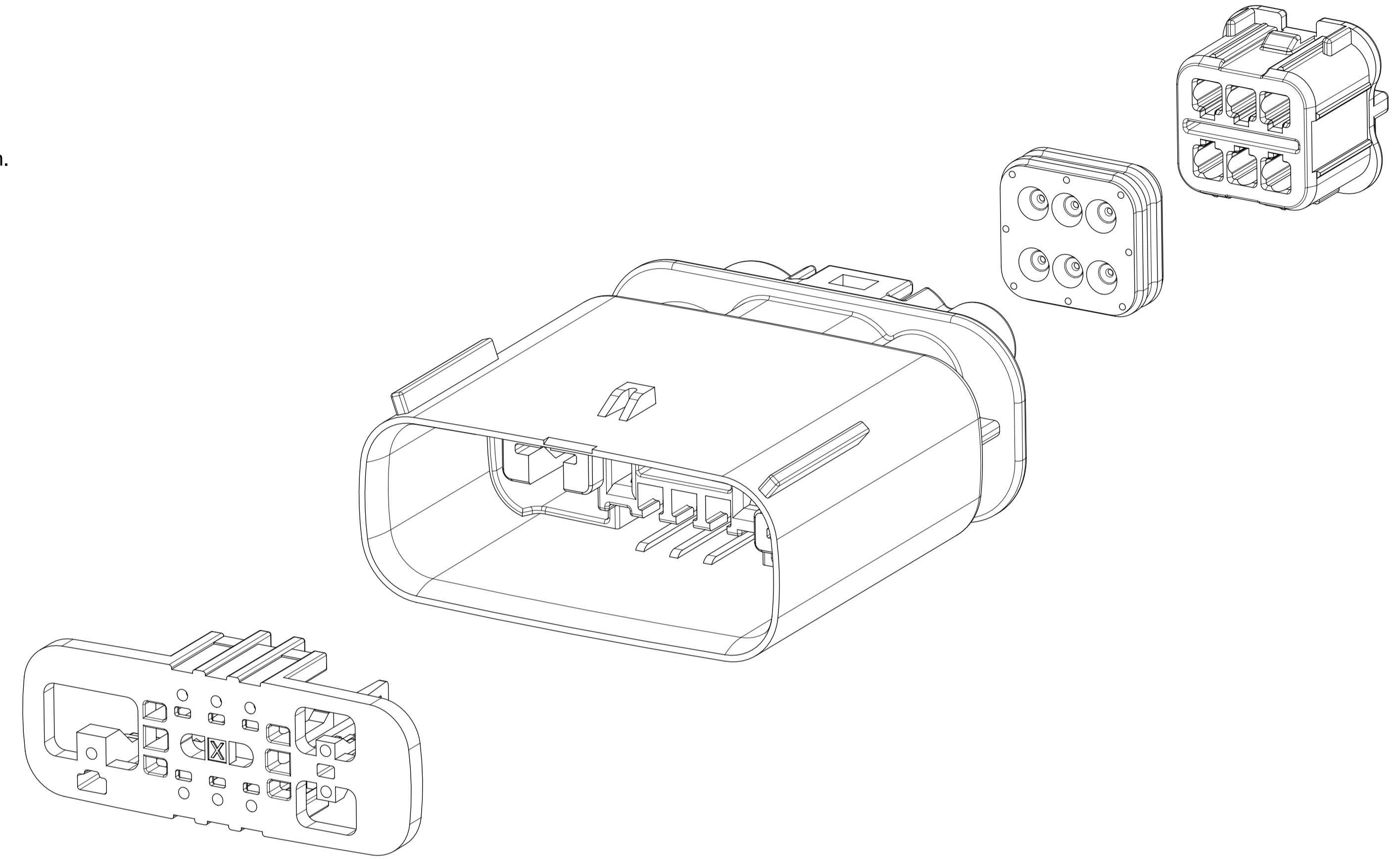

A3	UPDATED STATUS
A2	UPDATED DIMS 3,4,5
A1	UPDATED DIM 5 TOLERANCE
A	RELEASE FOR PRODUCTION
5	UPDATED DESIGN
4	MIGRATED DRAWING TO NX
3	UPDATED DESIGN
2	UPDATED VIEWS
1	INITIAL RELEASE
Rev	REV DISCRPTION

INSPECTION NUMBER LOG	
LAST NUMBER: 5	
ADDED:	
REMOVED:	

FUNCTIONAL SYMBOLS	THIS DRAWING CONTAINS INFORMATION THAT IS PROPRIETARY TO MOLEX ELECTRONIC TECHNOLOGIES, LLC AND SHOULD NOT BE USED WITHOUT WRITTEN PERMISSION	CURRENT REV DESC: Changed the document restriction to General Market.					
	DIMENSION UNITS	SCALE	STATUS: Production				PRODUCT SALES DRAWING
	$\frac{E}{A} = 0$	mm	1.5:1	DRWN: Mahesh KP	DOCUMENT NUMBER		
	$\frac{E}{C} = 0$	GENERAL TOLERANCES (UNLESS SPECIFIED)		CHK'D: Ryan Dunn	DOC TYPE   DOC PART   REVISION		
$\frac{E}{P} = 0$	ANGULAR TOL $\pm$ 0.5°		APPR: Ryan Dunn	1600770001   PSD   000   A5			
DIVISIONAL SYMBOLS	4 PLACES $\pm$		2023-03-21	MATERIAL NUMBER			
	3 PLACES $\pm$		2023-03-21	CUSTOMER			
	2 PLACES $\pm$		2023-03-21	GENERAL MARKET			
	1 PLACE $\pm$			SHEET NUMBER			
	0 PLACES $\pm$			1 OF 7			
	DRAFT WHERE APPLICABLE MUST REMAIN WITHIN DIMENSIONS		THIRD ANGLE PROJECTION	DRAWING	SERIES		
				A1-SIZE	160077		

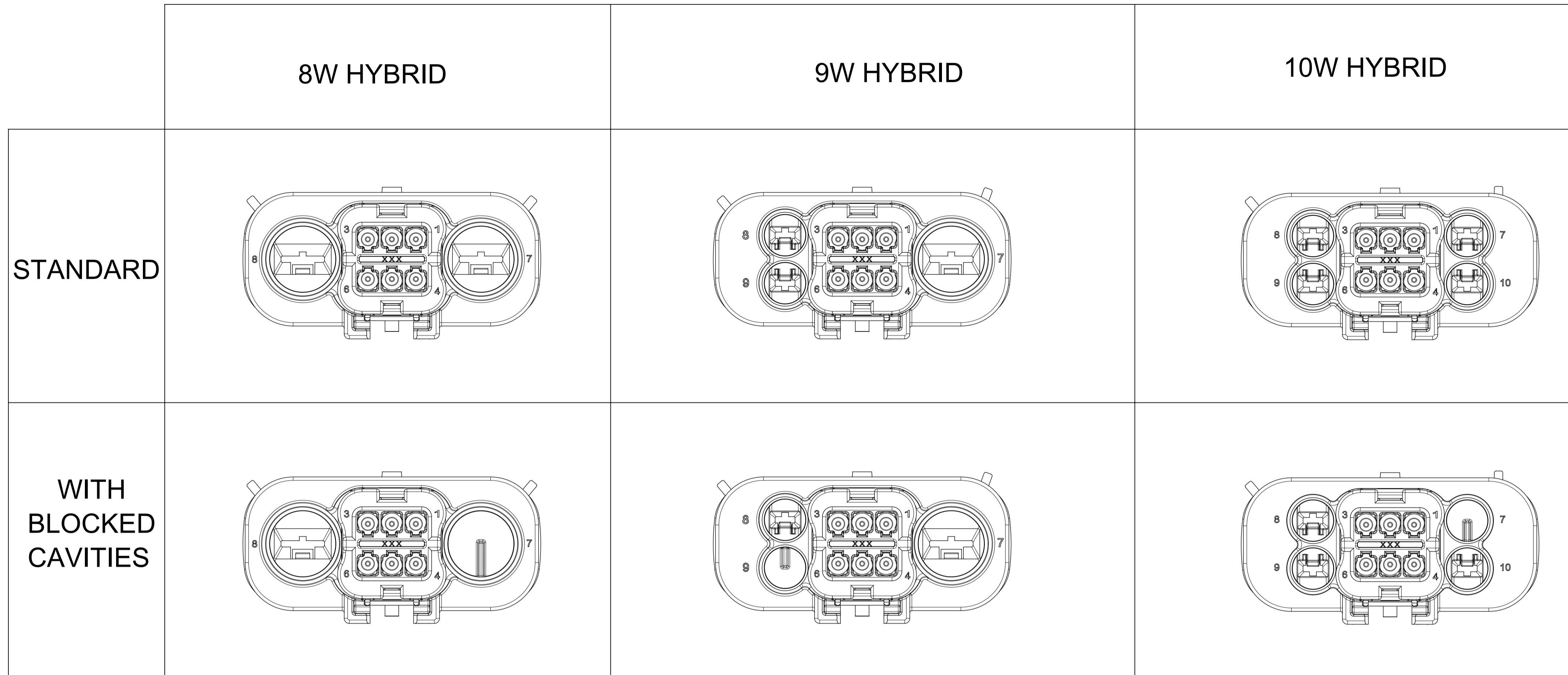

<b>FUNCTIONAL SYMBOLS</b> $\frac{E}{A} = 0$ $\frac{E}{C} = 0$ $\frac{E}{P} = 0$	THIS DRAWING CONTAINS INFORMATION THAT IS PROPRIETARY TO MOLEX ELECTRONIC TECHNOLOGIES, LLC AND SHOULD NOT BE USED WITHOUT WRITTEN PERMISSION CURRENT REV DESC: Changed the document restriction to General Market.	 MX150 HYBRID BLADE DUAL ROW SEALED ASSY DUAL ROW SEALED ASSEMBLY MAT SEAL		
	DIMENSION UNITS: <b>mm</b> SCALE: <b>2.5:1</b> GENERAL TOLERANCES (UNLESS SPECIFIED) ANGULAR TOL $\pm 0.5^\circ$			
<b>DIVISIONAL SYMBOLS</b> 4 PLACES $\pm$ 3 PLACES $\pm$ 2 PLACES $\pm$ 1 PLACE $\pm$ 0 PLACES $\pm$	DRAFT WHERE APPLICABLE MUST REMAIN WITHIN DIMENSIONS THIRD ANGLE PROJECTION	DRAWING: <b>A1-SIZE</b> SERIES: <b>160077</b>	MATERIAL NUMBER: <b>1600770001</b> CUSTOMER: <b>GENERAL MARKET</b>	SHEET NUMBER: <b>2 OF 7</b>

8W HYBRID

9W HYBRID

10W HYBRID

KEY A

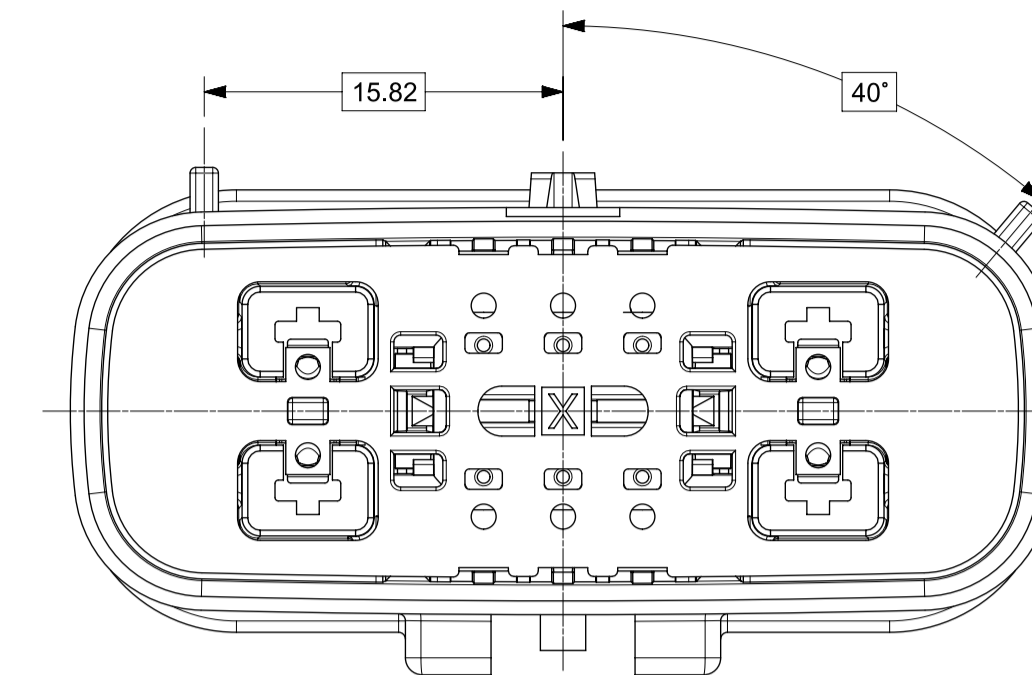
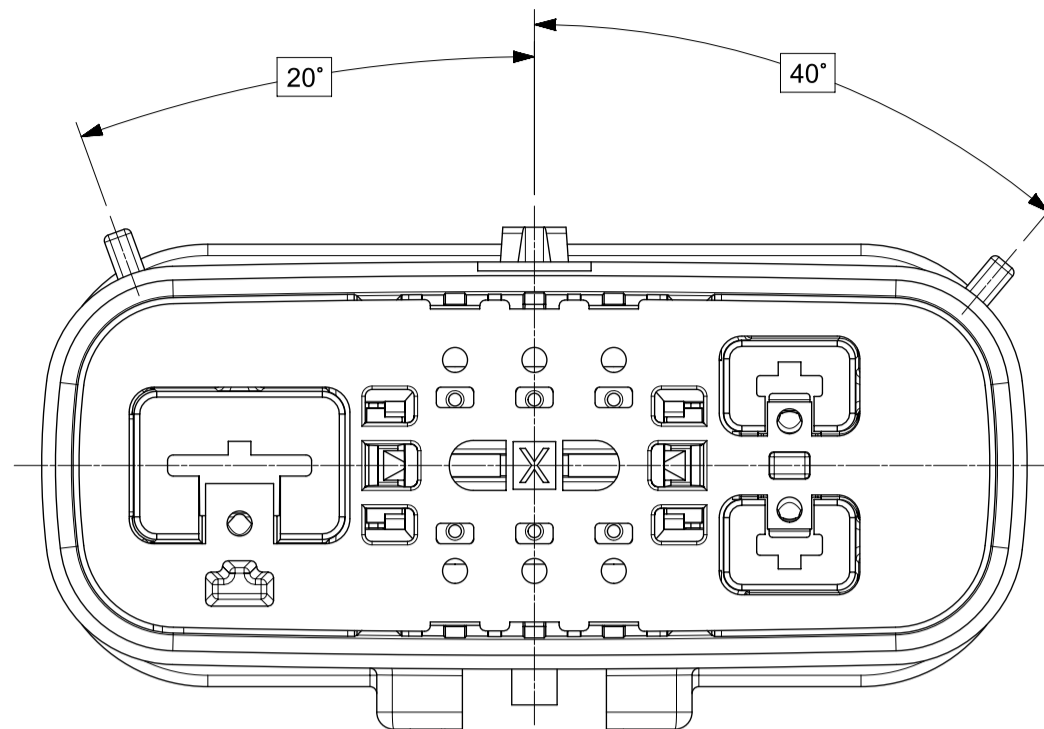
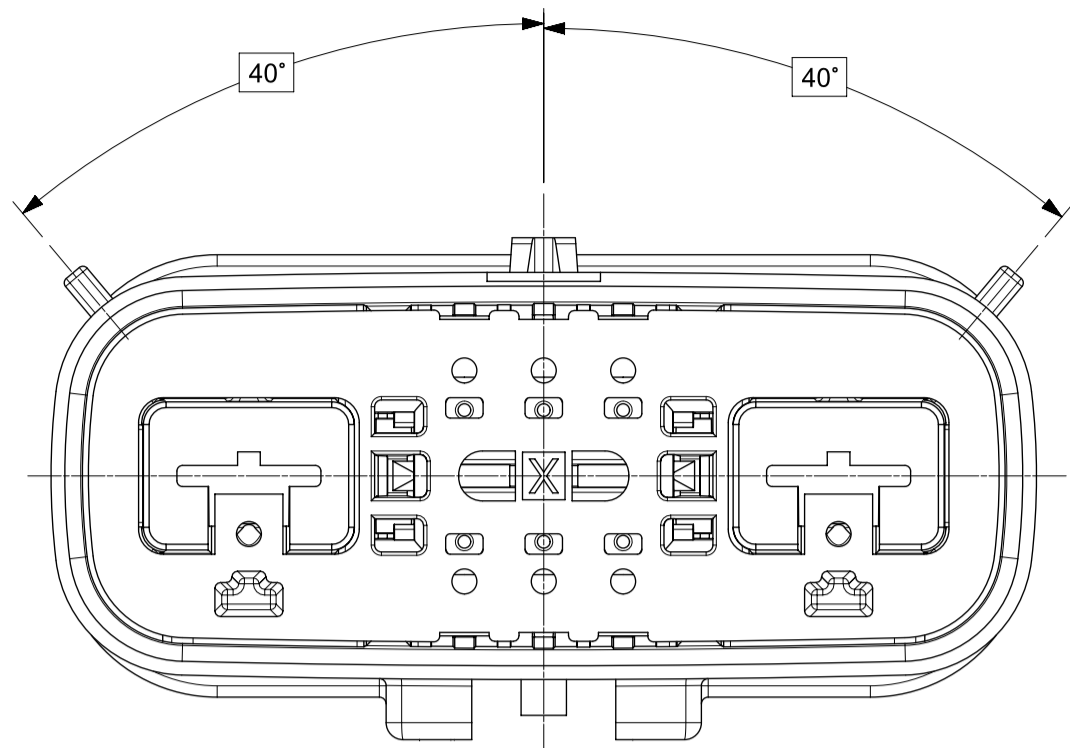

KEY B

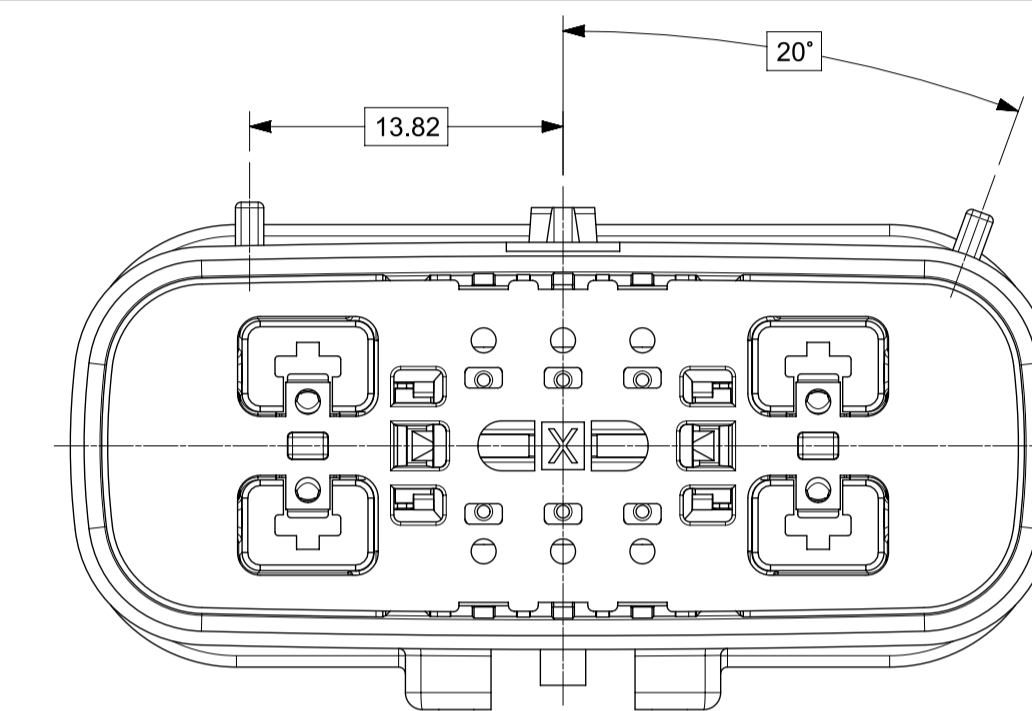
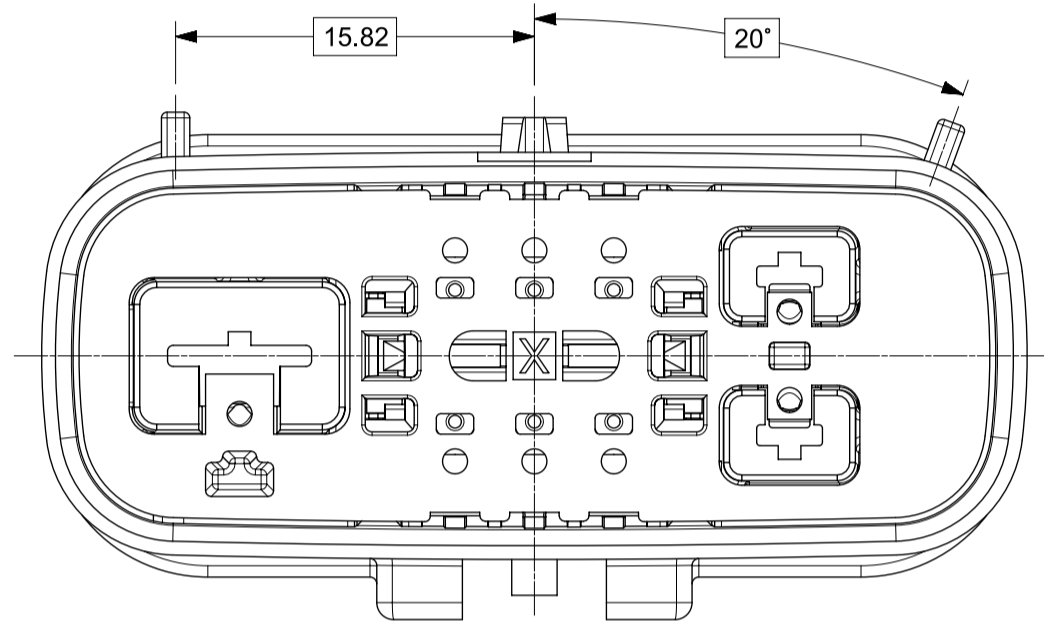
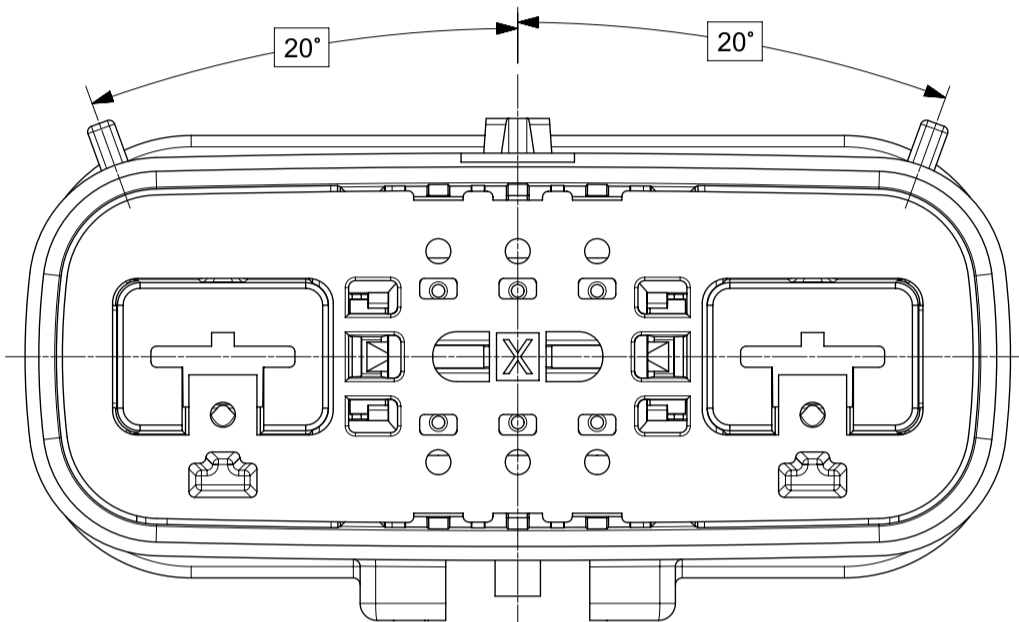

KEY C

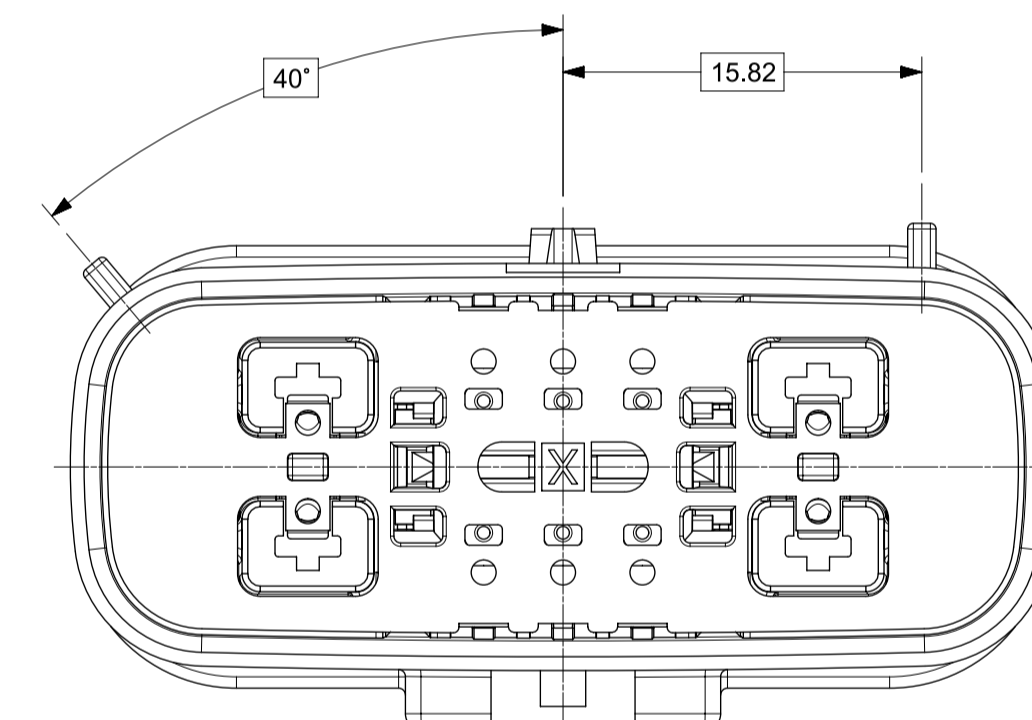
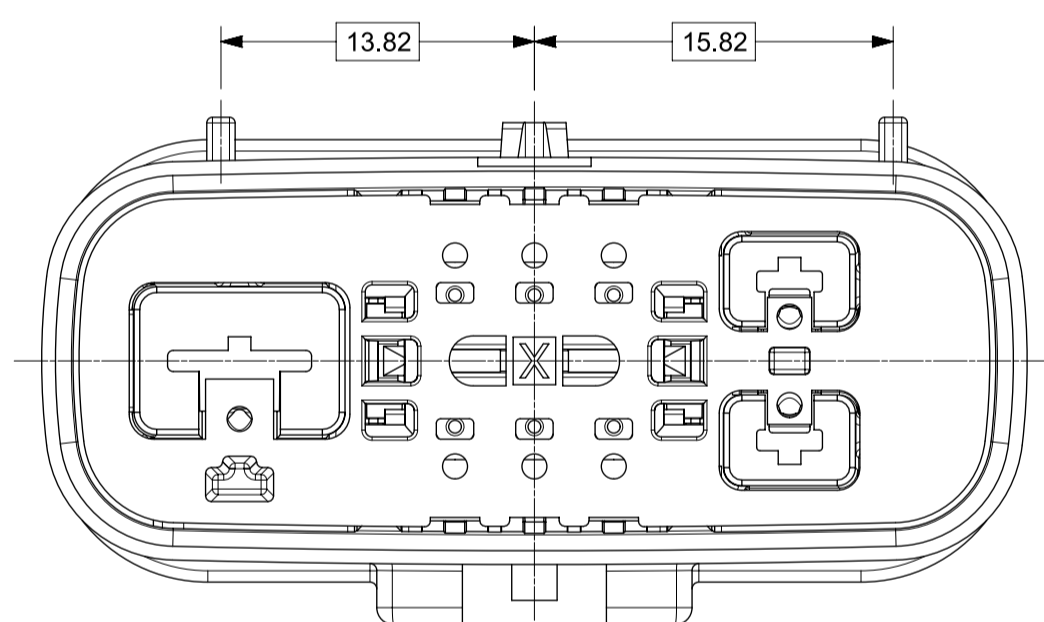
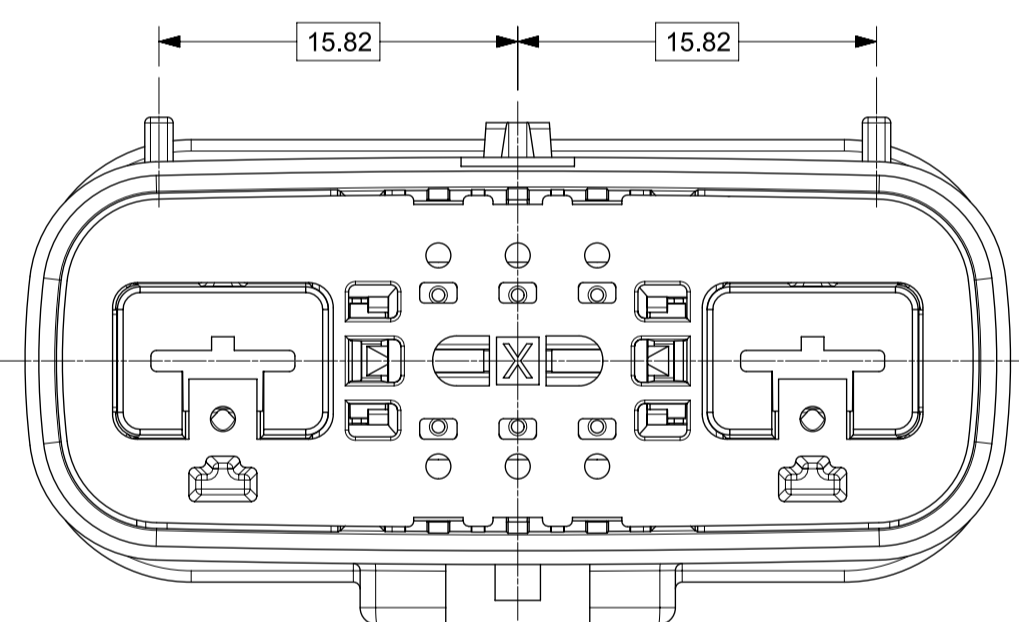

KEY D

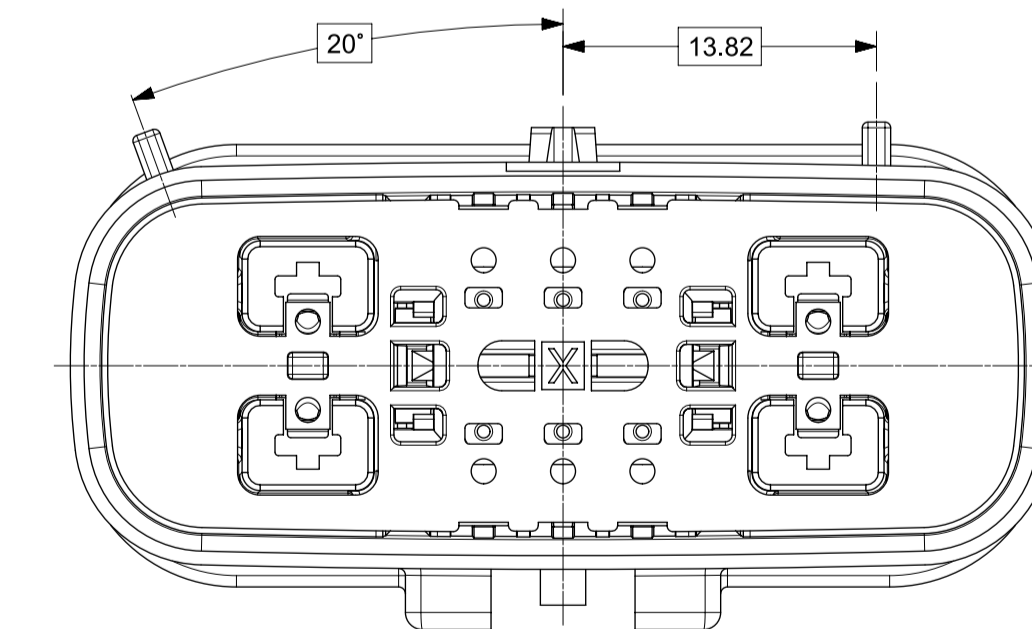
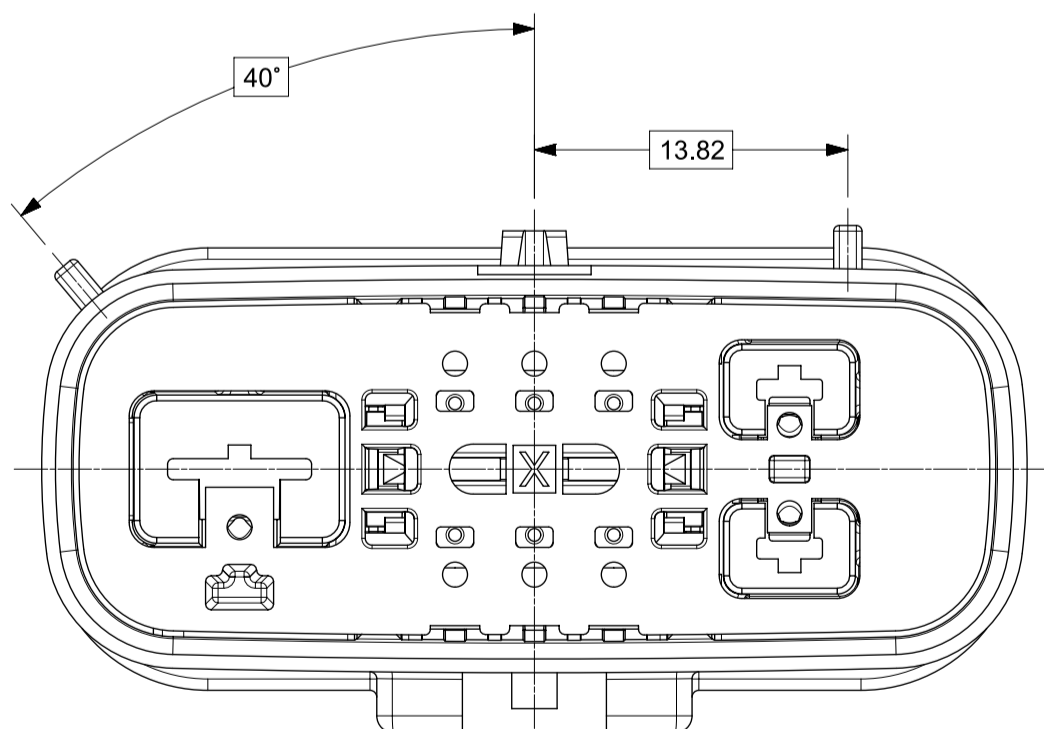
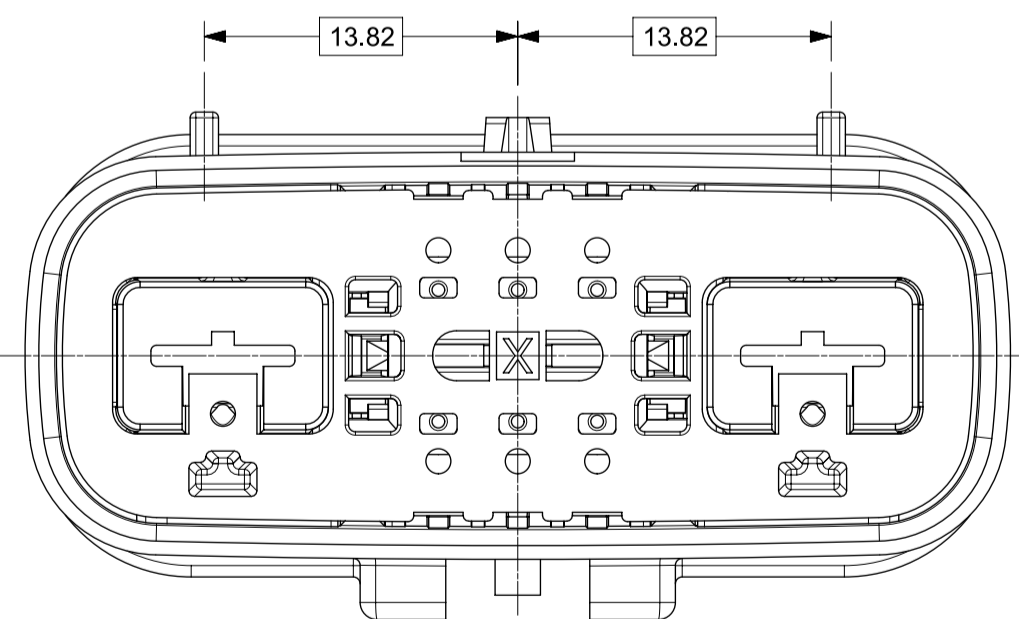

<b>FUNCTIONAL SYMBOLS</b> FA = 0 FE = 0 FP = 0 <b>DIVISIONAL SYMBOLS</b> 3 PLACES ± 2 PLACES ± 1 PLACE ± 0 PLACES ±	THIS DRAWING CONTAINS INFORMATION THAT IS PROPRIETARY TO MOLEX ELECTRONIC TECHNOLOGIES, LLC AND SHOULD NOT BE USED WITHOUT WRITTEN PERMISSION		CURRENT REV DESC: Changed the document restriction to General Market.	
	DIMENSION UNITS <b>mm</b>	SCALE <b>3:1</b>	GENERAL TOLERANCES (UNLESS SPECIFIED) ANGULAR TOL ± 0.5°	
	DRAFT WHERE APPLICABLE MUST REMAIN WITHIN DIMENSIONS		THIRD ANGLE PROJECTION 	DRAWING <b>A1-SIZE</b>
	STATUS: Production DRWN: Mahesh KP CHK'D: Ryan Dunn APPR: Ryan Dunn		2023-03-21 2023-03-21 2023-03-21	SERIES <b>160077</b>
		DOCUMENT NUMBER <b>1600770001</b>	DOC TYPE   DOC PART   REVISION <b>PSD   000   A5</b>	
		MATERIAL NUMBER CUSTOMER <b>GENERAL MARKET</b>	SHEET NUMBER <b>3 OF 7</b>	

**molex**

MX150 HYBRID BLADE DUAL ROW SEALED ASSY  
DUAL ROW SEALED ASSEMBLY MAT SEAL

PRODUCT SALES DRAWING

3 OF 7

SHEET DESCRIPTION  
BLADE CONNECTOR ASSEMBLY

DESCRIPTION	CHARTED DIMENSIONS						
	A	B	C	D	E	F	G
8 WAY HYBRID (1.5/6.3)	13.00	N/A	46.33	7	8	N/A	N/A
9 WAY HYBRID (1.5/2.8/6.3)	13.00	11.25	46.33	7	8	9	N/A
10 WAY HYBRID (1.5/2.8)	N/A	11.25	46.33	7	8	9	10

LASER MARKING ON THIS SURFACE  
SEE NOTE 3g

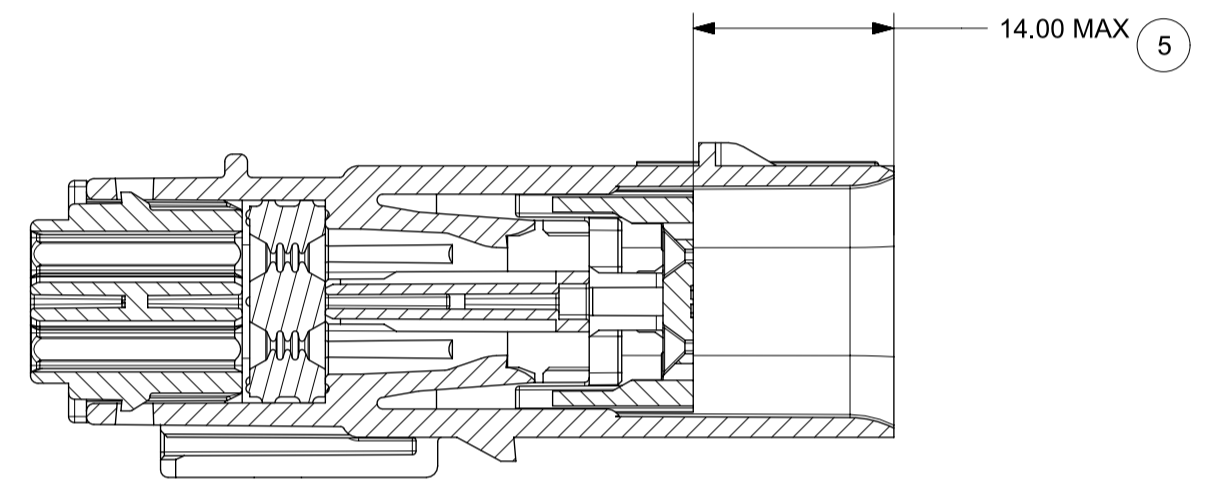
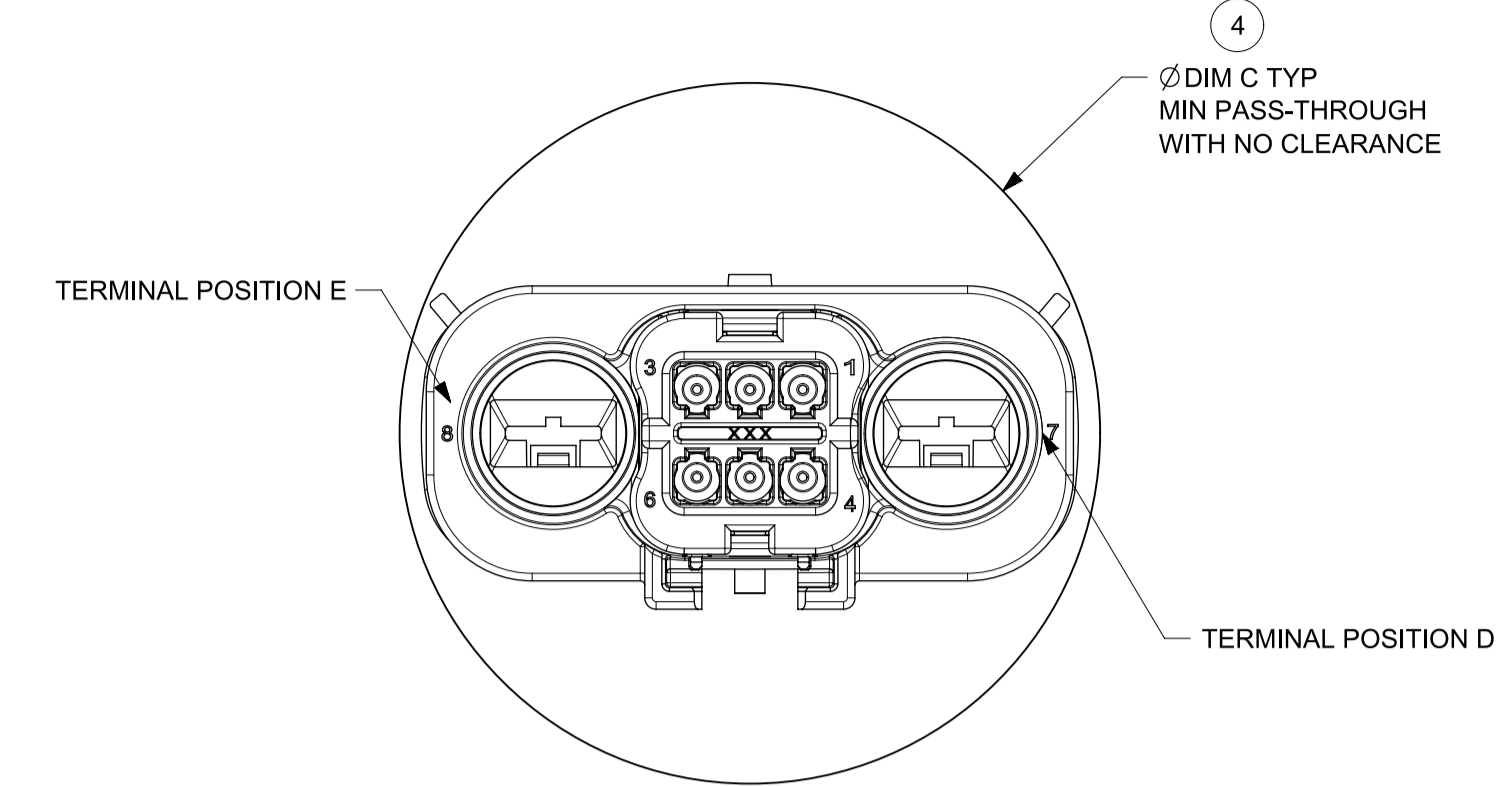
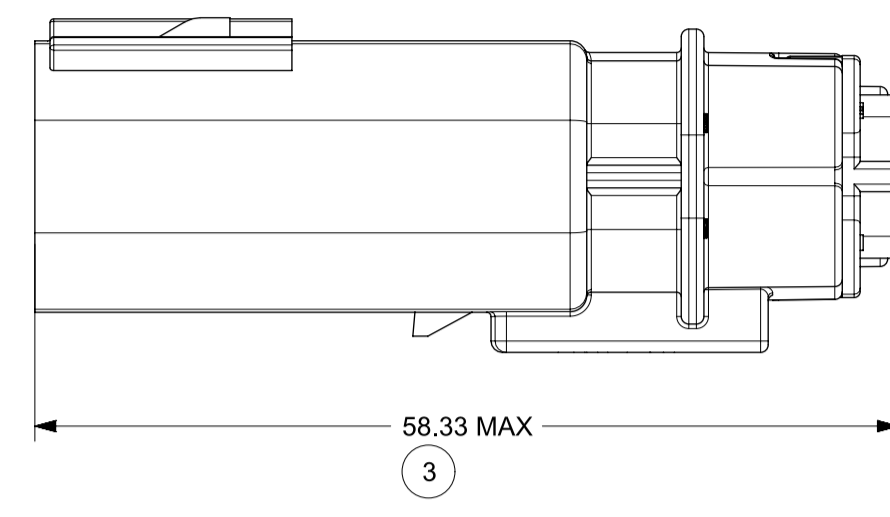
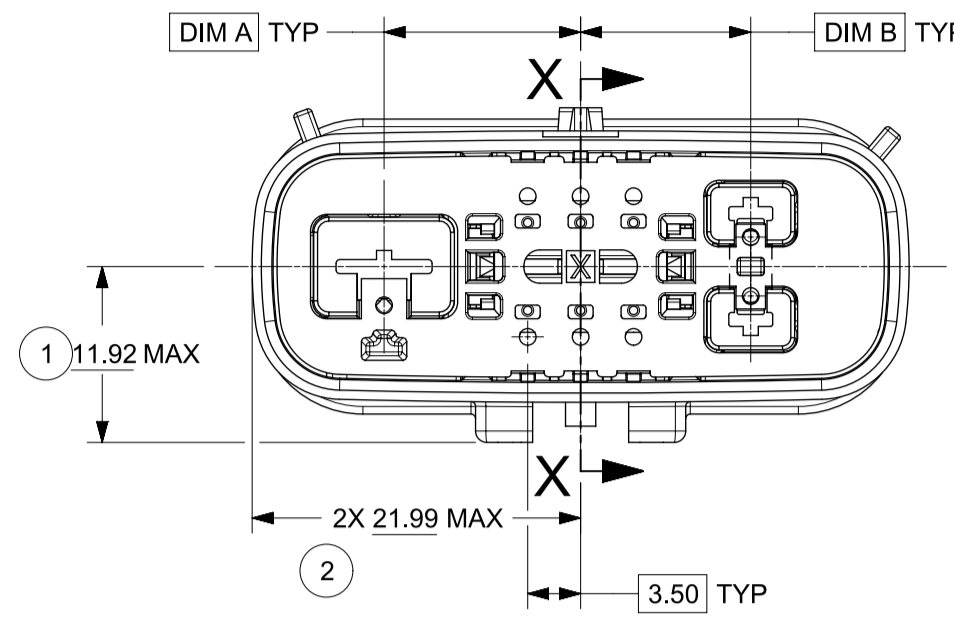
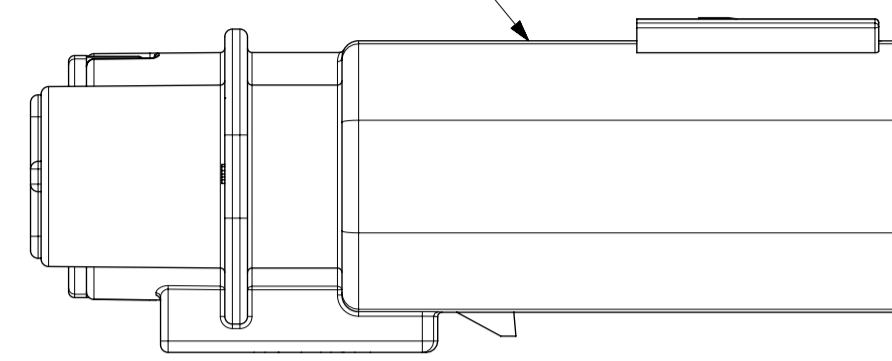

PRIMARY LOCK REINFORCEMENT (PLR)  
SHOWN IN PRE - STAGE POSITION  
SECTION Y-Y

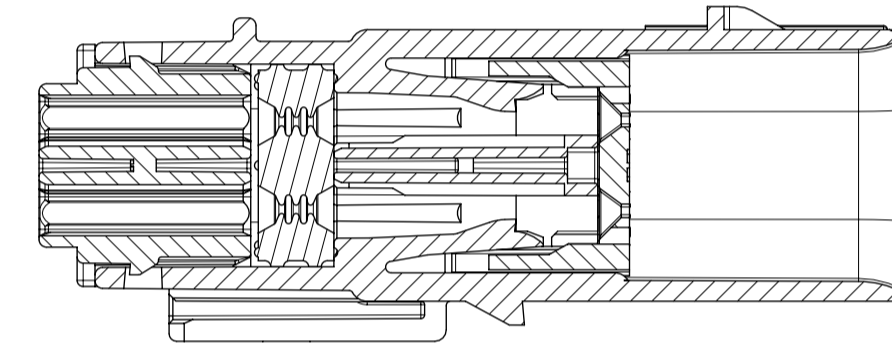

PRIMARY LOCK REINFORCEMENT (PLR)  
SHOWN IN FINAL - STAGE POSITION  
SECTION X-X

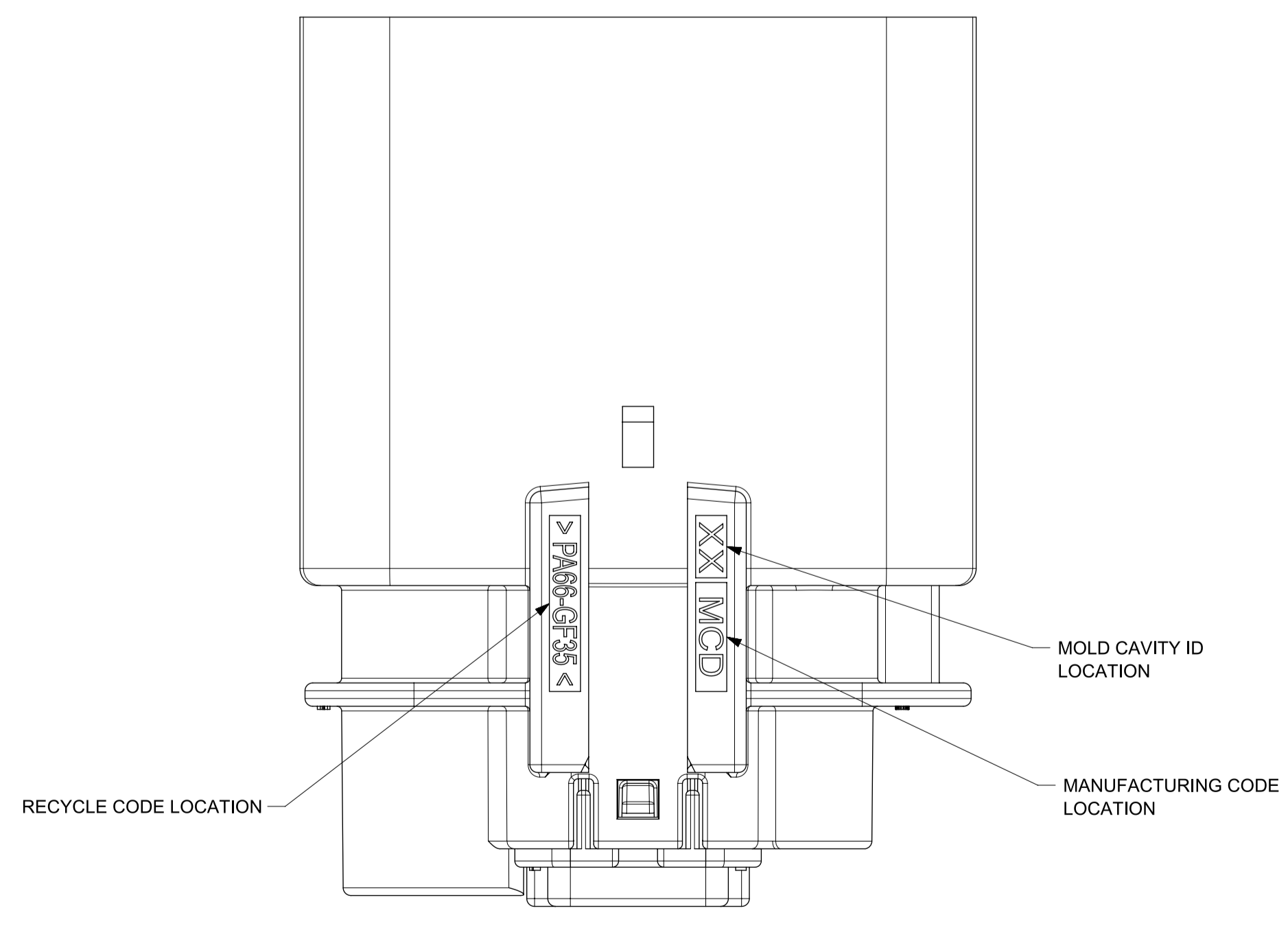
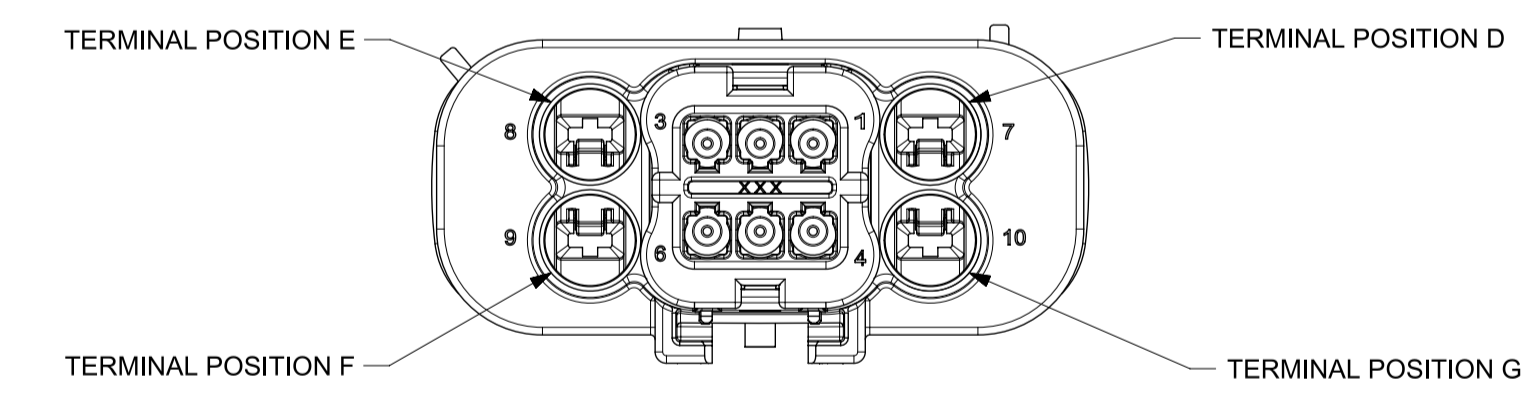
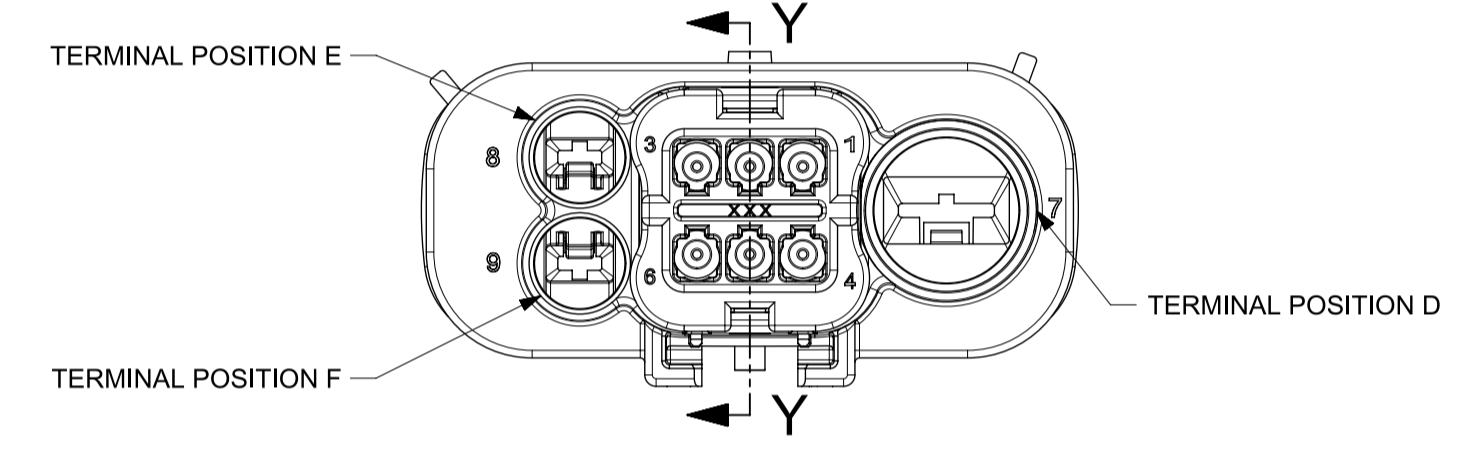

<b>FUNCTIONAL SYMBOLS</b> FA = 0 FC = 0 FP = 0 <b>DIVISIONAL SYMBOLS</b>	THIS DRAWING CONTAINS INFORMATION THAT IS PROPRIETARY TO MOLEX ELECTRONIC TECHNOLOGIES, LLC AND SHOULD NOT BE USED WITHOUT WRITTEN PERMISSION		CURRENT REV DESC: Changed the document restriction to General Market.					
	DIMENSION UNITS	SCALE	GENERAL TOLERANCES (UNLESS SPECIFIED)					
	mm	1:1	ANGULAR TOL ± 0.5°					
	4 PLACES ±	3 PLACES ±	STATUS: Production		DOCUMENT NUMBER	DOC TYPE	DOC PART	REVISION
2 PLACES ±	1 PLACE ±	DRWN: Mahesh KP		1600770001	PSD	000	A5	
0 PLACES ±	DRAFT WHERE APPLICABLE MUST REMAIN WITHIN DIMENSIONS		CHK'D: Ryan Dunn		PRODUCT SALES DRAWING			
THIRD ANGLE PROJECTION		DRAWING		SERIES		CUSTOMER		SHEET NUMBER
		A1-SIZE		160077		GENERAL MARKET		4 OF 7

**MX150 8W HYBRID BLADE**

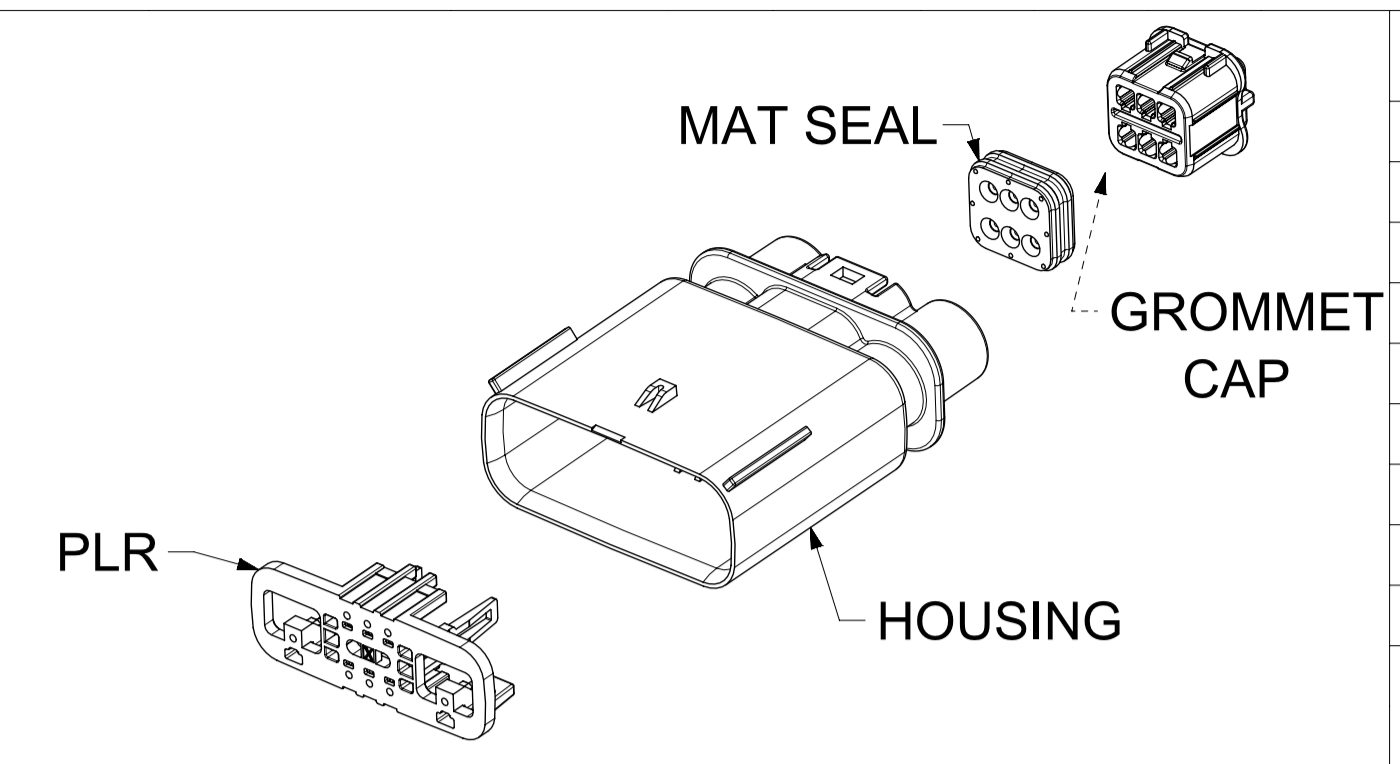
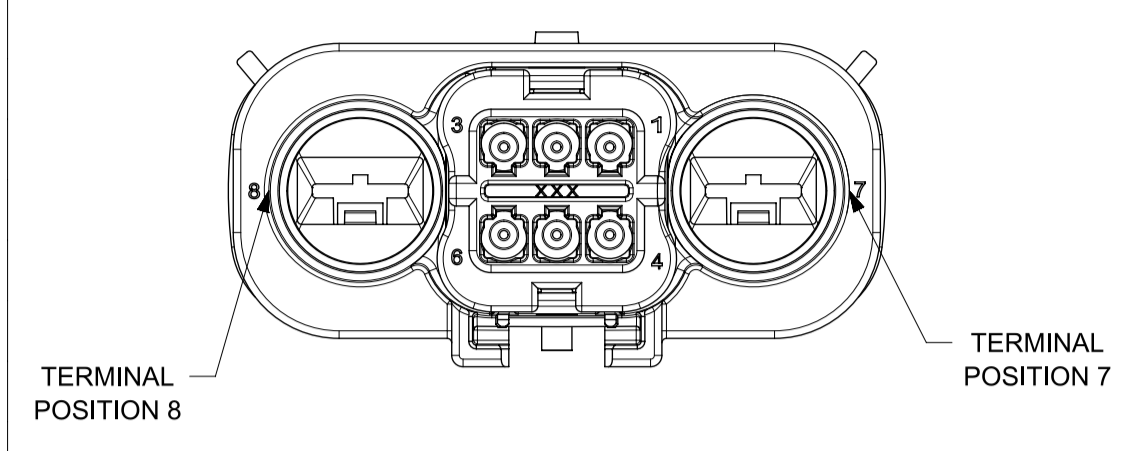

ABBREVIATION	DESCRIPTION	COLOR	MATERIAL
A-BLK	HOUSING KEYING OPTION A	BLACK	DSM PA66 GF35
B-LG	HOUSING KEYING OPTION B	LIGHT GRAY	DSM PA66 GF35
C-DG	HOUSING KEYING OPTION C	DARK GRAY	DSM PA66 GF35
D-SG	HOUSING KEYING OPTION D	STONE GRAY	DSM PA66 GF35
A-BLK	HOUSING KEYING OPTION A - BLOCKED	BLACK	DSM PA66 GF35
GCP	GROMMET CAP (PLUGGED)	BLACK	DSM PA66 GF35
GCO	GROMMET CAP (OPEN)	BLACK	DSM PA66 GF35
PLR	PLR	NATURAL	DSM PA66 GF35
M	MAT SEAL	RUST RED	INHERENTLY LUBRICATED SILICONE

ASSEMBLY DESCRIPTION	ASSEMBLY PART NUMBER	COMPONENT				BLOCKED TERMINALS								STATUS	COMMENTS	OPTIONAL ATTACHMENTS SOLD SEPERATELY			
		THE PRESENCE OF AN ABBREVIATION INDICATES THE PRESENCE OF THAT COMPONENT.				CAVITY WITH A NUMBER INDICATES BLOCKED TERMINAL POSITION CAVITY WITHOUT A NUMBER INDICATES OPEN TERMINAL POSITION										BACKSHELL WITH RIBS	BACKSHELL WITHOUT RIBS		
		HOUSING KEY/COLOR	GROMMET CAP	PLR	MAT SEAL	1	2	3	4	5	6	7	8						
KEY A, BLACK	160079-3001	A-BLK	GCP	PLR	M														
KEY B, LIGHT GRAY	160079-3002	B-LG	GCP	PLR	M														
KEY C, DARK GRAY	160079-3003	C-DG	GCP	PLR	M														
KEY D, STONE GRAY	160079-3004	D-SG	GCP	PLR	M														
KEY A BLOCKED, BLACK	160079-3005	A-BLK	GCP	PLR	M									7					

<b>FUNCTIONAL SYMBOLS</b> FA = 0 FC = 0 FP = 0 <b>DIVISIONAL SYMBOLS</b> 2 PLACES ± 1 PLACE ± 0 PLACES ±	THIS DRAWING CONTAINS INFORMATION THAT IS PROPRIETARY TO MOLEX ELECTRONIC TECHNOLOGIES, LLC AND SHOULD NOT BE USED WITHOUT WRITTEN PERMISSION		DIMENSION UNITS: <b>mm</b> SCALE: <b>1:1</b>		CURRENT REV DESC: Changed the document restriction to General Market.				
	GENERAL TOLERANCES (UNLESS SPECIFIED) ANGULAR TOL ± 0.5°		4 PLACES ± 3 PLACES ±		STATUS: Production DRWN: Mahesh KP CHK'D: Ryan Dunn APPR: Ryan Dunn				
	DRAFT WHERE APPLICABLE MUST REMAIN WITHIN DIMENSIONS		THIRD ANGLE PROJECTION		DRAWING: <b>A1-SIZE</b> SERIES: <b>160077</b>		DOCUMENT NUMBER: <b>1600770001</b> DOC TYPE: PSD DOC PART: 000 REVISION: <b>A5</b>		
							MATERIAL NUMBER: _____ CUSTOMER: <b>GENERAL MARKET</b> SHEET NUMBER: <b>5 OF 7</b>		

SHEET DESCRIPTION  
9W BILL OF MATERIALS

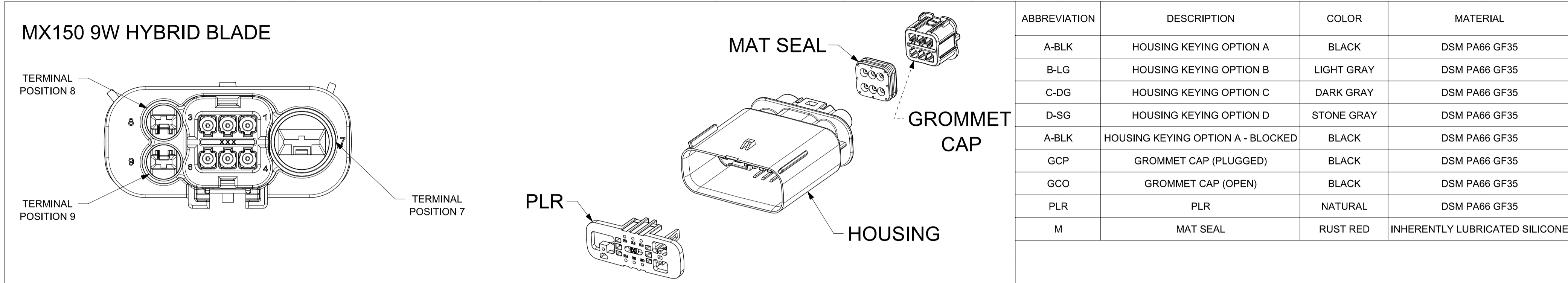

ABBREVIATION	DESCRIPTION	COLOR	MATERIAL
A-BLK	HOUSING KEYING OPTION A	BLACK	DSM PA66 GF35
B-LG	HOUSING KEYING OPTION B	LIGHT GRAY	DSM PA66 GF35
C-DG	HOUSING KEYING OPTION C	DARK GRAY	DSM PA66 GF35
D-SG	HOUSING KEYING OPTION D	STONE GRAY	DSM PA66 GF35
A-BLK	HOUSING KEYING OPTION A - BLOCKED	BLACK	DSM PA66 GF35
GCP	GROMMET CAP (PLUGGED)	BLACK	DSM PA66 GF35
GCO	GROMMET CAP (OPEN)	BLACK	DSM PA66 GF35
PLR	PLR	NATURAL	DSM PA66 GF35
M	MAT SEAL	RUST RED	INHERENTLY LUBRICATED SILICONE

ASSEMBLY DESCRIPTION	ASSEMBLY PART NUMBER	COMPONENT				BLOCKED TERMINALS									STATUS	COMMENTS	OPTIONAL ATTACHMENTS SOLD SEPERATELY	
		THE PRESENCE OF AN ABBREVIATION INDICATES THE PRESENCE OF THAT COMPONENT.				CAVITY WITH A NUMBER INDICATES BLOCKED TERMINAL POSITION CAVITY WITHOUT A NUMBER INDICATES OPEN TERMINAL POSITION											BACKSHELL WITH RIBS	BACKSHELL WITHOUT RIBS
		HOUSING KEY/COLOR	GROMMET CAP	PLR	MAT SEAL	1	2	3	4	5	6	7	8	9				
KEY A, BLACK	160081-3001	A-BLK	GCP	PLR	M										SALEABLE		TBD	TBD
KEY B, LIGHT GRAY	160081-3002	B-LG	GCP	PLR	M										SALEABLE		TBD	TBD
KEY C, DARK GRAY	160081-3003	C-DG	GCP	PLR	M										SALEABLE		TBD	TBD
KEY D, STONE GRAY	160081-3004	D-SG	GCP	PLR	M										SALEABLE		TBD	TBD
KEY A BLOCKED, BLACK	160081-3005	A-BLK	GCP	PLR	M									9	SALEABLE		TBD	TBD

<b>FUNCTIONAL SYMBOLS</b> FA = 0 FC = 0 FP = 0 <b>DIVISIONAL SYMBOLS</b>	THIS DRAWING CONTAINS INFORMATION THAT IS PROPRIETARY TO MOLEX ELECTRONIC TECHNOLOGIES, LLC AND SHOULD NOT BE USED WITHOUT WRITTEN PERMISSION		CURRENT REV DESC: Changed the document restriction to General Market.		 MX150 HYBRID BLADE DUAL ROW SEALED ASSY DUAL ROW SEALED ASSEMBLY MAT SEAL PRODUCT SALES DRAWING						
	DIMENSION UNITS: <b>mm</b> SCALE: <b>1:1</b>	GENERAL TOLERANCES (UNLESS SPECIFIED) ANGULAR TOL ± 0.5°		STATUS: Production DRWN: Mahesh KP CHK'D: Ryan Dunn APPR: Ryan Dunn							
	4 PLACES ± 3 PLACES ± 2 PLACES ± 1 PLACE ± 0 PLACES ±	DRAFT WHERE APPLICABLE MUST REMAIN WITHIN DIMENSIONS		THIRD ANGLE PROJECTION				DRAWING: <b>A1-SIZE</b>	SERIES: <b>160077</b>	DOCUMENT NUMBER: <b>1600770001</b>	DOC TYPE: PSD DOC PART: 000 REVISION: <b>A5</b>
	MATERIAL NUMBER:		CUSTOMER: <b>GENERAL MARKET</b>					SHEET NUMBER: <b>6 OF 7</b>			

