

ITEM #	MOLEX PART#	DESCRIPTION	QTY	UOM
A	2178841000	6mm SIDEWIZE ASSY 2 AWG RECEPTACLE BLK	1	PC
B	-	PART ID LABEL	1	PC
C	-	HST	A/R	M

FROM	TO	CABLE PART#	DESCRIPTION	COLOR
A	-	-	1X2AWG PVC UL1015 BLACK	BLACK

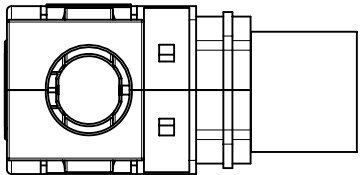

NOTE 4

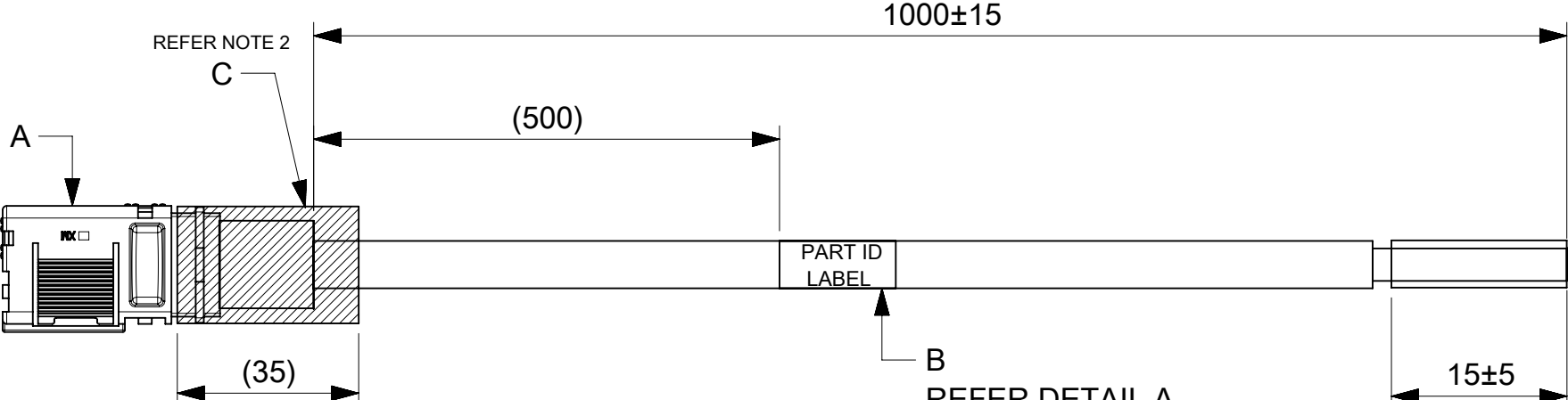

REFER NOTE 3

2243572116  
MOLEX  
BATCH WK/YR

- NOTE:
- CABLE ASSEMBLY TO BE ENSURED FOR CONTINUITY.
  - INSTALL HST ON THE BARREL AS SHOWN IN DRAWING.
  - ENSURE LATCH AND THE CRIMPING PROFILE ARE IN THE SAME PLANE
  - HST TO BE COVERED FROM THE WIRE INSULATION TO OVER THE RIB, TO ENSURE THERE IS NO EXPOSURE OF BARE MATERIAL

FUNCTIONAL SYMBOLS $\nabla_A = 0$ $\nabla_E = 0$ $\nabla_P = 0$	THIS DRAWING CONTAINS INFORMATION THAT IS PROPRIETARY TO MOLEX ELECTRONIC TECHNOLOGIES, LLC AND SHOULD NOT BE USED WITHOUT WRITTEN PERMISSION		CURRENT REV DESC:		 SW1 6.00MM R-S 1M 2AWG BK PRODUCT CUSTOMER DRAWING			
	DIMENSION UNITS	SCALE	EC NO: 761416					
	mm	NTS	DRWN: ROHITJ3 2023/08/21					
	GENERAL TOLERANCES (UNLESS SPECIFIED)		CHK'D: SKUMAR07 2023/09/07					
DIVISIONAL SYMBOLS $\nabla_A = 0$ $\nabla_E = 0$ $\nabla_P = 0$	ANGULAR TOL	±	°	APPR: SKUMAR07 2023/09/07	DOCUMENT NUMBER	DOC TYPE	DOC PART	REVISION
	4 PLACES	±		INITIAL REVISION:	2243572116	PSD	000	D
	3 PLACES	±		DRWN: MARUTG 2023/04/25				
	2 PLACES	±		APPR: SKUMAR07 2023/04/27				
DRAFT WHERE APPLICABLE MUST REMAIN WITHIN DIMENSIONS		THIRD ANGLE PROJECTION		DRAWING	SERIES	MATERIAL NUMBER	CUSTOMER	SHEET NUMBER
				A4-SIZE	224357	2243572116	GENERAL MARKET	1 OF 1

DOCUMENT STATUS	P1	RELEASE DATE	2023/09/07	06:24:53
-----------------	----	--------------	------------	----------