

SK15792

THIS DRAWING CONTAINS INFORMATION PROPRIETARY TO POSITRONIC IND. INC. ANY REPRODUCTION, DISCLOSURE OR USE OF THIS DRAWING IS EXPRESSLY PROHIBITED, EXCEPT AS POSITRONIC IND. INC. MAY OTHERWISE AGREE IN WRITING.

DATE	REV	REVISION RECORD	APP	DR	CK
1-14-14	NC	ECO 41964	TK	BS	COLE
10-30-15	A	ECO 48515	COLE	CV	COLE

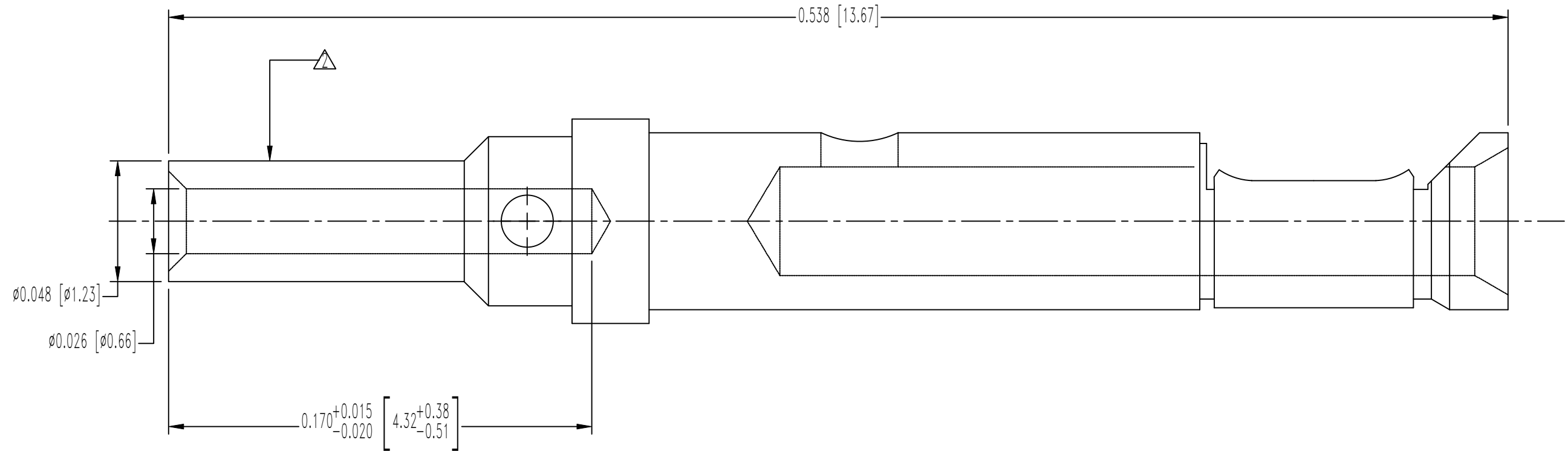

NOTES:

- MATERIALS:  
CONTACT: CONSTANTAN  
SPRING CLIP: BERYLLIUM COPPER, 0.000010 [0.25μ] GOLD OVER COPPER.
- CONTACT PERMANENTLY MARKED WITH YELLOW ID BAND.
- CONTACTS ARE ROHS COMPLIANT PER CURRENT DIRECTIVE.
- DIMENSIONS ARE IN INCHES [MILLIMETERS].

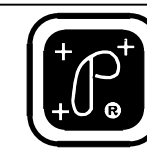

**POSITRONIC INDUSTRIES INC.**  
SPRINGFIELD, MISSOURI 65801

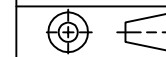

DECIMAL TOL.  
± 0.015 [0.38]

ANGULAR TOL.  
± 5°

DD SERIES	SCALE N.T.S.	DRAWN BY B SHELLEDY
TITLE FC6026D2CO/AA		APPROVED BY TK
DATE 1-14-14	DRAWING NUMBER SK15792	REV. A