

NO.	DESCRIPTION	PART NO.	QTY	MATERIAL	DRW NO.	REMARKS
1	INSULATOR		1	LCP		COLOR: IVORY UL94V-0
2	ACTUATOR		1	PA6T		COLOR: BLACK UL94V-0
3	CONTACT		N	PHOS-BRONZE		t=0.2
4	ANCHOR PLATE		2	PHOS-BRONZE		t=0.2

極数 NO. OF POS.	A	B	C	D	E
8	3.5	8.24	5.2	6.0	9.6
9	4.0	8.74	5.7	6.5	10.1
10	4.5	9.24	6.2	7.0	10.6
11	5.0	9.74	6.7	7.5	11.1
12	5.5	10.24	7.2	8.0	11.6
13	6.0	10.74	7.7	8.5	12.1
14	6.5	11.24	8.2	9.0	12.6
15	7.0	11.74	8.7	9.5	13.1
16	7.5	12.24	9.2	10.0	13.6
17	8.0	12.74	9.7	10.5	14.1
18	8.5	13.24	10.2	11.0	14.6
19	9.0	13.74	10.7	11.5	15.1
20	9.5	14.24	11.2	12.0	15.6
21	10.0	14.74	11.7	12.5	16.1
22	10.5	15.24	12.2	13.0	16.6
23	11.0	15.74	12.7	13.5	17.1
24	11.5	16.24	13.2	14.0	17.6
25	12.0	16.74	13.7	14.5	18.1
26	12.5	17.24	14.2	15.0	18.6
27	13.0	17.74	14.7	15.5	19.1
28	13.5	18.24	15.2	16.0	19.6
29	14.0	18.74	15.7	16.5	20.1
30	14.5	19.24	16.2	17.0	20.6

極数 NO. OF POS.	A	B	C	D	E
31	15.0	19.74	16.7	17.5	21.1
32	15.5	20.24	17.2	18.0	21.6
33	16.0	20.74	17.7	18.5	22.1
34	16.5	21.24	18.2	19.0	22.6
35	17.0	21.74	18.7	19.5	23.1
36	17.5	22.24	19.2	20.0	23.6
37	18.0	22.74	19.7	20.5	24.1
38	18.5	23.24	20.2	21.0	24.6
39	19.0	23.74	20.7	21.5	25.1
40	19.5	24.24	21.2	22.0	25.6
41	20.0	24.74	21.7	22.5	26.1
42	20.5	25.24	22.2	23.0	26.6
43	21.0	25.74	22.7	23.5	27.1
44	21.5	26.24	23.2	24.0	27.6
45	22.0	26.74	23.7	24.5	28.1
46	22.5	27.24	24.2	25.0	28.6
47	23.0	27.74	24.7	25.5	29.1
48	23.5	28.24	25.2	26.0	29.6
49	24.0	28.74	25.7	26.5	30.1
50	24.5	29.24	26.2	27.0	30.6
51	25.0	29.74	26.7	27.5	31.1
52	25.5	30.24	27.2	28.0	31.6
53	26.0	30.74	27.7	28.5	32.1
54	26.5	31.24	28.2	29.0	32.6
55	27.0	31.74	28.7	29.5	33.1
56	27.5	32.24	29.2	30.0	33.6
57	28.0	32.74	29.7	30.5	34.1
58	28.5	33.24	30.2	31.0	34.6
59	29.0	33.74	30.7	31.5	35.1
60	29.5	34.24	31.2	32.0	35.6
64	31.5	36.24	33.2	34.0	37.6
68	33.5	38.24	35.2	36.0	39.6
70	34.5	39.24	36.2	37.0	40.6
74	36.5	41.24	38.2	39.0	42.6
80	39.5	44.24	41.2	42.0	45.6

※この表は1, 2ページ目へのみ適用  
 ※THIS CHART IS APPLICABLE TO SHEET-1 AND SHEET-2 ONLY.

ROHS規制対応  
 COMPLIANT WITH  
 ROHS REGULATIONS

TOLERANCE / 一般公差(S)		PRODUCT SPEC / 製品規格		J	DCN18A05	2018/12/04				
X < 10	±0.2	UNIT: mm, ANGLE: 3RD		H	DCN18728	2018/08/20	R. MANABE	N. KITAGAWA	Y. FUJII	
10 ≤ X < 30	±0.25			O	EDN-094	2008/02/16	G. SAGARA			T. SATOH
30 ≤ X	±0.3			NO.	EDN/DCN	DATE	ISSUE	CHECKED	APPROVED	
ANGLE / 角度 ±3°		SCALE: 10:1	DATE: 2008/02/16	PART NAME / 品名: SERIES 6288 FPC ASSY RA SMT 0.5mm PITCH BOTTOM CONTACT						
DRAWN: G. SAGARA	DESIGNED: G. SAGARA	CHECKED: T. SATOH	APPROVED: T. SATOH	PART NO. / 型番: 04 6288 OXX 000 846 +						
DWG NO. / 図番: BJS 6288002				SHEET REV: 1/3		J				

NO.	DESCRIPTION	PART NO.	QTY	MATERIAL	DRW NO.	REMARKS
-----	-------------	----------	-----	----------	---------	---------

注記  
NOTE

1. コンタクトテール及び固定金具は基板より  
最大浮き0.1とする。  
CONTACT TAIL AND ANCHOR PLATE  
HEIGHT SHALL BE 0.1MAX.

※この注記は1, 2ページ目にのみ適用  
※THIS NOTES IS APPLICABLE TO  
SHEET-1 AND SHEET-2 ONLY.

② 適用FPC/FFC寸法は1か2を選択のこと。  
SELECT AN APPLICABLE  
FPC/FFC FROM 1 OR 2.

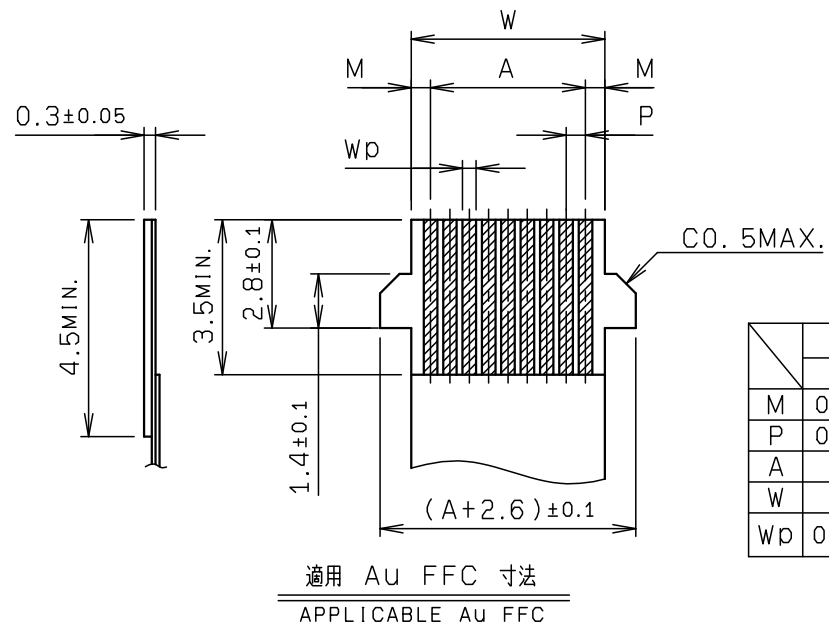
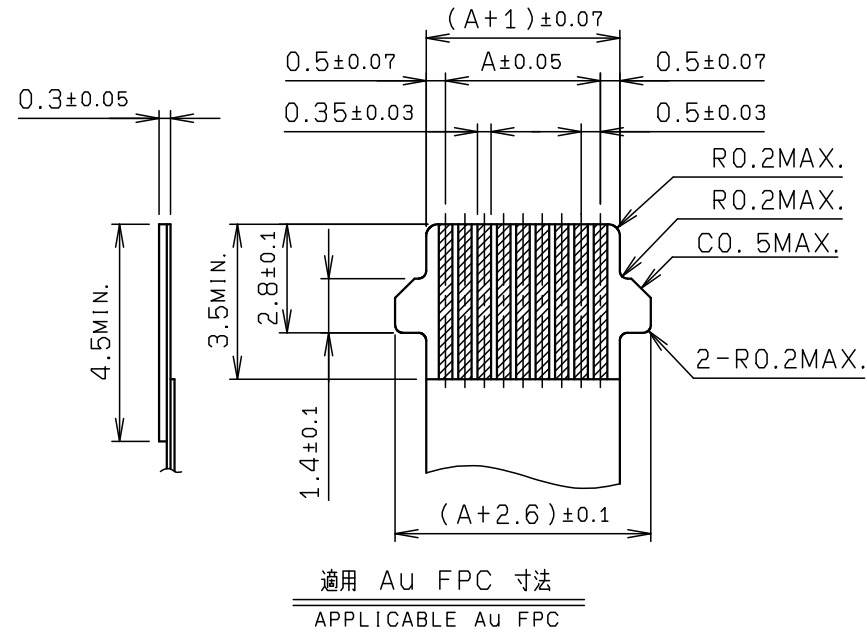

	FFC	
	1	2
M	0.5±0.08	0.5±0.07
P	0.5±0.05	0.5±0.03
A	A±0.05	A±0.05
W	W±0.07	W±0.07
Wp	0.32±0.03	0.30±0.03

FPC構成  
FPC STRUCTURE  
(推奨仕様)

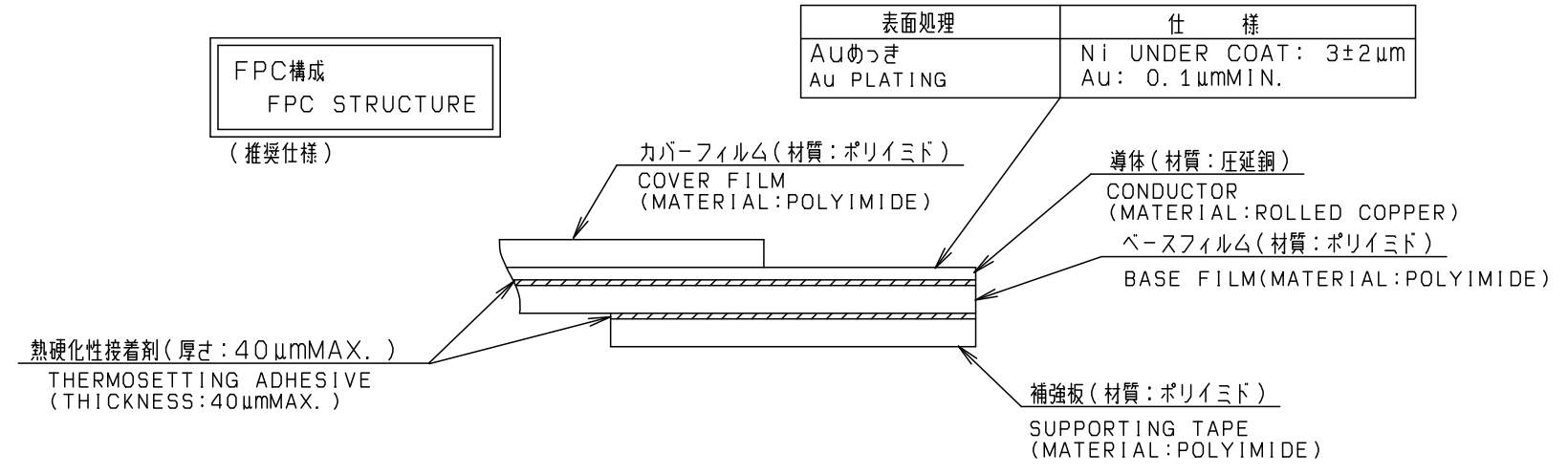

FFC構成  
FFC STRUCTURE  
(推奨仕様)

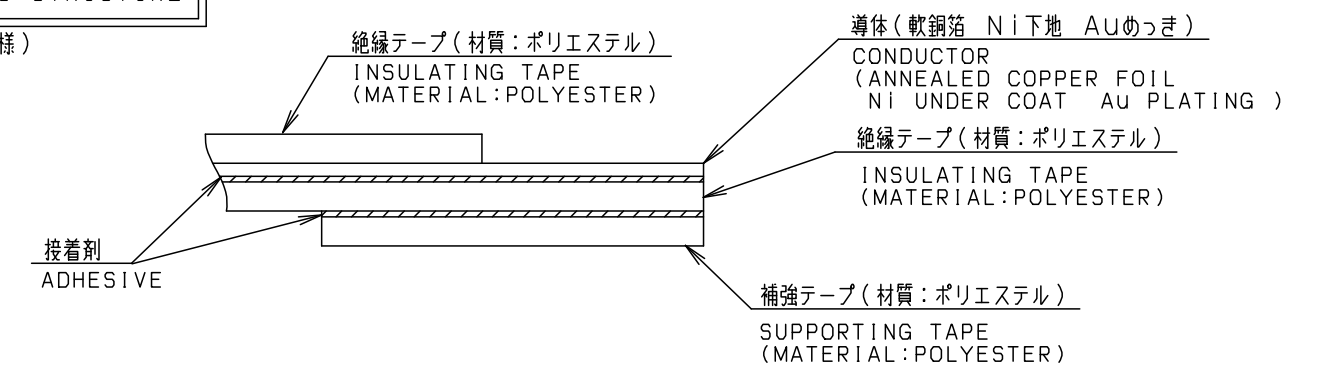

ROHS規制対応  
COMPLIANT WITH  
ROHS REGULATIONS

TOLERANCE / 一般公差(S)	PRODUCT SPEC / 製品規格	REFER TO SHEET 1/3									
X < 10 ±0.2	UNIT	mm	ANGLE	3RD	NO.	EDN/DCN	DATE	ISSUE	CHECKED	APPROVED	
10 ≤ X < 30 ±0.25	SCALE	NTS	DATE	2008/02/16	PART NAME / 品名						
30 ≤ X ±0.3	ANGLE / 角度	±3°	SERIES 6288 FPC ASSY RA SMT 0.5mm PITCH BOTTOM CONTACT								
DRAWN	DESIGNED	CHECKED	APPROVED	PART NO. / 型番							
G. SAGARA	G. SAGARA		T. SATOH	04 6288 OXX 000 846 +							
DWG NO. / 図番				SHEET / REV							
BJS 6288002				12/3				J			

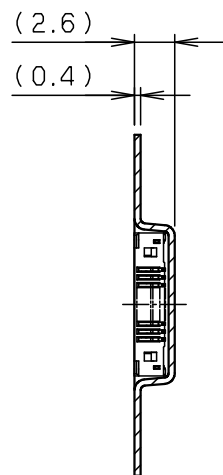
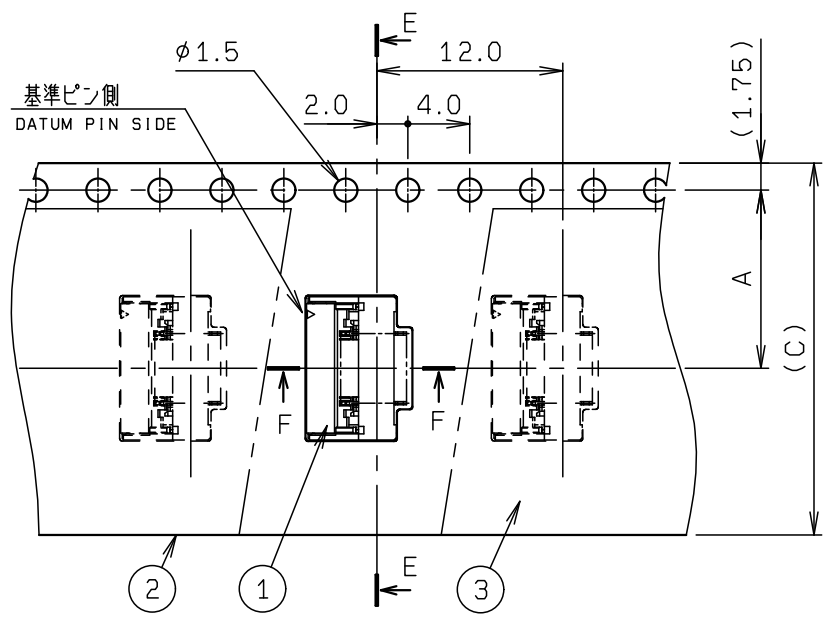

SECT. E-E  
(8~21P)

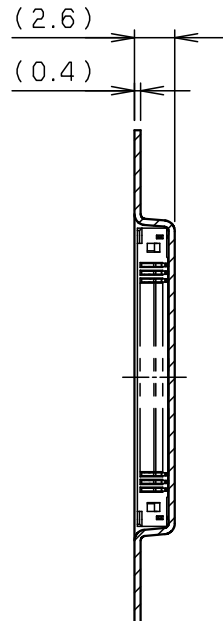
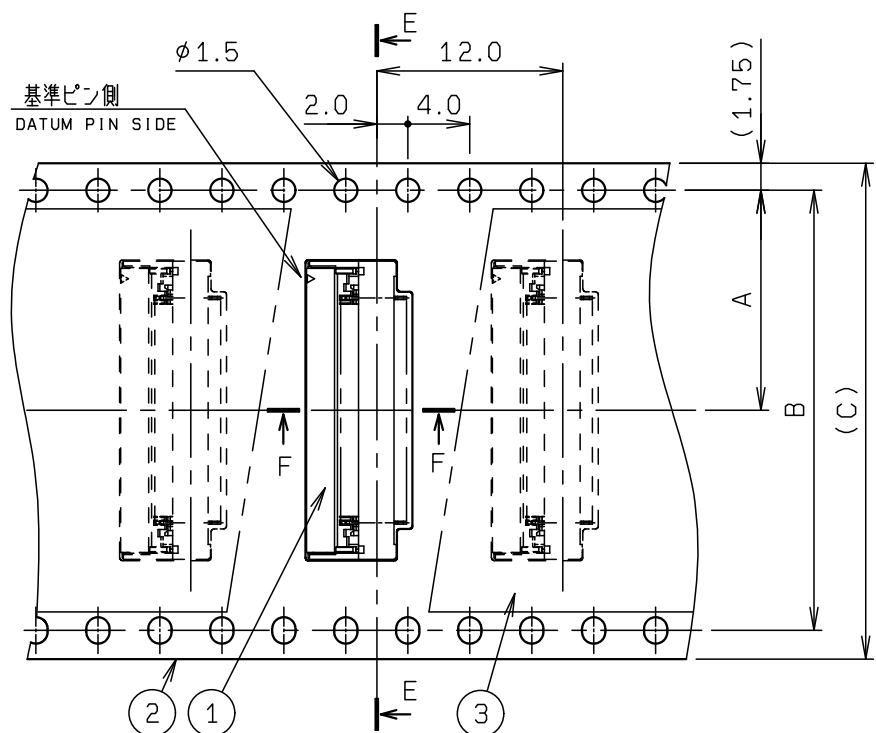

SECT. E-E  
(22~80P)

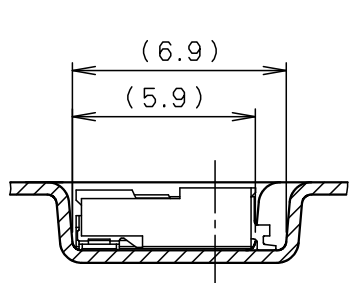

SECT. F-F (s=4:1)

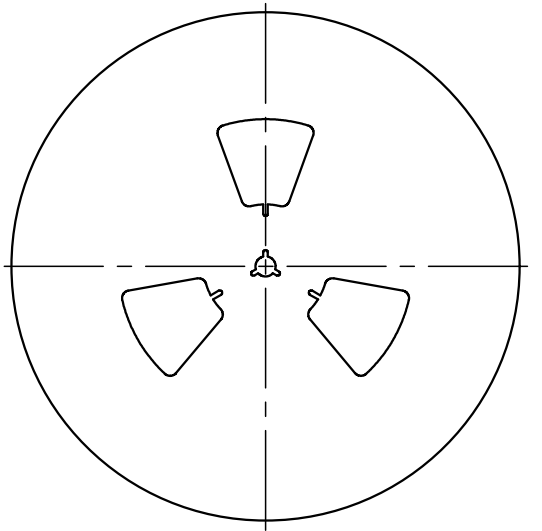

REEL DIMENSION

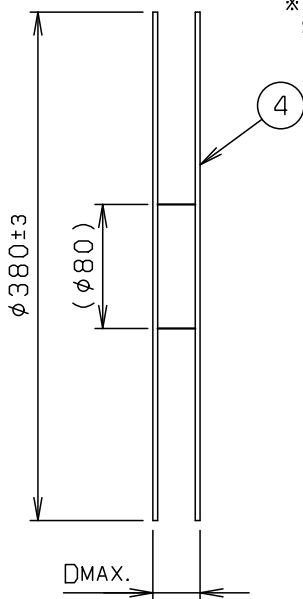

NO.	DESCRIPTION	PART NO.	QTY	MATERIAL	DRW NO.	REMARKS
1	CONNECTOR	00 6288 OXX 000 846 +	2000	---		00 6288 OXX 000 846 +
2	EMBOSSED TAPE		1	POLYSTYRENE		
3	TOP COVER TAPE		1	POLYSTYRENE		
4	REEL		1	POLYSTYRENE		

注記  
NOTE

- 梱包数量 : 2000 個/リール  
PACKING QUANTITY : 2000 ea/reel
- 納入時のリール巻き方向  
REELING DIRECTION  
IN DELIVERY

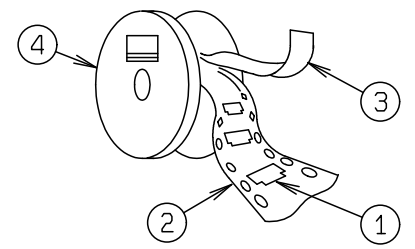

- 引出し方向  
USER DIRECTION OF FEED

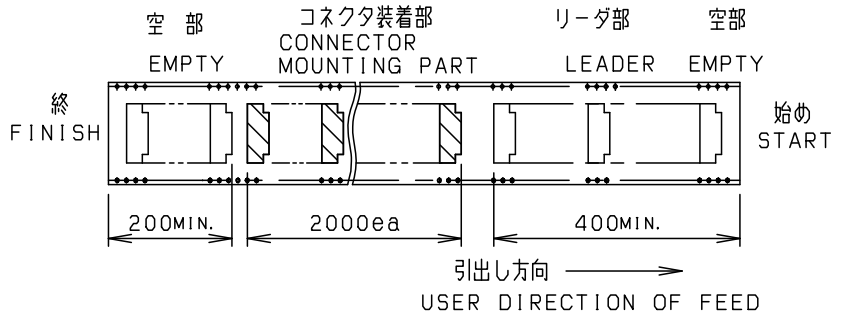

- 型番  
P/N 04 6288 OXX 000 846 +  
種数  
NO. OF POS. \_\_\_\_\_  
めっきコード  
PLATING CODE \_\_\_\_\_  
846 + : AU

※この注記の1~3は3ページ目にも適用  
※THIS NOTES 1 TO 3 ARE APPLICABLE TO SHEET-3 ONLY.

種数 NO. OF POS.	A	B	C	D
8	7.5	---	16.0	22.4
9	7.5	---	16.0	22.4
10	11.5	---	24.0	30.4
11	11.5	---	24.0	30.4
12	11.5	---	24.0	30.4
13	11.5	---	24.0	30.4
14	11.5	---	24.0	30.4
15	11.5	---	24.0	30.4
16	11.5	---	24.0	30.4
17	11.5	---	24.0	30.4
18	11.5	---	24.0	30.4
19	11.5	---	24.0	30.4
20	11.5	---	24.0	30.4
21	11.5	---	24.0	30.4

種数 NO. OF POS.	A	B	C	D
22	14.2	28.4	32.0	38.4
23	14.2	28.4	32.0	38.4
24	14.2	28.4	32.0	38.4
25	14.2	28.4	32.0	38.4
26	14.2	28.4	32.0	38.4
27	14.2	28.4	32.0	38.4
28	14.2	28.4	32.0	38.4
29	14.2	28.4	32.0	38.4
30	14.2	28.4	32.0	38.4
31	14.2	28.4	32.0	38.4
32	14.2	28.4	32.0	38.4
33	14.2	28.4	32.0	38.4
34	20.2	40.4	44.0	50.4
35	20.2	40.4	44.0	50.4
36	20.2	40.4	44.0	50.4
37	20.2	40.4	44.0	50.4
38	20.2	40.4	44.0	50.4
39	20.2	40.4	44.0	50.4
40	20.2	40.4	44.0	50.4
41	20.2	40.4	44.0	50.4
42	20.2	40.4	44.0	50.4
43	20.2	40.4	44.0	50.4
44	20.2	40.4	44.0	50.4
45	20.2	40.4	44.0	50.4
46	20.2	40.4	44.0	50.4
47	20.2	40.4	44.0	50.4
48	20.2	40.4	44.0	50.4
49	20.2	40.4	44.0	50.4
50	26.2	52.4	56.0	62.4
51	26.2	52.4	56.0	62.4
52	26.2	52.4	56.0	62.4
53	26.2	52.4	56.0	62.4
54	26.2	52.4	56.0	62.4
55	26.2	52.4	56.0	62.4
56	26.2	52.4	56.0	62.4
57	26.2	52.4	56.0	62.4
58	26.2	52.4	56.0	62.4
59	26.2	52.4	56.0	62.4
60	26.2	52.4	56.0	62.4
64	26.2	52.4	56.0	62.4
68	26.2	52.4	56.0	62.4
70	26.2	52.4	56.0	62.4
74	26.2	52.4	56.0	62.4
80	26.2	52.4	56.0	62.4

※この表は3ページ目にも適用  
※THIS CHART IS APPLICABLE TO SHEET-3 ONLY.

ROHS規制対応  
COMPLIANT WITH  
ROHS REGULATIONS

TOLERANCE / 一般公差(S)		PRODUCT SPEC / 製品規格			
X < 10 ±0.2		POLYSTYRENE (CLEAR)			
10 ≤ X < 30 ±0.25		UNIT	ANGLE	REFER TO SHEET 1/3	
30 ≤ X ±0.3		mm	3RD	NO.	EDN/DCN
ANGLE / 角度 ±3°		SCALE	DATE	DATE	ISSUE
		2 : 1	2008/02/16	CHECKED	APPROVED
DRAWN	DESIGNED	CHECKED	APPROVED	PART NAME / 品名	
G. SAGARA	G. SAGARA		T. SATOH	EMBOSS TAPE ASSY FPC ASSY RA SMT 0.5mm PITCH	
				PART NO. / 型番	
				04 6288 OXX 000 846 +	
				DWG NO. / 図番	
				BJS 6288002	
				SHEET / REV	
				13 / 3 J	

