

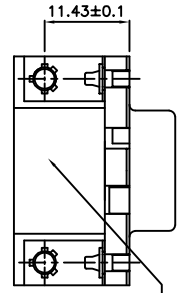

FCIconnect.com

Copyright FCI



Part No&date Code printing

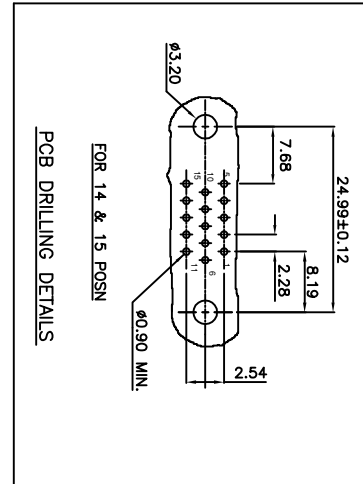
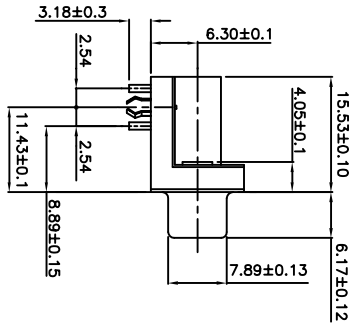
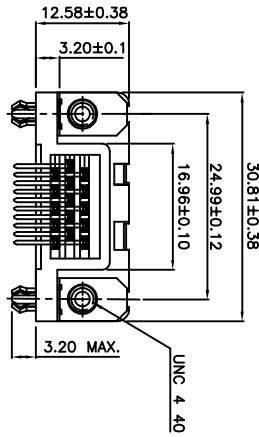

PCB DRILLING DETAILS

TECHNICAL SPECIFICATIONS

MATERIAL : STEEL, TIN/ZINC O3 PLATED. SHELL : SELF EXTINGUISHING BLACK POLYESTER UL CLASS 94V0 INSULATORS : THE HOUSING WILL WITHSTAND EXPOSURE TO 260-285°C IF WE USE PROTECTIVE ADHESIVE (Type Kapton or Teflon) OR PROTECTIVE METALLIC DEVICE CONTACTS : COPPER ALLOY PLATING : GOLD OVER NICKEL ACTIVE ZONE : TIN LEAD OVER NICKEL TERMINATION ZONE : 24MM MATE TIN TOP OVER FOR LEAD FREE PLATING METAL BRACKET : 1.27U MIN NICKEL UNDER PLATE (ON TERMINATION ZONE) HARROON : BRASS, TIN/ZINC O3 PLATED. CLINCH NUT : BRASS, TIN/ZINC O3 PLATED. SCREW LOCK : BRASS, TIN/ZINC O3 PLATED. ELECTRICAL DATA : 3A MAX CURRENT RATING TEST VOLTAGE : 1000V RATED VOLTAGE : 300V CONTACT RESISTANCE : ≤ 25mΩ SHELL RESISTANCE : ≤ 5mΩ INSULATION RESISTANCE : > 5000MΩ ENVIRONMENTAL CHARACTERISTICS : OPERATING TEMPERATURE RANGE : -55°C - +125°C MECHANICAL CHARACTERISTICS : MATING/UNMATING CYCLES (MIN) : 200 (FLASH Au); 500 (0.76u Au) INSERTION/EXTRACTION FORCE PER CONTACT : 5 N MAX; 0.3 N MIN.

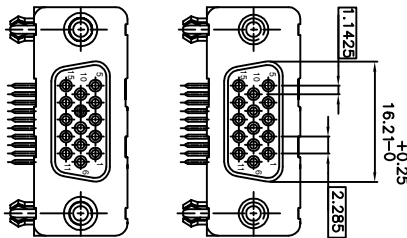

FOR 14 POSN, HOLE NO 9 IS BLOCKED.

ORDERING INFORMATION

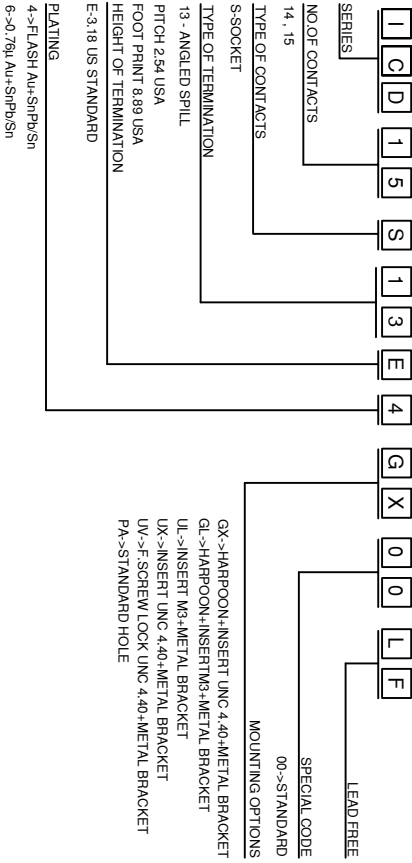

"This product meets European Union Directives and other country regulations as described in GS-22-008". The housing will withstand exposure to 260°C peak temperature for 3.5 seconds in a wave solder application with a 1.6mm minimum thick circuit board. Packaging as per GS-14-920

Table with columns: mat'l. code, SEE NOTE 4, surface tolerance, ISO 1302, ISO 406 ISO 1101, projection, product family, title, and sheet no. Includes revision history and drawing information.