

SMX-200X-XX

41-pin, Unterminated Cable Assembly – **Part No: 70-0363-506R**
 (pigtail), 3 ft. The mating cable assembly (length = 3ft, teflon cable, 16GA)
 with one end unterminated for SMX-200X-XX cards.

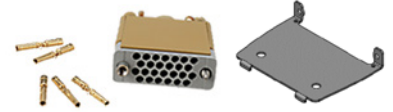

Connector Kit – **Part No: 70-0190-001R**
 (includes 1 connector housing, 44 crimp pins, 1 strain relief bracket etc).
 For making a customized length cable, customer needs to buy the kit
 along with the tools, (cables not included).



SMX-200X-XX Crimp, Insert and Extraction Tools

Crimp Tool and Turret Head – **Part No: 46-0012-000**
 Mfg. part no: 9501 and 9502-1 – Manufacturer: Positronics



Insertion Tool – **Part No: 46-0014-000**
 Mfg. part no: 9099 – Manufacturer: Positronics



Extraction Tool – **Part No: 46-0015-000**
 Mfg. part no: 9081 – Manufacturer: Positronics



SMX-200X-XX Additional Parts

Contact/Female/Crimp Pwr/14-16 GA – **Part No: 27-0087-000**
 Mfg. part no: FC114N2/AA – Manufacturer: Amphenol Positronic



Strain Relief Bracket Kit – **Part No: 41-0513-000R**
 For 41-pin series m conn



SMX-300X

Part No: 70-0367-207R
 (F/A, SMX-300X-TB160-3, 160-160P #3) (Break Out Box)
 160-pin BOB_SMX-300X



SMX-32XX

Part No: 70-0367-206R
 (F/A, SMX-327X TB160-1, 160-160P #1) (Break Out Box)
 160-pin BOB_SMX-327X



SMX-44XX

Part No: 70-0367-208R
 (F/A, SMX 44XX-TB160-4, 160-160P #4) (Break Out Box)
 160-pin BOB_SMX-44XX



SMX-500X

Part No: 70-0367-205R
 (F/A, SMX, TB160SE, 160-160P) (Break Out Box)
 160-pin BOB_SMX-500X



160-PIN CONNECTOR (Unterminated)

160-pin, Unterminated Cable Assembly - **Part No: 70-0363-550R**
(pigtail), 3 ft.

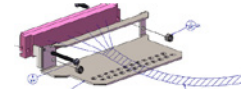

Crimp tool - **Part No: 46-0010-000**
Mfg. part no: 014374 - Manufacturer: Ernie



Extraction Tool - **Part No: 46-0011-000**
Mfg. part no: 471555 - Manufacturer: Ernie



STRAIN RELIEF BRACKET KIT (Without Connector)

KIT, Strain Relief - **Part No: 70-0409-160R**
for 160-pin DIN Connector

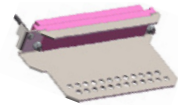

CRIMP PIN

Crimp Pins - **Part No: 52-0109-000R** for 160-pin DIN Connector (pack of 100)
Crimp Pins - **Part No: 52-0109-001R** for 160-pin DIN connector (Reel of 500 Pins)



MATING CONNECTOR

Connector Housing - **Part No: 27-0088-160**
160-pin female, Euro-DIN



SMX-61XX-PkZ

1. Customer has to select either one of the below mentioned PkZ Housing.
2. Based on the selected housing, customer has to select the relevant cables mentioned below.
3. Select the number of cables as per the channel required.

PkZ Housing - Part No: 27-0970-000

PkZ Connector Housing for cables $\varnothing.040$ - $\varnothing.054$
Housing, 53 position, PkZ plug, w/ 2 strain relief, for cables $\varnothing.040$ - $\varnothing.054$
Manufacturer/Part Number : PHOENIX / PRC532DX1XANONE



PkZ Housing - Part No: 27-0970-001

PkZ Connector Housing for cables $\varnothing.061$ - $\varnothing.102$
Housing, 53 position, PkZ plug, w/ 2 strain relief, for cables $\varnothing.061$ - $\varnothing.102$
Manufacturer/Part Number : PHOENIX PRC532DX2XANONE



PkZ to SMB, 1.37mm Cables - Part No: 56-0900-002

PkZ to SMB, 1.37mm Cable Assembly (24" Long)
Cable Assy, PkZ plug to SMB plug, 1.37mm cable, 24 Inch
Manufacturer/Part Number PHOENIX 15609DY0003-240

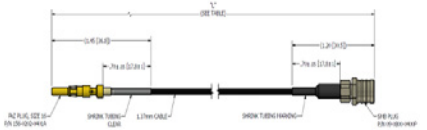

PkZ to SMB, RG178 Cables - Part No: 56-0901-002

PkZ to SMB, RG178 Cable Assembly (24" Long)
Cable Assy, PkZ plug to SMB plug, RG178 cable, 24 Inch
Manufacturer/Part Number PHOENIX 15609230092-240

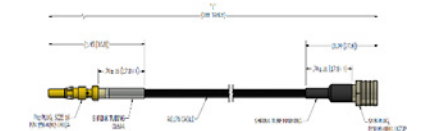

PkZ to SMA, 1.37mm Cables - Part No: 56-0902-002

PkZ to SMA, 1.37mm Cable Assembly (24" Long)
Cable Assy, PkZ plug to SMA plug, 1.37mm cable, 24 Inch
Manufacturer/Part Number PHOENIX 15620DY0004-240

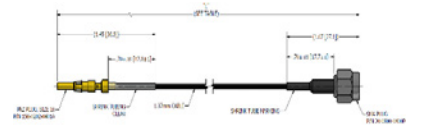

PkZ to SMA, RG178 Cables - Part No: 56-0903-002

PkZ to SMA, RG178 Cable Assembly (24" Long)
Cable Assy, PkZ plug to SMA plug, RG178 cable, 24 Inch
Manufacturer/Part Number PHOENIX 15620230076-240

