

Wolf

WOLFLITE XT RECHARGEABLE HANDLAMP

ATEX and IECEx Certified for
Explosive Atmospheres

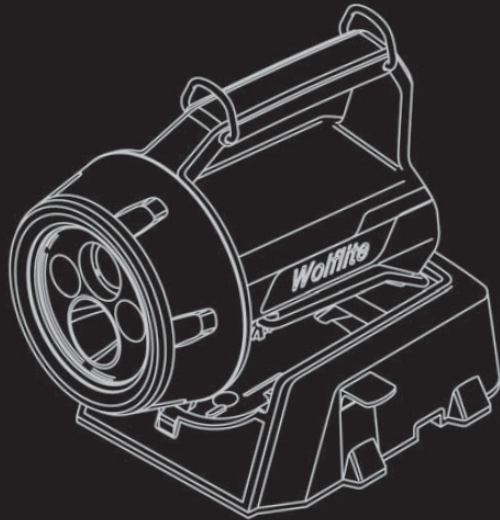

OPERATION AND
MAINTENANCE INSTRUCTIONS



Wolfite XT Rechargeable Handlamp Range Operation and Maintenance Instructions Please retain – read before use

EC Declaration of Conformity

The Wolfite XT Handlamp meets all relevant provisions of the 94/9/EC Explosive Atmospheres (ATEX Equipment) Directive by virtue of the issued EC type examination certificate, demonstrating compliance with all relevant harmonised standards and essential health and safety requirements.

The Wolfite XT Handlamp is a self-contained safety lamp using high power LED light sources, powered by a rechargeable Li-Ion battery pack, moulded in high impact strength plastic and approved as Group II, Category 1 equipment for use in zone 0, 1 & 2 or Category 2 equipment for use in zone 1 & 2 potentially explosive gases, vapours and mists where the T4 temperature class permits.

Approval Code:  II 1 G Ex ia IIC T4 Ga IP66 (XT-75)
II 2 G Ex ib IIC T4 Gb IP66 (XT-50, XT-70 & XT-90)
(Temperature ambient -20°C to +40°C)

Notified Body: Baseefa Ltd.
Rockhead Business Park,
Staden Lane, Buxton,
SK17 9JN, UK.
Notified body number: **1180**

EC Type examination certificate: **Baseefa09ATEX0326**

Harmonised standards applied:
EN60079-0:2006, EN60079-11:2007, EN60079-26:2007

Ingress protection level: **IP66** to EN60529:1992,

The Wolfite XT is certified compliant with the 2004/108/EC EMC Directive.

The product is CE marked showing compliance with all relevant EC Directives

Alex Jackson - Technical Director
Wolf Safety Lamp Company Ltd.

Use of the Wolfite XT Handlamp Range

Users should consult EN/IEC 60079 for advice on the selection and maintenance of electrical apparatus for use in potentially explosive atmospheres.

A damaged Wolfite XT Handlamp should be repaired in accordance with these instructions, before being put back into service.

Do not open a Wolfite XT Handlamp in the hazardous area. (fig 2)
Do not charge in the hazardous area.

Note: Ensure Lens Ring is tightened and that lens and approval plates are present and undamaged prior to use.

Before use, charge the Wolfite XT Handlamp for 4 hours minimum. Note: maximum battery capacity will be achieved after 3-5 full cycles.

Operation.

Wolfite XT handlamps are operated with a 'press and release' of the sliding switch with the switch depressed for < 1 sec. For some modes, or to switch the lamp off at any time, a long press > 2 sec is required.

XT-50 [Duration: 3.0 hrs full / 6.0 hrs half] – [Recharge Time: 3:00]

The XT-50 has dual power light output. Press switch once for Full Power and a second time for Half Power. Press switch again to switch the lamp off.

XT-70 / XT-75 [Duration: 6.0 hrs full / 12.0 hrs half] – [Recharge Time: 3:30]

The XT-70 / XT-75 have both Spot Beam and Flood (Wide) Beam Modes and dual power light output. Press sprung switch once for Full Power Spot and a second press for Half Power Spot, a third press for Full Power Flood, followed by a fourth press for Half Power Flood. Press switch again to switch the lamp off.

If the lamps remain in any one of the spot or flood modes for > 10s, any subsequent press, will switch the lamp off.

XT-90 [Duration: 9.0 hrs full / 18.0 hrs half] – [Recharge Time: 4:00]

The XT-90 operates as per the XT-70 above. Signal modes can be entered by pressing and holding the switch for 2 sec. followed by a quick press of the switch to change between signal modes. To exit, press and hold switch for 2 sec.

Deep discharge protection: circuitry will automatically switch the Handlamp off once the battery reaches a pre-determined low voltage.

Handlamp Indication on discharge

3 LEDS	~ high, 1st third of battery capacity
2 LEDS	~ medium, 2nd third of battery capacity
1 LED	~ low, the final third of battery capacity
0 LEDS (with beam flash warning)	~ very low, battery about to cut-off

Emergency lighting mode: The emergency lighting function switches the lamp on when a power failure to the charger occurs.

To activate this function on a lamp, press and hold the switch for 5 sec while lamp is on charge. (3 flashes of the spot beam will confirm emergency light mode ON) to deactivate, repeat, (2 flashes of the spot beam will confirm emergency light mode OFF). The lamp will remain in the mode it was set to.

Handlamp Head Assembly Replacement: (See Fig 6)

The Handlamp head assembly contains no user serviceable items.

If Handlamp fails to light or;

If no indication on the lamp is shown on charge:

- Ensure handlamp will charge – check power indicator on charger, check the handlamp is fully engaged in the charger and check that the charge contacts on the charger and on the base of handlamp are clean.
- If the charge indication works but the handlamp does not light, check that all switch parts are present and that the switch can depress fully. (The switch assembly contains a cylindrical magnet)
- Contact Wolf Safety for further information

Cleaning: Use a mild soap and water and soft brush only. Do not immerse.

The **XT-202, XT-204 and XT-206 Batteries** utilise a Lithium Ion system with a life of up to 500 full charge/discharge cycles (to 70% original capacity), and incorporate an integral encapsulated battery protection circuit.

Replace the Battery when the discharge duration is significantly shorter than the durations required. Recharge every six months when in storage.
Battery information: (Fig. 5). Removal and re-fitting: (Fig. 6)

Wolfite XT: Charger

There are two methods of releasing a lamp from a charger, see fig 9.

When placing a lamp in the charger, **Press Firmly** to ensure fully engaged until "CLICK". A red LED indicator shows power to the charger. Charging is fully managed to eliminate battery memory. A managed charge monitoring system only applies charge when the battery requires it (typically 5 minutes of top-up charge once every 7 days).

Charger Connection Options: (Fig. 11)

Handlamp Indication on charge

1 LED	~ 0-10%	initial charge
2 LEDS	~ 10-85%	bulk charge
3 LEDS	~ 85-100%	trickle charge
3 LEDS Flashing	~ fully charged,	no charge to battery
LED 3-2-1 sequence	~ Battery Temp. >40°C,	Charge temporarily suspended.
0 LEDS	~no contact between handlamp and charger	(check charge contacts and charger fuse (fig 10))

The **Wolfite XT Handlamp and XT-200 Charger Set** is 'CE' marked in compliance with the 2004/108/EC EMC Directive, and comply with the requirements of 2006/28/EC Automotive EMC Directive for use in emergency vehicles.

- Do not charge in Hazardous Area.
- Charger contacts are low voltage output and short circuit protected.
- Charger operating ambient: +10°C to +25°C.
- Charger ingress protection IP20, protect from dirt and moisture.
- Do not cover ventilation slots.

Warning RC-452: risk of short circuit if polarity incorrect. (See Fig. 11)

Peak current (during charge period) = 1.5A
Peak current (standby – fully charged) = 0.03A max
Peak current (no lamp in charger) = 0.02A max
Output Voltage does not exceed 14V: (U_o=14V)

The **RC-300 Mains Adaptor** is 'CE' marked in compliance with the 2004/108/EC EMC Directive and 2006/95/EC Low Voltage Directive. (Fig. 11)

WARNING:

USE ONLY SPECIFIED WOLF CHARGERS WITH THESE PRODUCTS (AS SHOWN IN FIG. 11) USE ONLY GENUINE WOLF REPLACEMENT PARTS.

The Wolf Safety Lamp Co. Ltd has a policy of continuous product improvement. Changes in design details may be made without prior notice.

Fig. 1



IECEx Scheme Certification

Ex Ia IIC T4 Ga IP66

XT-75 Zone 0 Handlamp (Spot & Flood)

Ex Ib IIC T4 Gb IP66

XT-60 Zone 1 Handlamp (Spot)

XT-70 Zone 1 Handlamp (Spot & Flood)

XT-90 Zone 1 Handlamp (Spot, Flood & Signal)

Cert No. IECs BAS 09.0153

IEC Standards Applied:

IEC 60079-0:2004

IEC 60079-11:2006

IEC 60079-26:2006

Ingress Protection Level:

IP66 to IEC60529:2001

Fig. 2

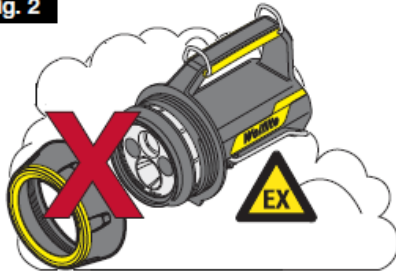

Fig. 3

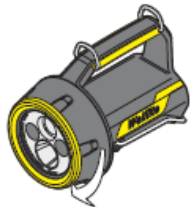
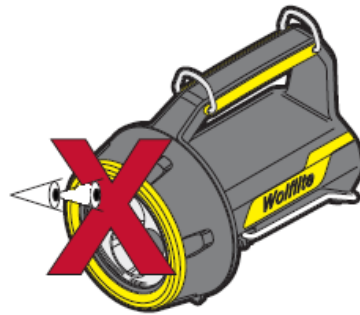
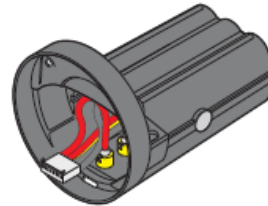

Fig. 4



Class 1 LED Product

Fig. 5



Li Ion



-Un Transportation

Regulations

-ADR

-US CFR 49



-IATA

-ICAO

-IMDG



XT-204 Only



Fig. 6

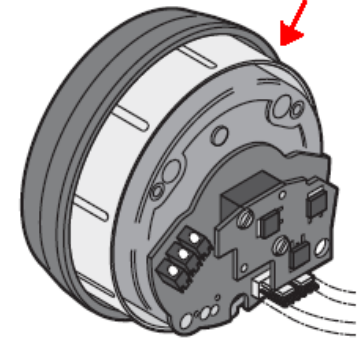
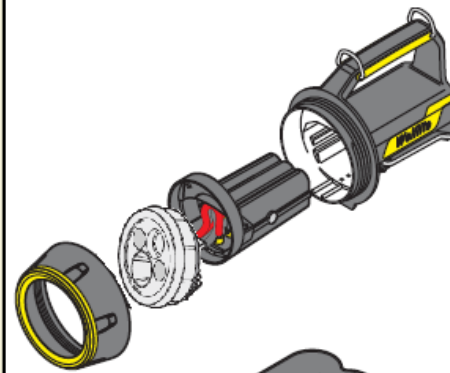

2.5mm
Allen Key

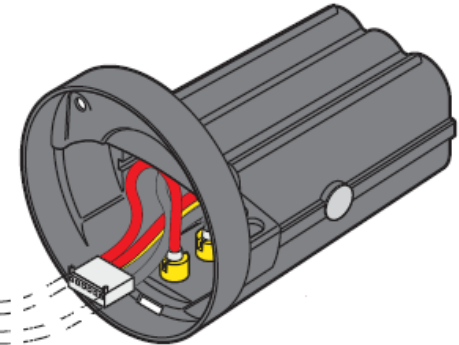
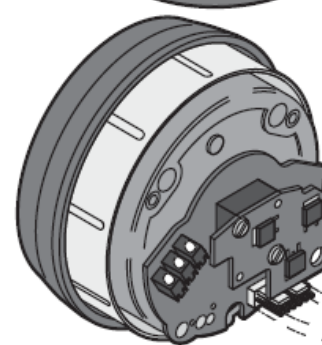
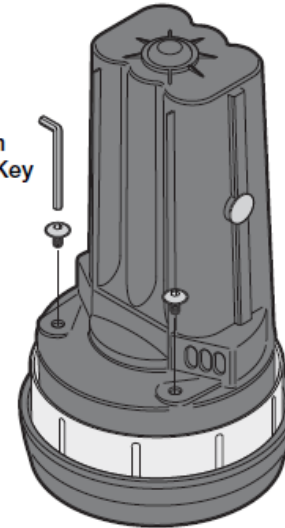

XT-50

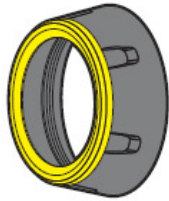

XT-312



XT-484



XT-348



XT-210

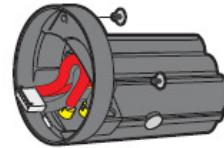

XT-202



XT-232
(Switch kit)

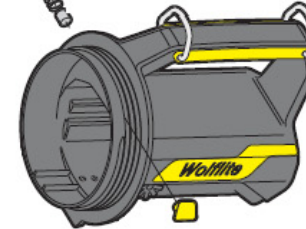

XT-235

**Parts List:
Description:**

Description:	Pt. No:
Lens Ring	XT-312
Replacement Glass Lens	XT-484
Polycarbonate Lens	XT-494
Lens Seal	XT-348
Replacement Switch Kit	XT-232
Lamp Stand	XT-410
Lanyard for XT-50/XT-70/XT-90	H-35SB

XT-70

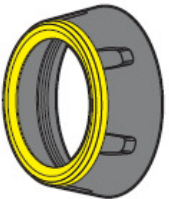

XT-312



XT-484



XT-348



XT-220

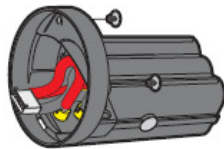

XT-204



XT-232
(Switch kit)

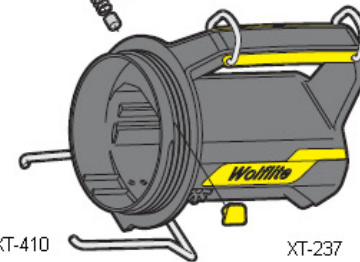

XT-237

XT-50

Head Assembly for XT-50	XT-210
Battery pack for XT-50	XT-202
XT-50 Body Assembly	XT-235

XT-70

Head Assembly for XT-70/75	XT-220
Battery pack for XT-70/75	XT-204
XT-70 Body Assembly	XT-237

XT-90

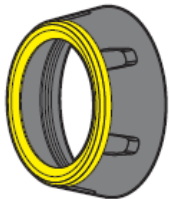

XT-312



XT-484



XT-348



XT-220

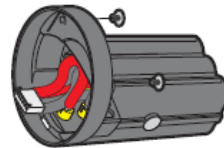

XT-206



XT-232
(Switch kit)

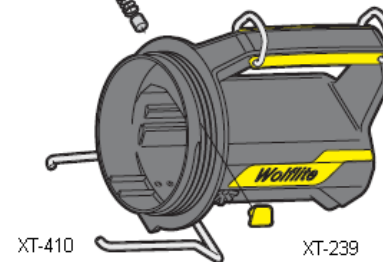

XT-239

XT-90

Head Assembly for XT-90	XT-210
Battery Pack for XT-90	XT-206
XT-90 Body Assembly	XT-239

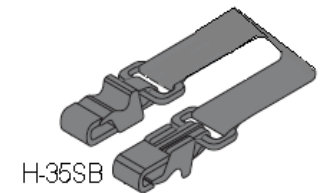

H-35SB

XT-75

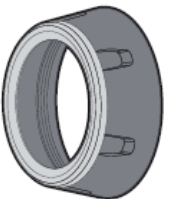

XT-313

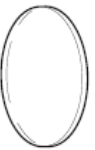

XT-484



XT-348



XT-220

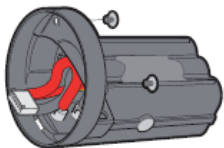

XT-204



XT-232
(Switch kit)

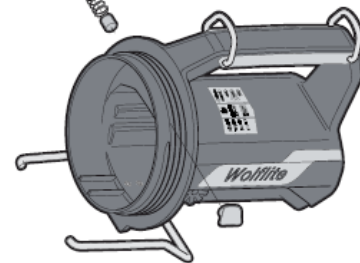

XT-328

XT-75

XT-75 Body Assembly	XT-238
XT-75 Switch Kit	XT-233
Conductive Lanyard for XT-75	XT-427

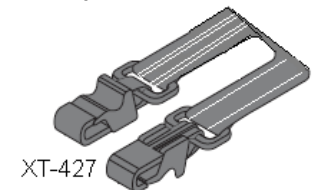

XT-427

Fig. 9

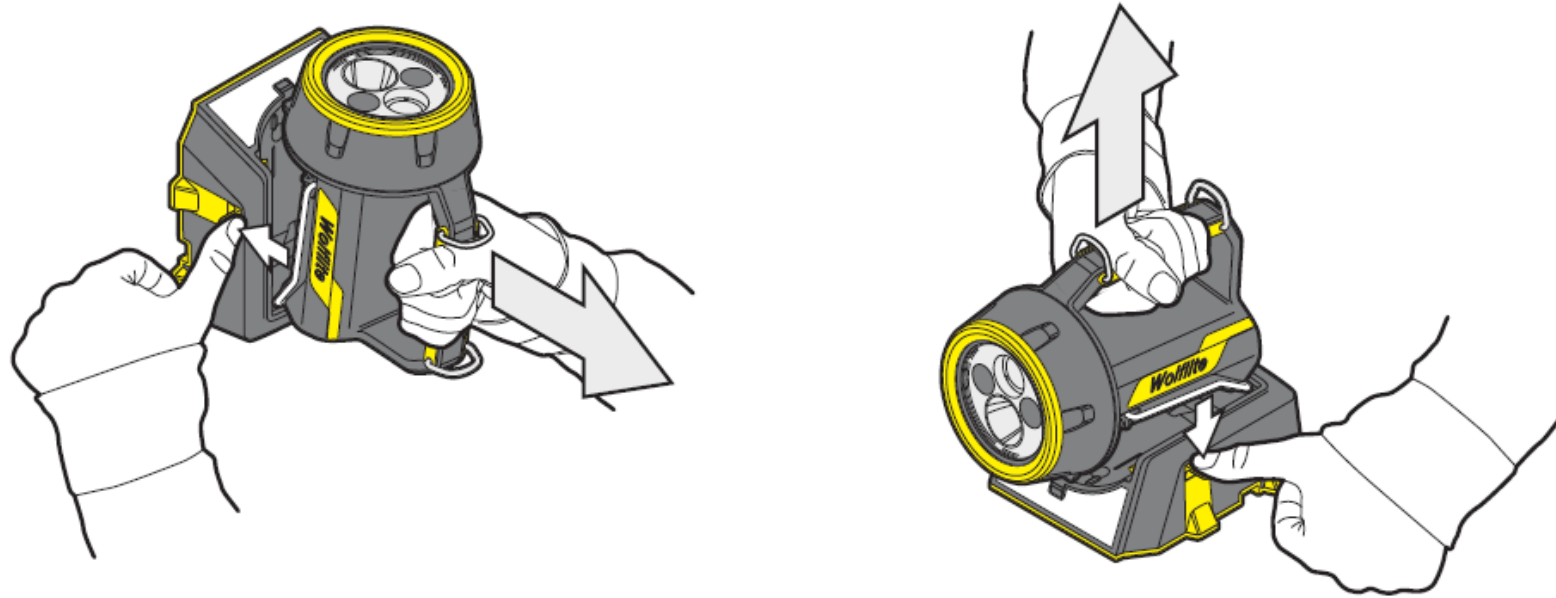
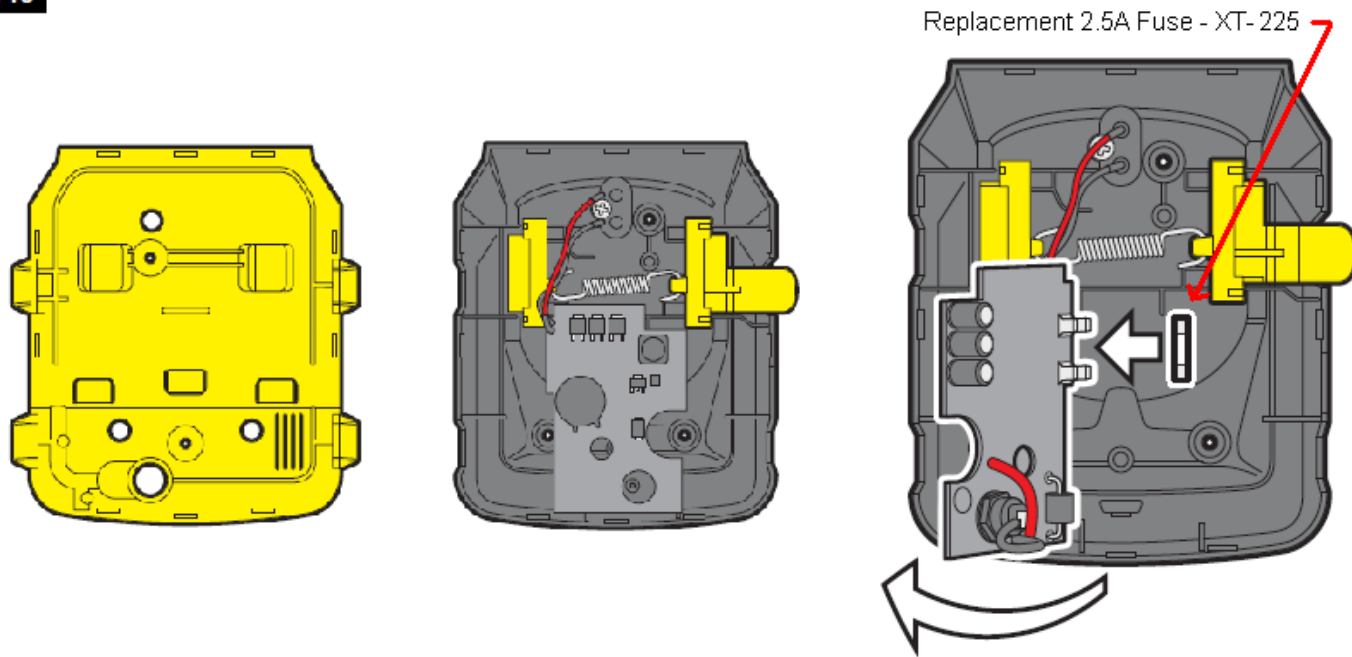

Fig. 10



Replacement 2.5A Fuse - XT-225

Parts List:

Description:

Pt. No:

- Charger Body Assembly
- Latch Mechanism
- Charger Circuit Assembly
- Spare Charger Fuse 2.5A
- Screw Kit

- XT-281
- XT-282
- XT-452
- XT-225
- XT-283

Fig. 11



XT-200L

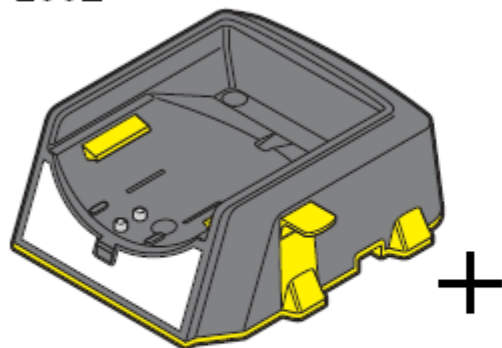

+

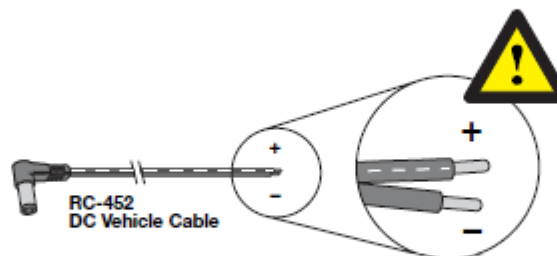

12/24V DC



XT-200H

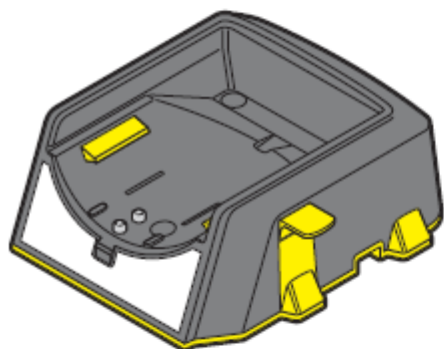

+

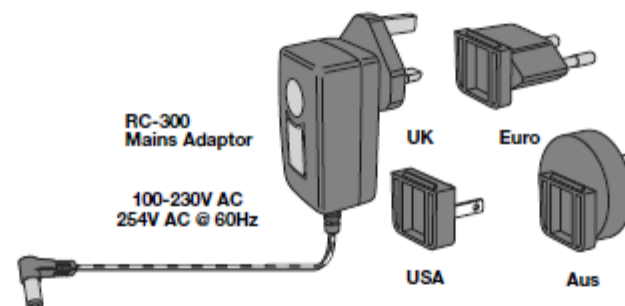

XT-200K

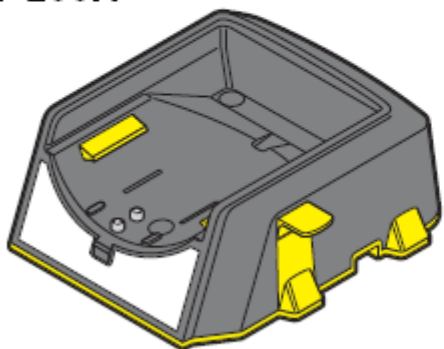

+

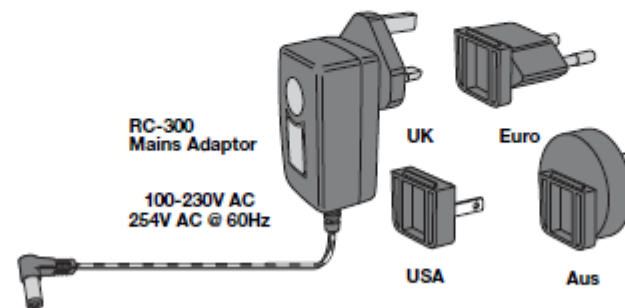

+



12/24V DC

